



OKLAHOMA DEPARTMENT OF TRANSPORTATION  
SURVEY DIVISION

**FLOOD INFORMATION FORM**

<b>Division #:</b>	1 <input type="checkbox"/> 2 <input type="checkbox"/> 3 <input type="checkbox"/> 4 <input type="checkbox"/> 5 <input type="checkbox"/> 6 <input type="checkbox"/> 7 <input checked="" type="checkbox"/> 8 <input type="checkbox"/>
<b>County:</b>	Cotton
<b>Date Highwater occurred:</b>	4/30/2019
<b>Highway Number:</b>	S.H. 5B
<b>Name of Stream:</b>	Unknown Creek
<b>Direction and distance from nearest town, or highway junction</b>	Approx. 1.0 miles North of U.S. 70 and S.H. 5B.
<b>Section, Township, Range:</b>	Section 27 T 4 S , R 11 W
<b>Description of Location:</b>	Pasture and heavy timber. Water crossed over SH5B South of the West Cache Creek Bridge.
<b>Latitude</b>	34°11'13" N
<b>Longitude</b>	98°19'51" W
<b>Highwater Elevation:</b>	928.8' or Approximately 1' over the upstream headwall.
<b>Level Datum &amp; Source:</b>	NAVD88 (Computed using GEOID12B)
<b>Method used:</b>	OPUS-RS Solution
<b>Date Elevation Obtained:</b>	5/06/2019
<b>Apparent Magnitude:</b>	Normal <input type="checkbox"/> Medium <input checked="" type="checkbox"/> Extreme <input type="checkbox"/> Unknown <input type="checkbox"/>
<b>Was Highwater Mark obtained from actual water, drift, local resident, or other source?</b>	Highwater was obtained from actual drift line on road.
<b>Explanatory Remarks:</b>	Approx. 3" of rain occurred overnight in the upstream area of this location.

Name (Signature) \_\_\_\_\_

Name (Printed) Steve Perring

Date 5/06/2019

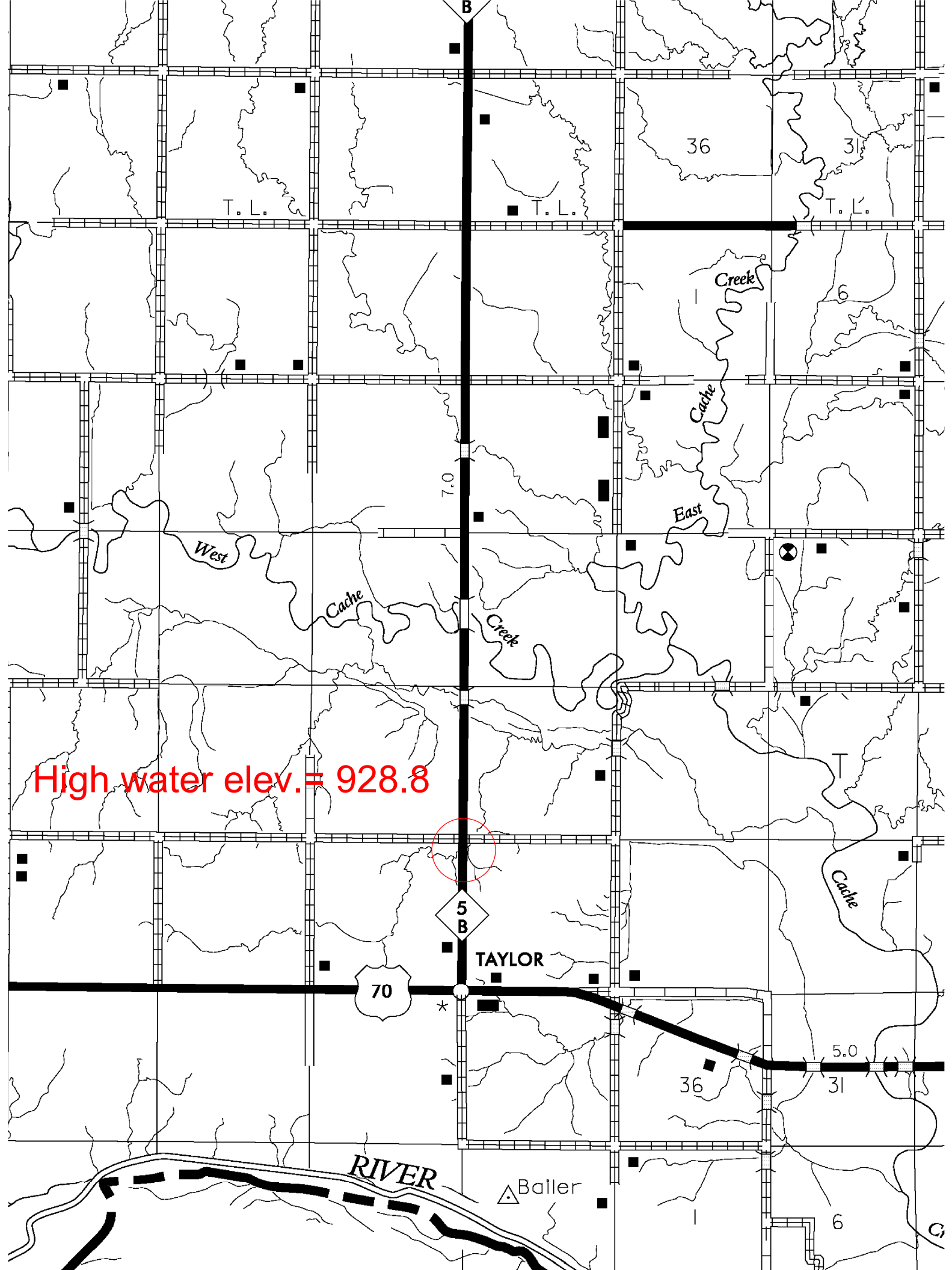

High water elev. = 928.8

5  
B

TAYLOR

70

RIVER

Baller

36

31

T.L.

T.L.

T.L.

Creek

6

Cache

East

West

Cache

Creek

Cache

5.0

36

31

6

5

7.0