



**OKLAHOMA DEPARTMENT OF TRANSPORTATION
SURVEY DIVISION**

FLOOD INFORMATION FORM

Division #:	1 <input type="checkbox"/> 2 <input type="checkbox"/> 3 <input type="checkbox"/> 4 <input type="checkbox"/> 5 <input type="checkbox"/> 6 <input type="checkbox"/> 7 <input checked="" type="checkbox"/> 8 <input type="checkbox"/>
County:	Cotton
Date Highwater occurred:	06/15/15
Highway Number:	U.S. 277
Name of Stream:	N/A
Direction and distance from nearest town, or highway junction	Location is approximately 0.3 miles west of U.S. 277/U.S. 70 junction just west of Randlett.
Section, Township, Range:	Near the SW/COR.of Sec.29,T-4-S, R-12-W, I.M.
Description of Location:	Water crosses roadway from field over U.S. 70
Highwater Elevation:	Highwater elev. was 1.00 feet above centerline of pavement.
Level Datum & Source:	
Method used:	Resident Testimony
Date Elevation Obtained:	09/21/15
Apparent Magnitude:	Normal <input type="checkbox"/> Medium <input type="checkbox"/> Extreme <input checked="" type="checkbox"/> Don't Know <input type="checkbox"/>
Was Highwater Mark obtained from actual water, drift, local resident, or other source?	Highwater mark was obtained from consultation with local residents. There were no drift remnants remaining to be identified.
Explanatory Remarks:	

Note: Show Vicinity Map on back of form

Name (signature) _____
 Name (Printed) DERRICK E. ANDERSON, PLS
 Date: 09/22/15

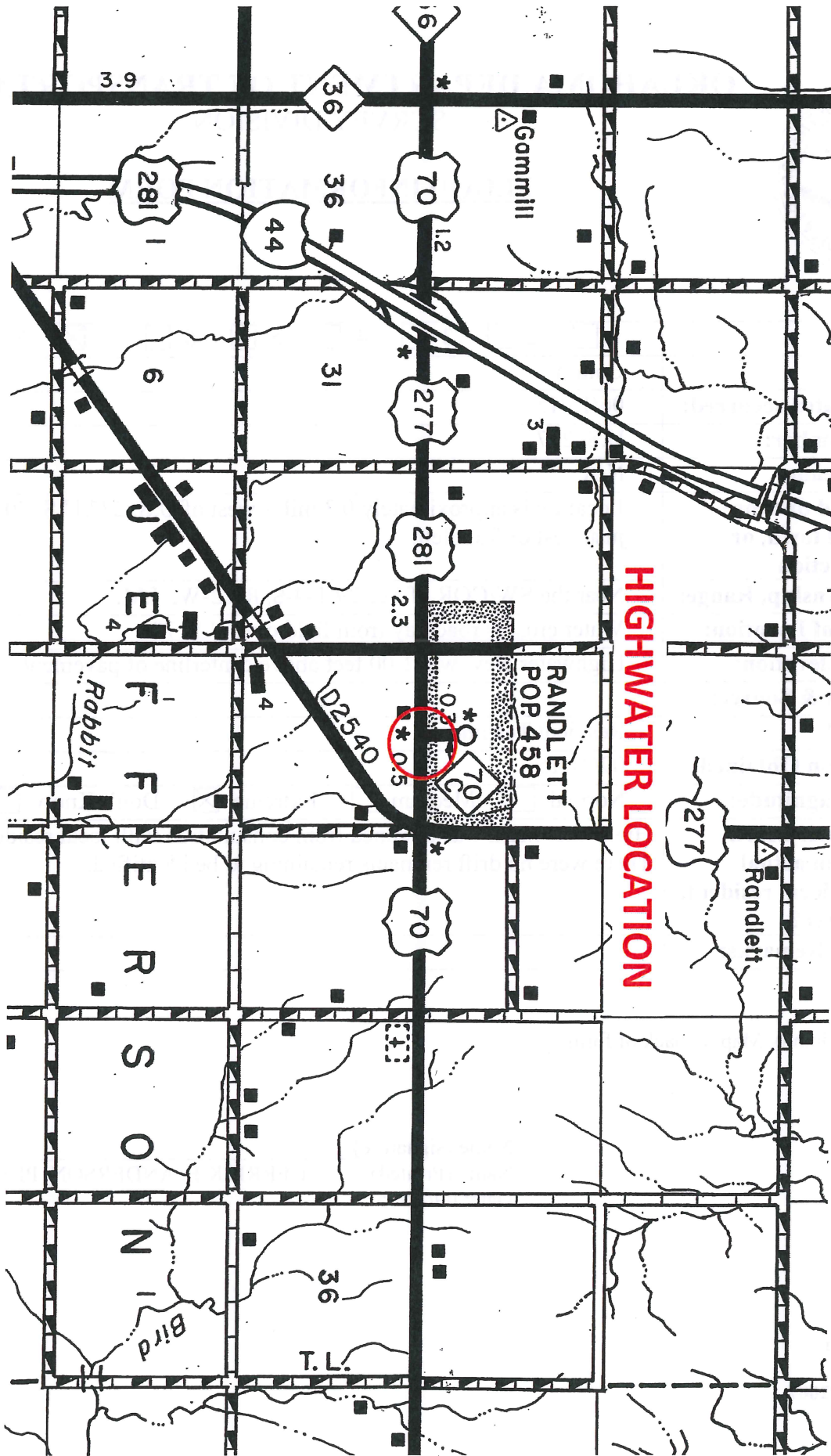

HIGHWATER LOCATION

RANDLETT
POP. 458

Gammill

JENSEN

FERSON
Rabbit

FERSON

Bird

05

31

102540

36

36

3.9

6

4

4

4

4

4

4

4

4

4

4

4

4

1.6

1.2

2.3

0.7

1.2

1.1

7.1

1.6

281

44

70

277

281

70

277

Randlett