

RECEIVED  
DEC 7 1983  
SURVEY DIVISION

Survey Division  
Form No. 16  
Rev. Sept. 10, 1961

STATE OF OKLAHOMA  
DEPARTMENT OF HIGHWAYS  
SURVEY DIVISION  
FLOOD INFORMATION FORM

To be used in obtaining and transmitting flood water elevations for Survey Division office record files. This information to be obtained by all Chiefs of Party or others in their vicinity in times of unusual high water, or at any time available from a reliable source. The elevations can be recorded by level reading, by measurement from bridge floor, in relation to a house, above roadbed or any other dependable, clear manner that fits the situation, the highest order possible to be used. Separate report to be made on each crossing or place obtained.

County COTTON Date highwater occurred OCTOBER 20, 1983

Highway number SH 65 Name of stream DRAIN

Direction and distance from nearest town, village or store 1.0 MILES SOUTH OF HULEN

Section, Township and Range SEC. 3, T1S, R10W

Description of Location APPROX. 300 FT. NORTH OF THE SE COR. OF SEC. 3, T1S, R10W IN CENTERLINE OF HIGHWAY.

Elevation 1055.8 Source of levels USC&GS FAS S-715(4)S PLANS

Method obtained Y-LEVEL Date obtained OCTOBER 26, 1983

Did it appear to be  normal  medium  extreme  do not know

Was highwater mark obtained from actual water, drift, local resident, U. S. Engineers, etc.? ACTUAL WATER MARK

Explanatory Remarks WATER WAS OVER THE ROAD 0.9 FT. DEEP

Location to be shown on back of this sheet as a check.

Field Note: To be sent to Survey Engineer

Bobby Earl Garland  
Chief of Party

NOV. 17, 1983  
Date

Copy to Bridge 12-13-83  
A2

LOCATION. No. 11

COMANCHE

KUNZ

COUNTY

STEPHENS

COUNTY

EFFERSON

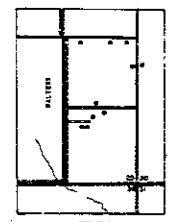
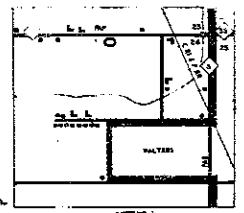
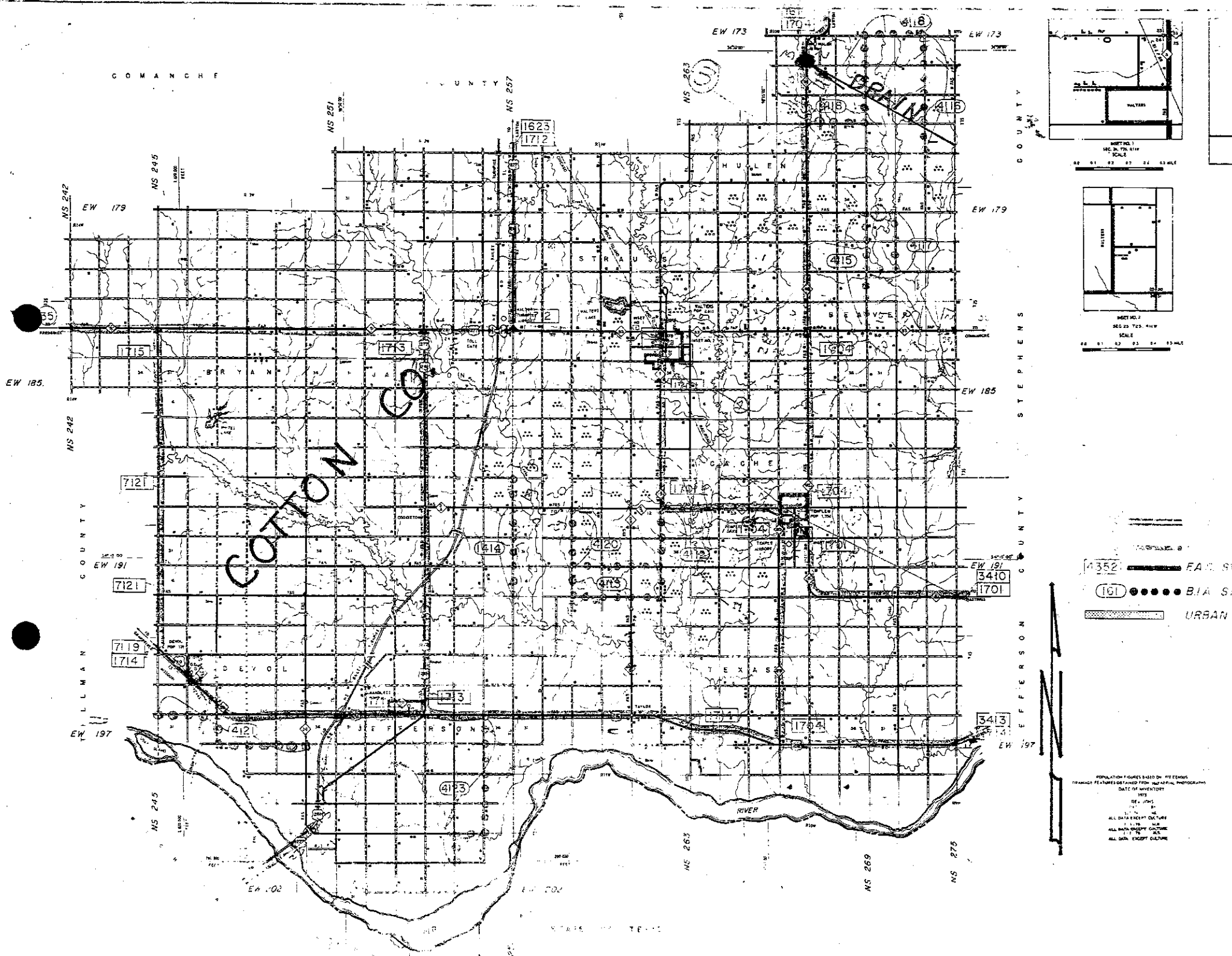

SCALE  
0 1 2 3 4 5 6 7 8 9 10

- 1352 E.A.C. ST.
- 101 B.I.A. S.
- URBAN

POPULATION FIGURES BASED ON 1950 CENSUS  
 PARCELS FEATURES OBTAINED FROM AERIAL PHOTOGRAPHS  
 DATE OF INVENTORY  
 REVISIONS  
 ALL DATA EXCEPT CULTURE  
 ALL DATA EXCEPT CULTURE  
 ALL DATA EXCEPT CULTURE