

RECEIVED
DEC 7 1983
SURVEY DIVISION

Survey Division
Form No. 16
Rev. Sept. 10, 1961

STATE OF OKLAHOMA
DEPARTMENT OF HIGHWAYS
SURVEY DIVISION
FLOOD INFORMATION FORM

To be used in obtaining and transmitting flood water elevations for Survey Division office record files. This information to be obtained by all Chiefs of Party or others in their vicinity in times of unusual high water, or at any time available from a reliable source. The elevations can be recorded by level reading, by measurement from bridge floor, in relation to a house, above roadbed or any other dependable, clear manner that fits the situation, the highest order possible to be used. Separate report to be made on each crossing or place obtained.

County COTTON Date highwater occurred OCTOBER 20, 1983

Highway number I-44 Name of stream RED RIVER

Direction and distance from nearest town, village or store 4.0 MILES WEST AND 5.0 MILES SOUTH OF JCT. US 70 & US 277, IN RANDETT.

Section, Township and Range SEC. 23, T5S, R13W.

Description of Location APPROX. 50 FT. SOUTH & 50 FT. EAST OF THE NORTH END OF THE SOUTH BOUND BRIDGE.

Elevation 970.3 Source of levels USC&GS FAP BRP 3(24) TEXAS NEW BRIDGE PLANS

Method obtained Y-LEVEL Date obtained OCTOBER 26, 1983

Did it appear to be normal medium extreme do not know

Was highwater mark obtained from actual water, drift, local resident, U. S. Engineers, etc.? DRIFT

Explanatory Remarks _____

Location to be shown on back of this sheet as a check.

Field Note: To be sent to
Survey Engineer

Bobby Earl Garland
Chief of Party

NOV. 17, 1983
Date

*Copy to Bridge 12-13-83
A2*

LOCATION NO. 12

COMANCHE COUNTY

COUNTY

COUNTY

STEPHENS COUNTY

COUNTY

EFFERSON COUNTY

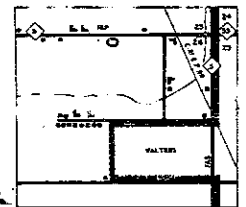

NORTH NO. 1
 SEC. 26, T. 21 N., R. 11 W.
 SCALE
 0 0.1 0.2 0.3 0.4 0.5 MILE

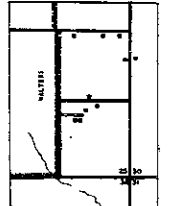

NORTH NO. 2
 SEC. 26, T. 21 N., R. 11 W.
 SCALE
 0 0.1 0.2 0.3 0.4 0.5 MILE

4352 F.A.S.
 (161) B.I.A.
 URBAN

POPULATION FIGURES BASED ON 1950 CENSUS
 ORANGE FEATURES OBTAINED FROM 1947 AERIAL PHOTOGRAPHS
 DATE OF INVENTORY
 1952
 REVISIONS
 DATE BY
 1-1-52 M.S.
 ALL DATA EXCEPT DATE BY
 1-1-52 M.S.
 ALL DATA EXCEPT DATE BY
 1-1-52 M.S.
 ALL DATA EXCEPT DATE BY
 1-1-52 M.S.

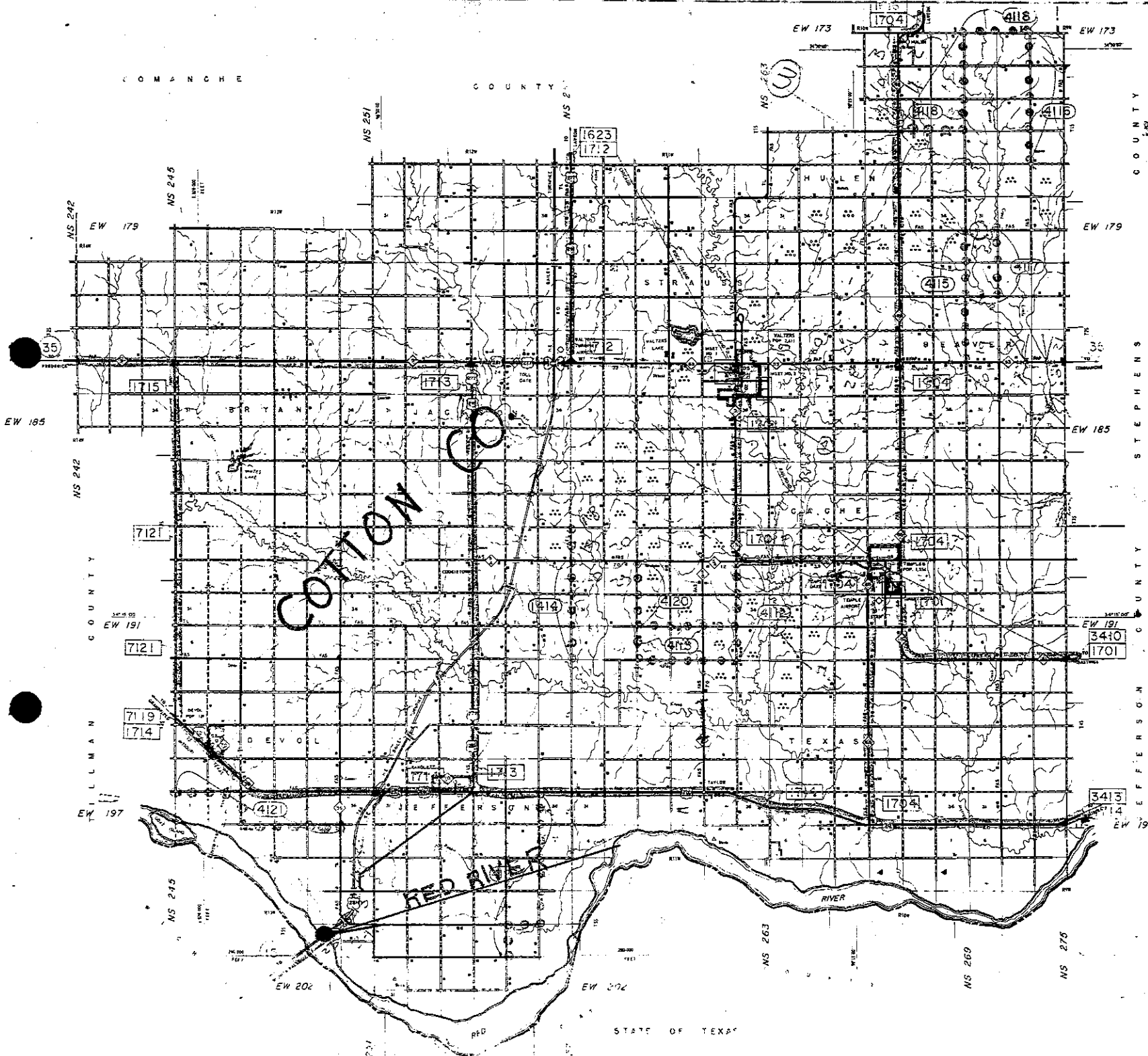

STATE OF TEXAS