

RECEIVED  
DEC 7 1983  
SURVEY DIVISION

Survey Division  
Form No. 16  
Rev. Sept. 10, 1961

STATE OF OKLAHOMA  
DEPARTMENT OF HIGHWAYS  
SURVEY DIVISION

FLOOD INFORMATION FORM

To be used in obtaining and transmitting flood water elevations for Survey Division office record files. This information to be obtained by all Chiefs of Party or others in their vicinity in times of unusual high water, or at any time available from a reliable source. The elevations can be recorded by level reading, by measurement from bridge floor, in relation to a house, above roadbed or any other dependable, clear manner that fits the situation, the highest order possible to be used. Separate report to be made on each crossing or place obtained.

County COTTON Date highwater occurred OCTOBER 20, 1983

Highway number SH 53 Name of stream LITTLE BEAVER CREEK

Direction and distance from nearest town, village or store 9.5 MILES EAST OF JCT. SH 53 & SH. 5 IN WALTERS, OKLAHOMA

Section, Township and Range SEC. 21, T2S, R9W.

Description of Location AT NE COR. OF BRIDGE

Elevation 964.8 Source of levels USC&GS FAP 157 F&G PLANS

Method obtained Y-LEVEL Date obtained OCTOBER 26, 1983

Did it appear to be  normal  medium  extreme  do not know

Was highwater mark obtained from actual water, drift, local resident, U. S. Engineers, etc.? ACTUAL WATER MARK

Explanatory Remarks \_\_\_\_\_

Location to be shown on back of this sheet as a check.

Field Note: To be sent to  
Survey Engineer

Bobby Earl Garland  
Chief of Party

NOV. 17, 1983  
Date

Copy to Bridge 12-13-83  
A2

LOCATION No. 13

COMANCHE

COUNTY

COUNTY

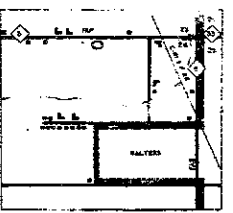

SHEET NO. 1  
 1/4 SECTION  
 SCALE  
 0 1 2 3 4 5 6 7 8 9 10

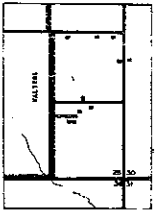

SHEET NO. 2  
 1/4 SECTION  
 SCALE  
 0 1 2 3 4 5 6 7 8 9 10

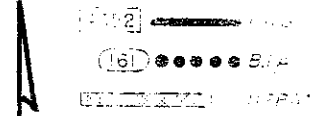
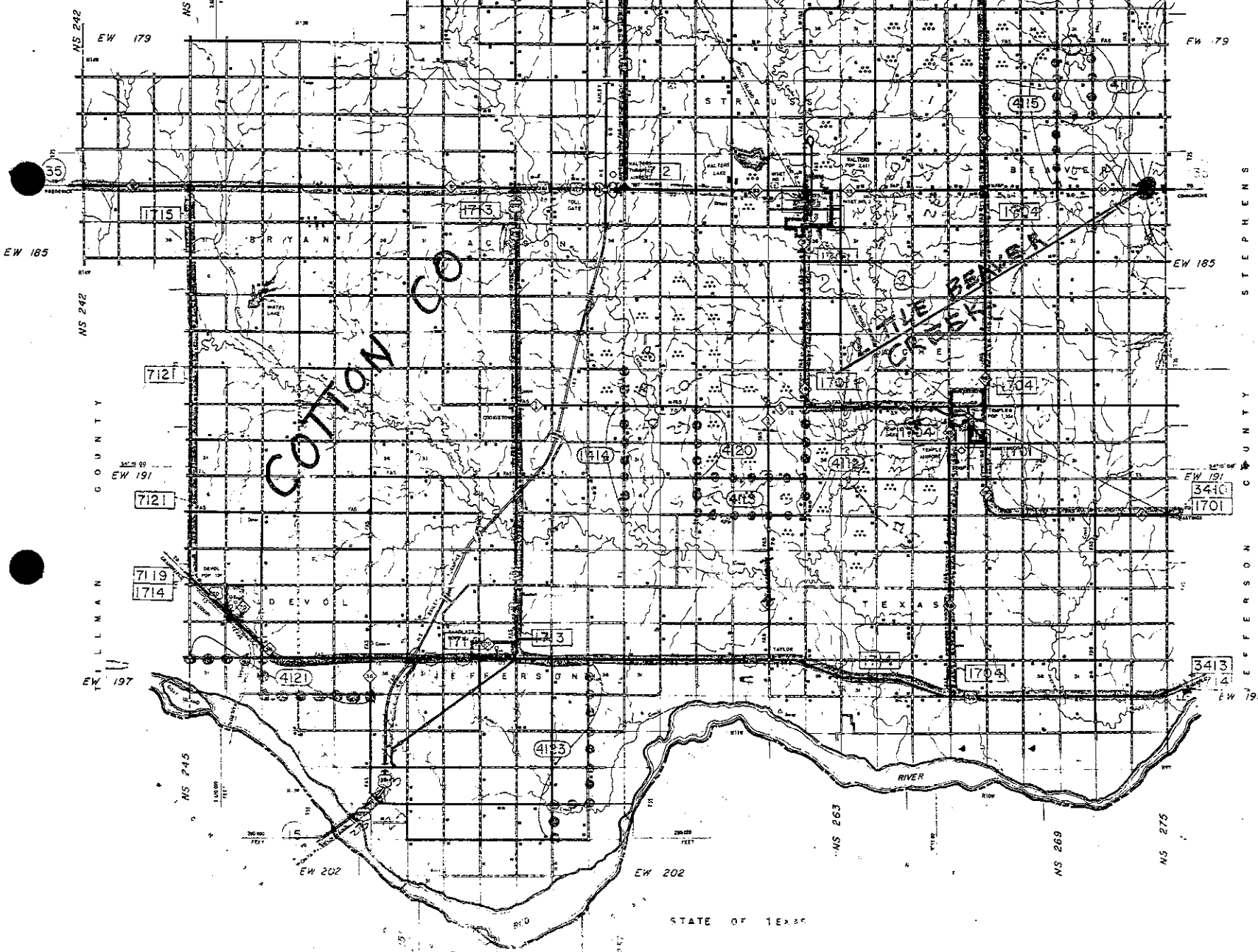

POPULATION FIGURES BASED ON 1950 CENSUS  
 DRAINAGE FEATURES DERIVED FROM AERIAL PHOTOGRAPHS  
 DATE OF ACQUISITION  
 1953  
 ALL DATA IN THIS MAP  
 ALL DATA SUBJECT TO CHANGE  
 ALL DATA SUBJECT TO CHANGE

STATE OF TEXAS