



OKLAHOMA DEPARTMENT OF TRANSPORTATION  
SURVEY DIVISION

**FLOOD INFORMATION FORM**

<b>Division #:</b>	1 <input type="checkbox"/> 2 <input type="checkbox"/> 3 <input type="checkbox"/> 4 <input type="checkbox"/> 5 <input type="checkbox"/> 6 <input type="checkbox"/> 7 <input checked="" type="checkbox"/> 8 <input type="checkbox"/>
<b>County:</b>	Comanche
<b>Date Highwater occurred:</b>	6/12/2016
<b>Highway Number:</b>	SH 65
<b>Name of Stream:</b>	Dry Beaver Creek
<b>Direction and distance from nearest town, or highway junction</b>	Approx. 3.4 miles South of Jct. SH 7 & SH 65
<b>Section, Township, Range:</b>	Section 31 T 2 N , R 9 W
<b>Description of Location:</b>	Cultivation and heavy timber. Water crossed over SH 65 approx. 300' North of Dry Beaver Creek Bridge.
<b>Latitude</b>	34^32'40" N
<b>Longitude</b>	98^12'44" W
<b>Highwater Elevation:</b>	1050' or Approximately 2" above asphalt.
<b>Level Datum &amp; Source:</b>	NAVD88 (Computed using GEOID12B)
<b>Method used:</b>	OPUS-RS Solution utilizing RTK
<b>Date Elevation Obtained:</b>	6/16/2016
<b>Apparent Magnitude:</b>	Normal <input type="checkbox"/> Medium <input type="checkbox"/> Extreme <input checked="" type="checkbox"/> Unknown <input type="checkbox"/>
<b>Was Highwater Mark obtained from actual water, drift, local resident, or other source?</b>	Highwater was obtained from actual drift line.
<b>Explanatory Remarks:</b>	8"-10" of rain occurred overnight in the upstream area of this location.

Name (Signature) \_\_\_\_\_

Name (Printed) \_\_\_\_\_

Kyle D. Adams

Date \_\_\_\_\_

6/20/2016

Note: Show Vicinity Map on back of form

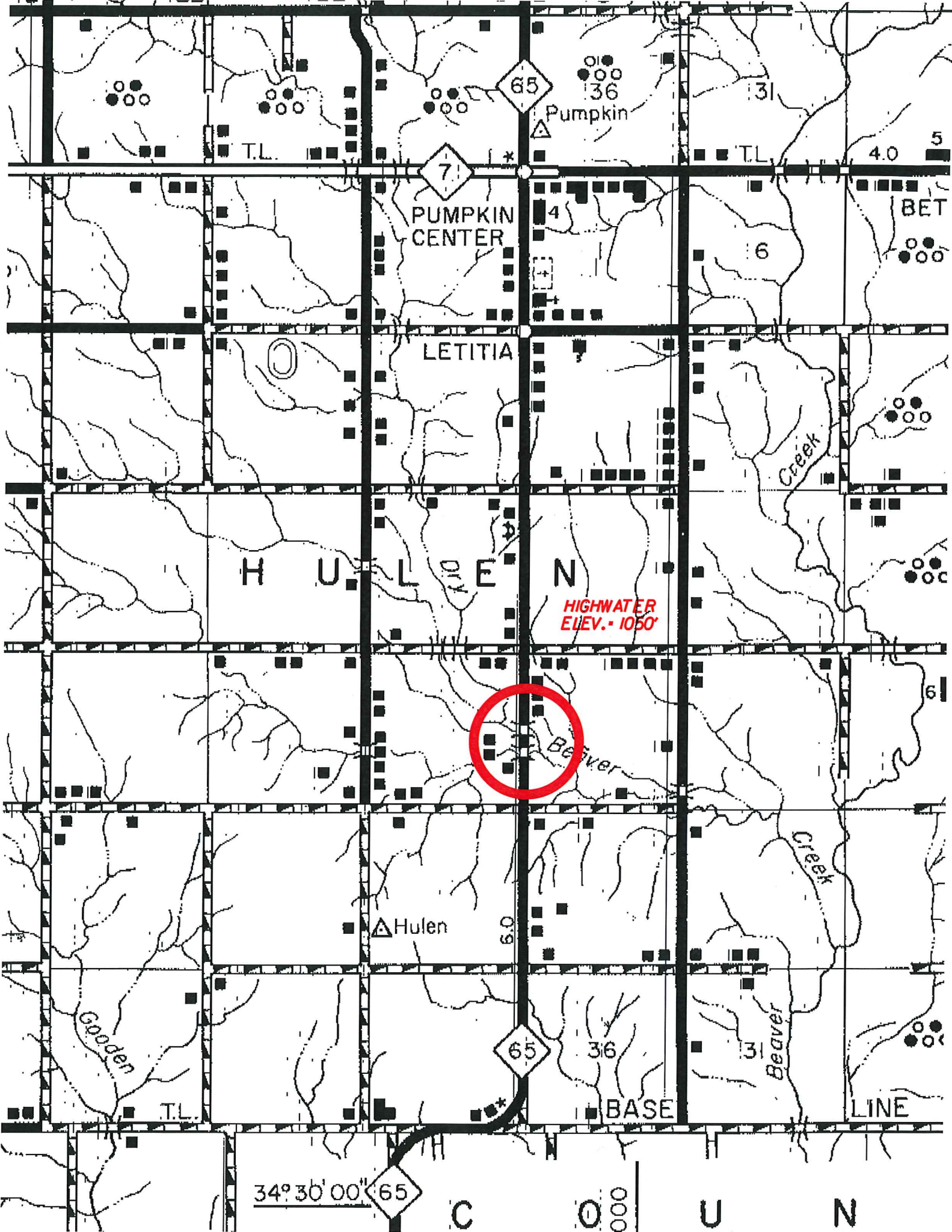

65

Pumpkin

PUMPKIN CENTER

LETITIA

H U L E N

HIGHWATER  
ELEV. - 1050'

Beaver

Hulen

65

36

BASE

34° 30' 00"

C O U N