



OKLAHOMA DEPARTMENT OF TRANSPORTATION
SURVEY DIVISION

FLOOD INFORMATION FORM

Division #:	1 <input type="checkbox"/> 2 <input type="checkbox"/> 3 <input type="checkbox"/> 4 <input type="checkbox"/> 5 <input type="checkbox"/> 6 <input type="checkbox"/> 7 <input checked="" type="checkbox"/> 8 <input type="checkbox"/>
County:	Comanche
Date Highwater occurred:	6/12/2016
Highway Number:	SH 7
Name of Stream:	Unnamed
Direction and distance from nearest town, or highway junction	Approx. 1.0 miles West of Jct. SH 7 & SH 65
Section, Township, Range:	Section 35 T 2 N , R 10 W
Description of Location:	Pasture and light timber. Water crossed over West bound lanes on SH 7.
Latitude	34°35'39" N
Longitude	98°13'47" W
Highwater Elevation:	1096' or Approximately 1.5' above asphalt.
Level Datum & Source:	NAVD88 (Computed using GEOID12B)
Method used:	OPUS-RS Solution utilizing RTK
Date Elevation Obtained:	6/16/2016
Apparent Magnitude:	Normal <input type="checkbox"/> Medium <input type="checkbox"/> Extreme <input checked="" type="checkbox"/> Unknown <input type="checkbox"/>
Was Highwater Mark obtained from actual water, drift, local resident, or other source?	Highwater was obtained from actual drift line. High Water information was obtained from John Elam, Trans. Superintendant, Comanche Co. Maintenance.
Explanatory Remarks:	5"-7" of rain occurred overnight in the upstream area of this location.

Name (Signature) _____

Name (Printed) _____

Kyle D. Adams

Date _____

6/20/2016

Note: Show Vicinity Map on back of form

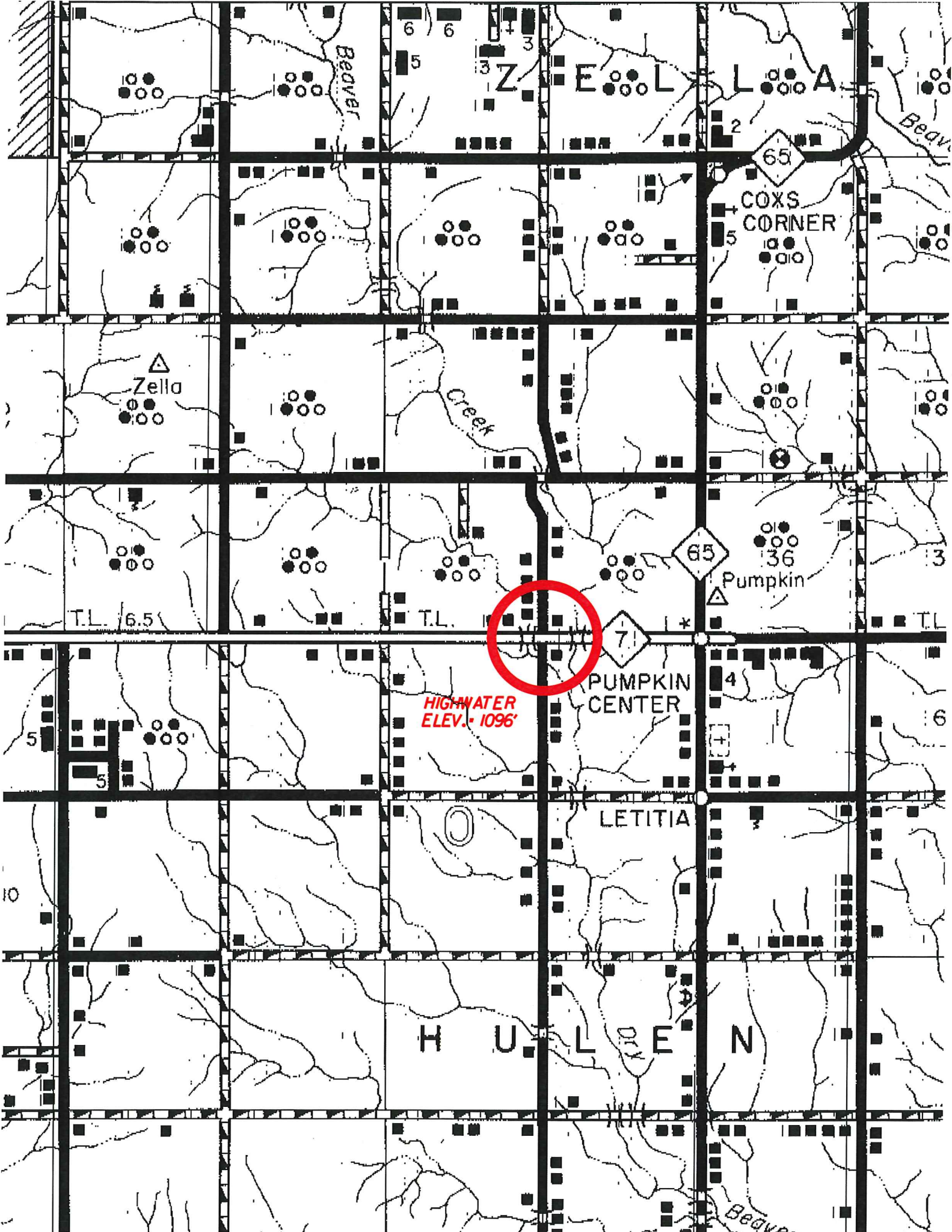

**HIGHWATER
ELEV. 1096'**

Zella

COXS
CORNER

PUMPKIN
CENTER

LETITIA

H U L E N



TL 6.5

TL

71

TL

Pumpkin

36

65

65

4

3

6

10

5

5

6

6

4

3

5

3

4

3

2

5

△

○ ○ ○

○ ○ ○

○ ○ ○

○ ○ ○

○ ○ ○

○ ○ ○

○ ○ ○

○ ○ ○

○ ○ ○

○ ○ ○

○ ○ ○

○ ○ ○

○ ○ ○

○ ○ ○

○ ○ ○

○ ○ ○

○ ○ ○

○ ○ ○

○ ○ ○

○ ○ ○

○ ○ ○

○ ○ ○

○ ○ ○

○ ○ ○

○ ○ ○

○ ○ ○

○ ○ ○

○ ○ ○

○ ○ ○

○ ○ ○

○ ○ ○

○ ○ ○

○ ○ ○

○ ○ ○

○ ○ ○

○ ○ ○

○ ○ ○

○ ○ ○

○ ○ ○

○ ○ ○

○ ○ ○

○ ○ ○

○ ○ ○

○ ○ ○

○ ○ ○

○ ○ ○

○ ○ ○

○ ○ ○

