

STATE OF OKLAHOMA
DEPARTMENT OF HIGHWAYS
PLANS AND SURVEY DEPARTMENT

FLOOD INFORMATION FORM

To be used in obtaining and transmitting flood water elevations for Plans & Survey office record files. This information to be obtained by all Chiefs of Party in their vicinity in times of unusual high water, or at any time available from a reliable source. The elevations can be recorded by level reading, by measurement from bridge floor, in relation to a house, above roadbed or any other dependable, clear manner that fits the situation, the highest order possible to be used. Separate report to be made on each crossing or place obtained.

County COMANCHE Date highwater occurred May 17, 1951

Highway number S.H. 65 Name of stream Branch of Beaver Creek

Direction and distance from nearest town, village or store 7.8 Miles South
and 1 Mile West of Junction of S.H. 17 & S.H. 65
in Sterling

Section, Township and Range Between Sec 13-T2N-R10W & Sec 18-T2N-R9W

Description of Location At the Southeast Corner of the South
End of a 80' Timber Bridge

Method obtained _____

Elevation HW is 2.9 higher than Br. Floor
SE Cor S. End of Br. Source of levels _____

Was highwater mark obtained from actual water, drift, local resident,
U. S. Engineers, etc? From Drift & Water Mark on Br

Explanatory Remarks Obtained by A. B. Stephens and D. D. Clifton

Location to be shown on back of this sheet as a check.

Field Note: To be sent to Engr.
of Plans & Survey (1 copy).
Office Note: To be filed in Flood
Information by Counties.

A. B. Stephens
Chief of Party
Res. Engineer
May 25, 1951
Date

NOTE: SEE NO. 2 ATTACHED
MAP FOR LOCATION

LOC. NO. 1A

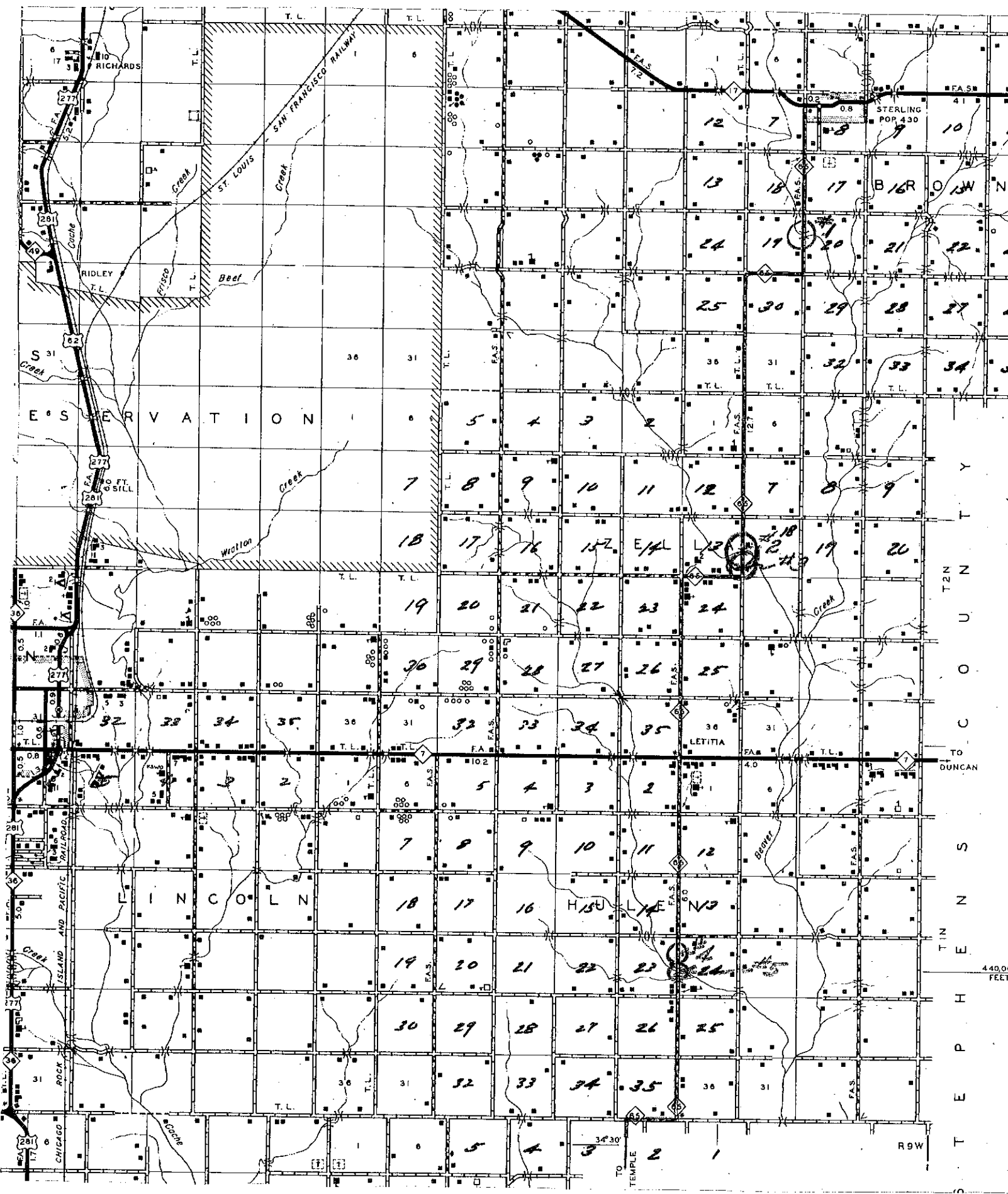

T N
 T 2 N
 C O U N
 T Y
 S
 T I N
 T I N
 P H
 E
 T E
 R
 T E
 M
 P
 L
 E

440,000 FEET

R9W