

OKLAHOMA DEPARTMENT OF TRANSPORTATION
SURVEY DIVISION

FLOOD INFORMATION FORM

Division #:	1 <input type="checkbox"/> 2 <input type="checkbox"/> 3 <input type="checkbox"/> 4 <input type="checkbox"/> 5 <input type="checkbox"/> 6 <input type="checkbox"/> 7 <input checked="" type="checkbox"/> 8 <input type="checkbox"/>
County:	COMANCHE
Date Highwater occurred:	06/29/07
Highway Number:	S.H. 7
Name of Stream:	Cache Creek
Direction and distance from nearest town, or highway junction	Location is S.H. 7, 1.25 miles east of Railroad St. and 0.25 miles west of Tower Rd. in Lawton.
Section, Township, Range:	Between Sec's. 33, T-2-N, R-11-W & Sec. 4, T-1-N, R-11-W., I.M.
Description of Location:	Water crossed over the highway.
Highwater Elevation:	1074.29 (1072.79 Pavement)
Level Datum & Source:	Elevation tied to ODOT Standard Brass Monument No. C-16-150
Method used:	Differential Leveling
Date Elevation Obtained:	07/02/07
Apparent Magnitude:	Normal <input type="checkbox"/> Medium <input type="checkbox"/> Extreme <input checked="" type="checkbox"/> Don't Know <input type="checkbox"/>
Was Highwater Mark obtained from actual water, drift, local resident, or other source?	Highwater Mark obtained by locating drift in the center median.
Explanatory Remarks:	Water was approximately 1.5 feet over the pavement.

Note: Show Vicinity Map on back of form

Name (signature)

Name (Printed)

Danny R. Dees, PLS

Date: 7/9/2007

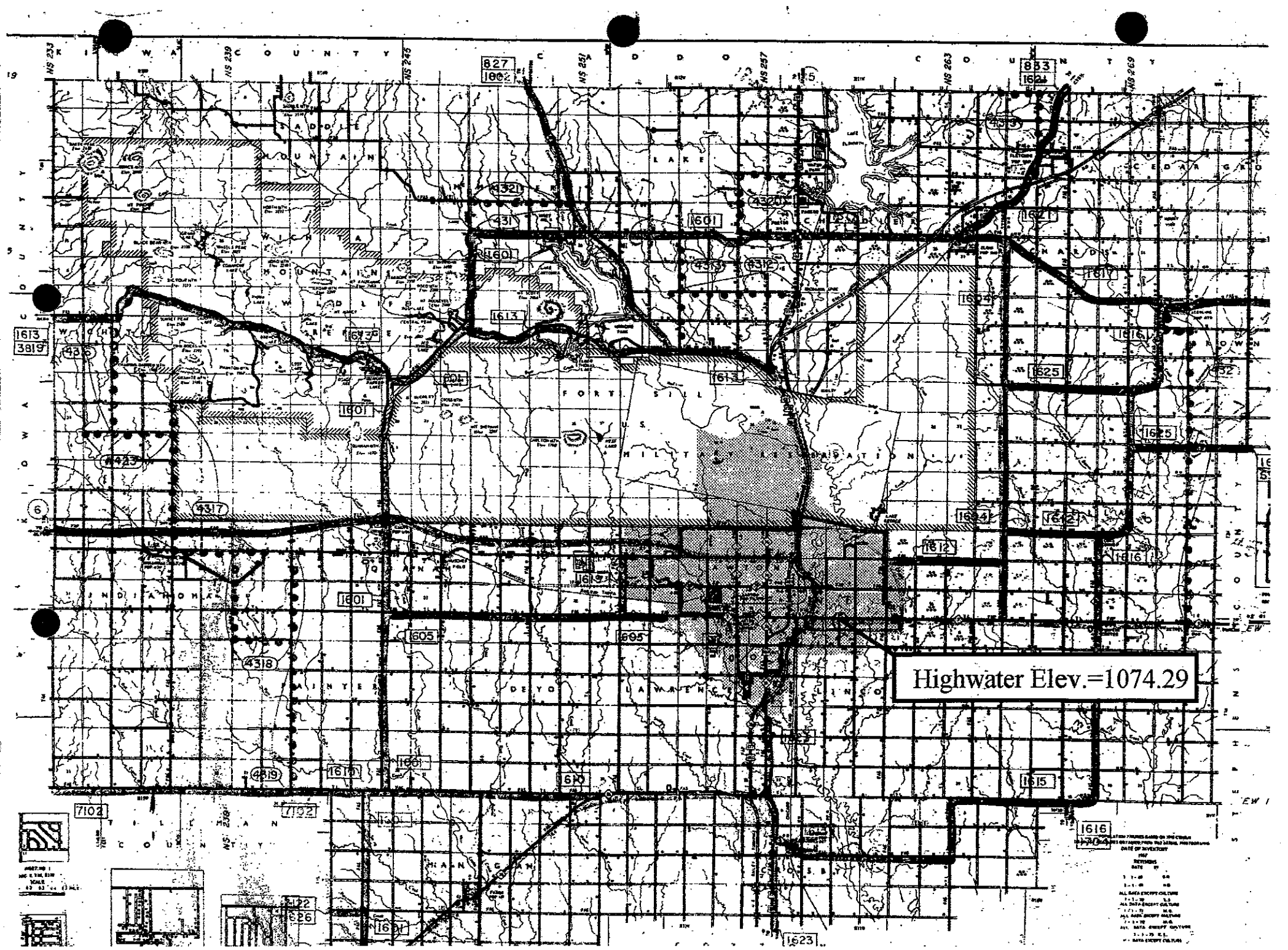

Highwater Elev. = 1074.29



SECTION 1
SCALE 1:25,000



SECTION 1	
SYMBOL	DESCRIPTION
(Symbol)	WATER
(Symbol)	ROAD
(Symbol)	RAILROAD
(Symbol)	POWER LINE
(Symbol)	CONTOUR
(Symbol)	BOUNDARY
(Symbol)	SETBACK
(Symbol)	PROPERTY LINE
(Symbol)	ADJACENT COUNTY
(Symbol)	ADJACENT TOWNSHIP
(Symbol)	ADJACENT RANGE
(Symbol)	ADJACENT SECTION