

STATE OF OKLAHOMA
DEPARTMENT OF HIGHWAYS
PLANS AND SURVEY DEPARTMENT

FLOOD INFORMATION FORM

To be used in obtaining and transmitting flood water elevations for Plans & Survey office record files. This information to be obtained by all Chiefs of Party in their vicinity in times of unusual high water, or at any time available from a reliable source. The elevations can be recorded by level reading, by measurement from bridge floor, in relation to a house, above roadbed or any other dependable, clear manner that fits the situation, the highest order possible to be used. Separate report to be made on each crossing or place obtained.

County Omanche Date highwater occurred June 2, 1962

Highway number US 277 & 62 Name of stream Medicine Bluff Creek

Direction and distance from nearest town, village or store 3.6 miles north of
3-Level Interchange in Lawton, Oklahoma.

Section, Township and Range Section 32, T 3 N, R 11 W.

Description of Location Highwater elevation was obtained approx. 200 feet east
of northlane bridge on south bank of creek.

Method obtained Hand level androd level.

Elevation _____ Source of levels _____

Was highwater mark obtained from actual water, drift, local resident,
U. S. Engineers, etc? From drifts.

Explanatory Remarks Flood water information was obtained 12 days after highwater.
From center line of north lane bridge top of bridge floor down 7.4 feet.

Location to be shown on back of this sheet as a check.

Field Note: To be sent to Engr.
of Plans & Survey (1 copy).
Office Note: To be filed in Flood
Information by Counties.

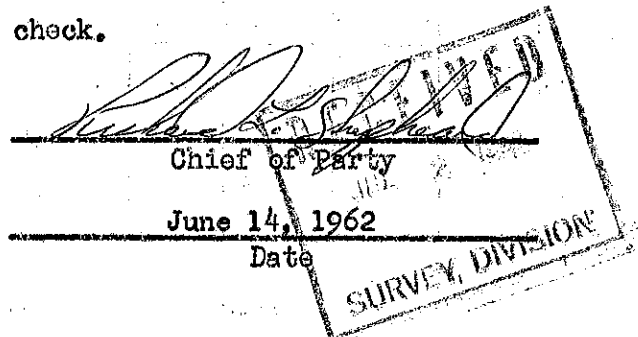
Chief of Party
June 14, 1962
Date
SURVEY DIVISION

Loc. # 5

R 12 W

R 11 W

T 4 N

T 3 N

T 2 N

T 1 N

T 4 N

T 3 N

T 2 N

T 1 N

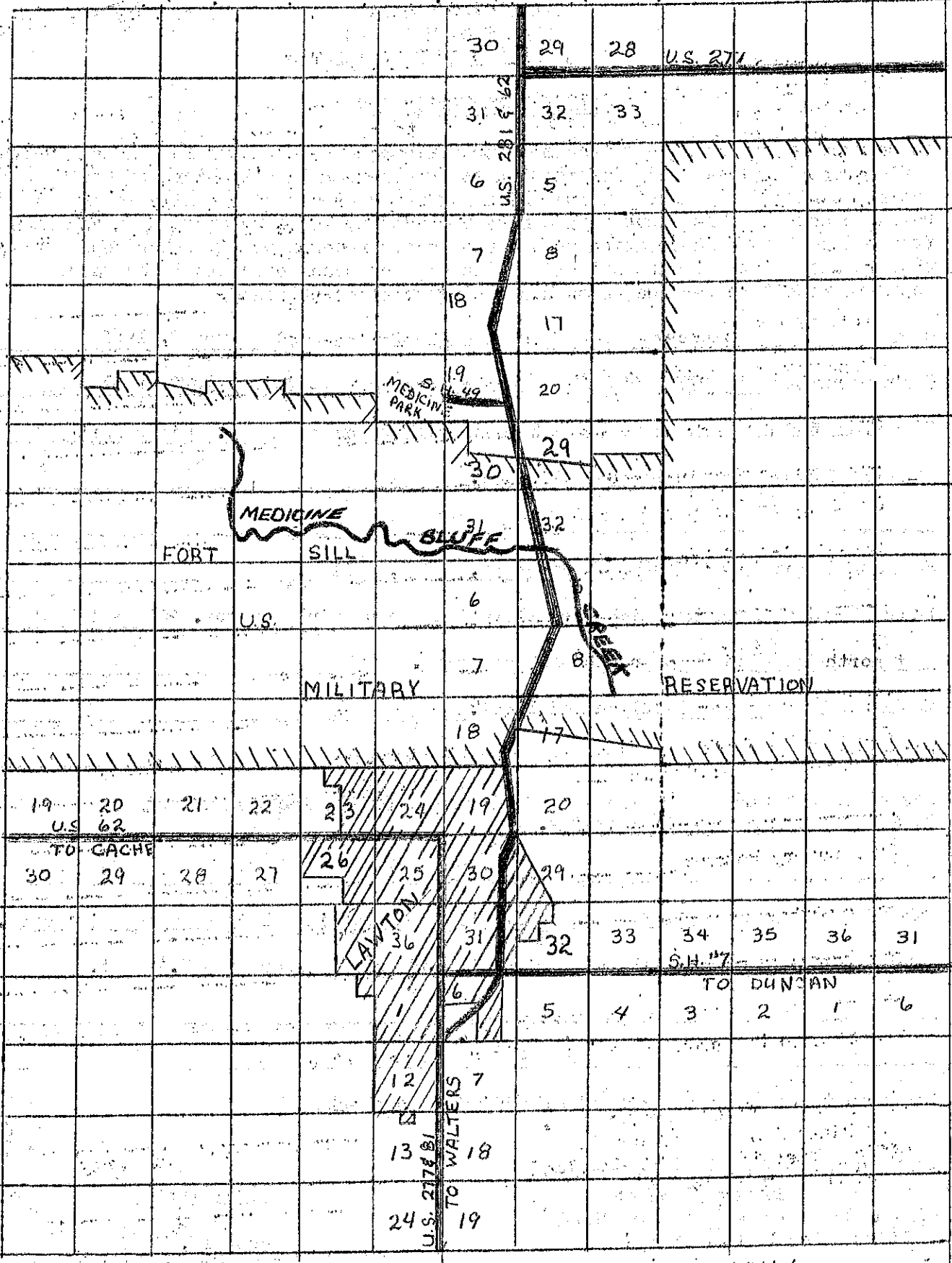

R 12 W

R 11 W