

STATE OF OKLAHOMA
DEPARTMENT OF HIGHWAYS
PLANS AND SURVEY DEPARTMENT

FLOOD INFORMATION FORM

To be used in obtaining and transmitting flood water elevations for Plans & Survey office record files. This information to be obtained by all Chiefs of Party in their vicinity in times of unusual high water, or at any time available from a reliable source. The elevations can be recorded by level reading, by measurement from bridge floor, in relation to a house, above roadbed or any other dependable, clear manner that fits the situation, the highest order possible to be used. Separate report to be made on each crossing or place obtained.

County Comanche Date highwater occurred June 2, 1962

Highway number U S 277 & 62 Name of stream _____

Direction and distance from nearest town, village or store 8.0 miles north of

3- Level Interchange in Lawton, Oklahoma.

Section, Township and Range Section 18, T 3 N, R 11 W.

Description of Location Highwater elevation was obtained approx. 200 feet east of bridge on south bank of creek.

Method obtained Hand level and rod level.

Elevation _____ Source of levels _____

Was highwater mark obtained from actual water, drift, local resident, U. S. Engineers, etc? From drifts.

Explanatory Remarks Flood water information was obtained 12 days after highwater. From the south end of bridge on the top of bridge floor down 6.2 feet.

Location to be shown on back of this sheet as a check.

Field Note: To be sent to Engr. of Plans & Survey (1 copy).
Office Note: To be filed in Flood Information by Counties.

Richard A. [Signature]
Chief of Party
6-17-62
Date
SURVEY DIVISION

LOC. # 7

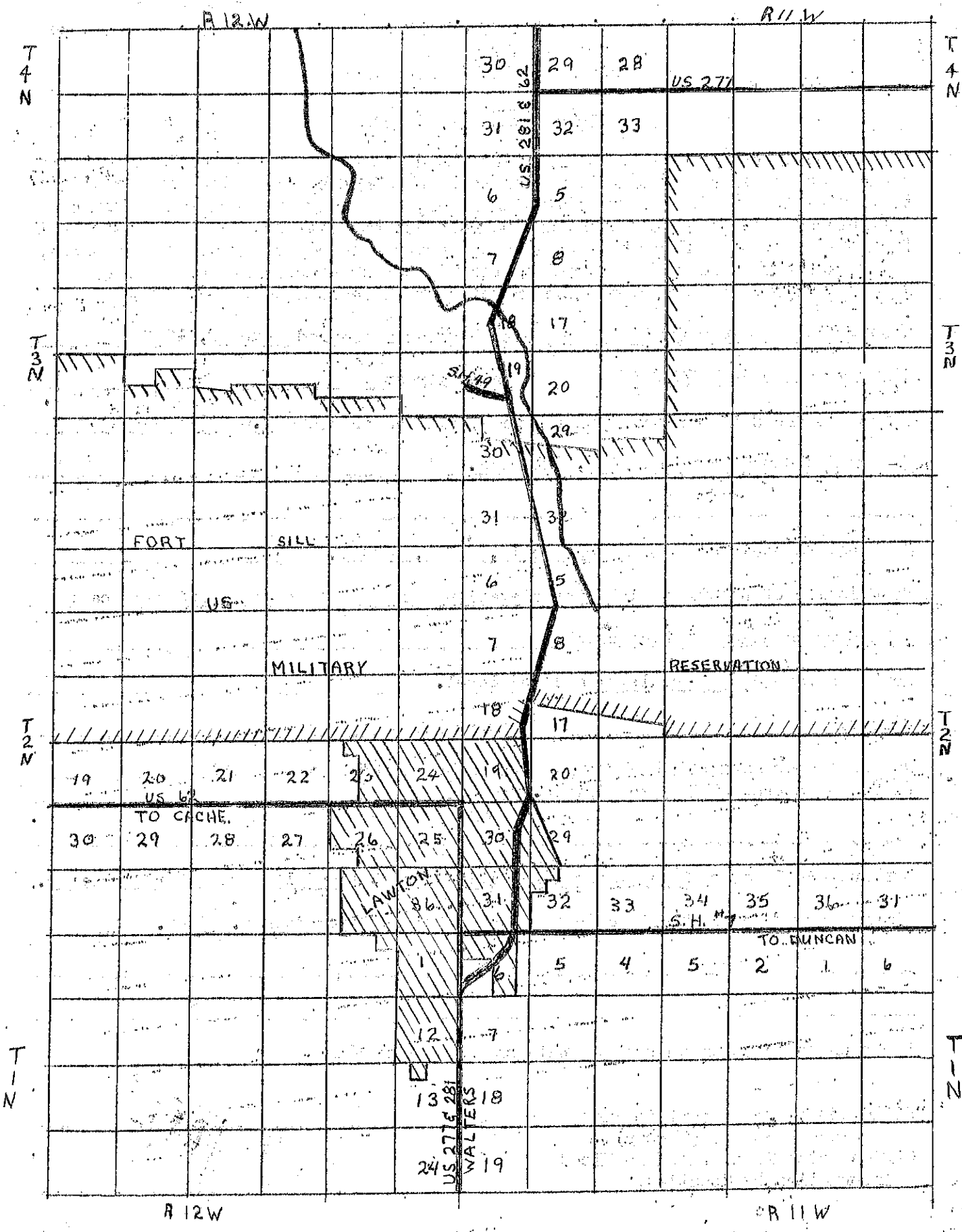

A 12 W

R 11 W

T 4 N

T 4 N

T 3 N

T 3 N

T 2 N

T 2 N

T 1 N

T 1 N

A 12 W

R 11 W

30

29

28

US 277

31

32

33

US 2918 62

6

5

7

8

8

17

S.H. 19

19

20

30

29

31

32

FORT

SILL

US

6

5

7

8

MILITARY

RESERVATION

18

17

19

20

21

22

23

24

19

20

US 62

30

29

28

27

26

25

30

29

TO CACHE

LAWTON

31

32

33

S.H. M.

34

35

36

31

TO HUNGAN

6

5

4

5

2

1

6

12

7

13

18

24

19

US 277 281
WALTERS