

STATE OF OKLAHOMA  
DEPARTMENT OF HIGHWAYS  
SURVEY DIVISION  
FLOOD INFORMATION FORM

Survey Division  
Form No. 16  
Rev. Sept. 10, 1961

To be used in obtaining and transmitting flood water elevations for Survey Division office record files. This information to be obtained by all Chiefs of Party or others in their vicinity in times of unusual high water, or at any time available from a reliable source. The elevations can be recorded by level reading, by measurement from bridge floor, in relation to a house, above roadbed or any other dependable, clear manner that fits the situation, the highest order possible to be used. Separate report to be made on each crossing or place obtained.

County COMANCHE Date highwater occurred OCTOBER 20, 1983

Highway number SH 7 Name of stream EAST CACHE CREEK

Direction and distance from nearest town, village or store 0.5 MILES EAST OF THE JCT. OF I-44 & SH 7 IN LAWTON

Section, Township and Range SEC. 32, T2N, R11W.

Description of Location AT THE NE COR. OF NORTH BRIDGE

Elevation 1073.6 Source of levels USC&GS FAP U-145(13) PLANS

Method obtained Y-LEVEL Date obtained OCTOBER 26, 1983

Did it appear to be  normal  medium  extreme  do not know

Was highwater mark obtained from actual water, drift, local resident, U. S. Engineers, etc.? ACTUAL WATER MARK

Explanatory Remarks THIS EXTREME HIGHWATER IS 2.7 FT. HIGHER THAN EXTREME HIGHWATER ON FAP U-145(13) PLANS.

Location to be shown on back of this sheet as a check.

Field Note: To be sent to Survey Engineer

Bobby Earl Garland  
Chief of Party

NOV. 17, 1983  
Date

*Copy to Bridge 12-13-83 A2*

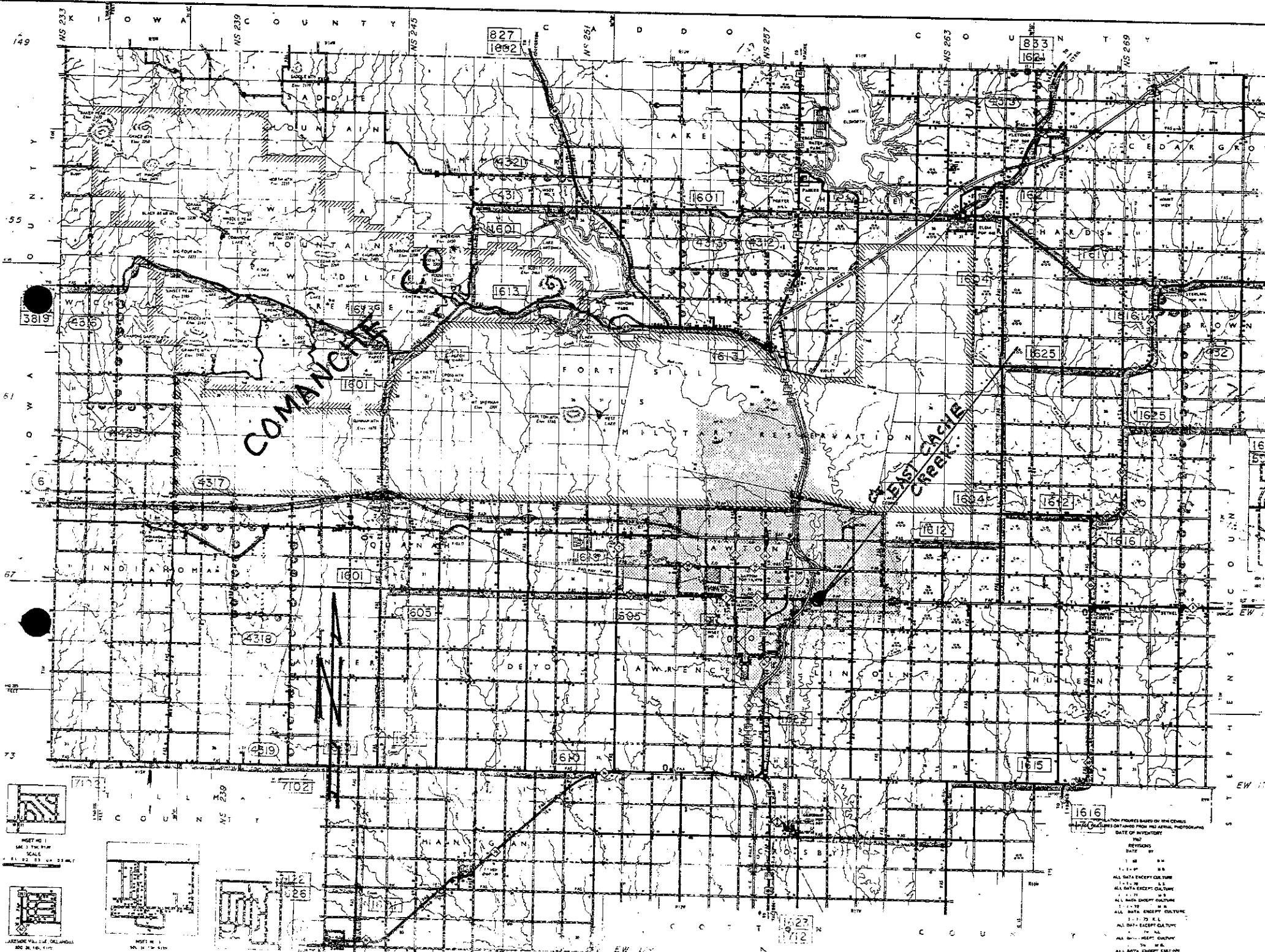

COMANCHE

EAST CREEK

FORT HILL RESERVATION

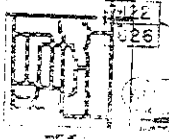
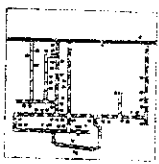
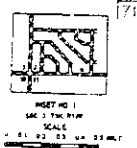

POPULATION FIGURES BASED ON THE CENSUS  
DATE OF INVENTORY

NO. PERSONS	DATE
1-18-54	54
1-1-54	54
1-1-53	53
1-1-52	52
1-1-51	51
1-1-50	50
1-1-49	49
1-1-48	48
1-1-47	47
1-1-46	46
1-1-45	45
1-1-44	44
1-1-43	43
1-1-42	42
1-1-41	41
1-1-40	40
1-1-39	39
1-1-38	38
1-1-37	37
1-1-36	36
1-1-35	35
1-1-34	34
1-1-33	33
1-1-32	32
1-1-31	31
1-1-30	30
1-1-29	29
1-1-28	28
1-1-27	27
1-1-26	26
1-1-25	25
1-1-24	24
1-1-23	23
1-1-22	22
1-1-21	21
1-1-20	20
1-1-19	19
1-1-18	18
1-1-17	17
1-1-16	16
1-1-15	15
1-1-14	14
1-1-13	13
1-1-12	12
1-1-11	11
1-1-10	10
1-1-9	9
1-1-8	8
1-1-7	7
1-1-6	6
1-1-5	5
1-1-4	4
1-1-3	3
1-1-2	2
1-1-1	1