

OKLAHOMA DEPARTMENT OF TRANSPORTATION  
SURVEY DIVISION

FLOOD INFORMATION FORM

Division #:	1 <input type="checkbox"/> 2 <input type="checkbox"/> 3 <input type="checkbox"/> 4 <input type="checkbox"/> 5 <input type="checkbox"/> 6 <input type="checkbox"/> 7 <input checked="" type="checkbox"/> 8 <input type="checkbox"/>
County:	COMANCHE
Date Highwater occurred:	04/02/07
Highway Number:	S.H. 281A
Name of Stream:	
Direction and distance from nearest town, or highway junction	Location is approximately 1700 feet east of the Jct. U.S. 277 & S.H. 281A west of Geronimo.
Section, Township, Range:	Section 7, T-1-S, R-12-W, I.M.
Description of Location:	No structure, pond dam just north of highwater crossing.
Highwater Elevation:	1092.4 (Asphalt 1092.3)
Level Datum & Source:	U.S.G.S. Quad Sheet Geronimo (No Plans)
Method used:	Differential Leveling
Date Elevation Obtained:	04/05/07
Apparent Magnitude:	Normal <input type="checkbox"/> Medium <input type="checkbox"/> Extreme <input checked="" type="checkbox"/> Don't Know <input type="checkbox"/>
Was Highwater Mark obtained from actual water, drift, local resident, or other source?	Highwater was obtained from local resident and Geronimo Police Department and drift at this location.
Explanatory Remarks:	

Note: Show Vicinity Map on back of form

Name (signature) \_\_\_\_\_

Name (Printed) Danny R. Dees, PLS

Date: 05/30/07

Survey Division  
Form No. 16  
Revised: 5/09/2007

Loc. No. 18

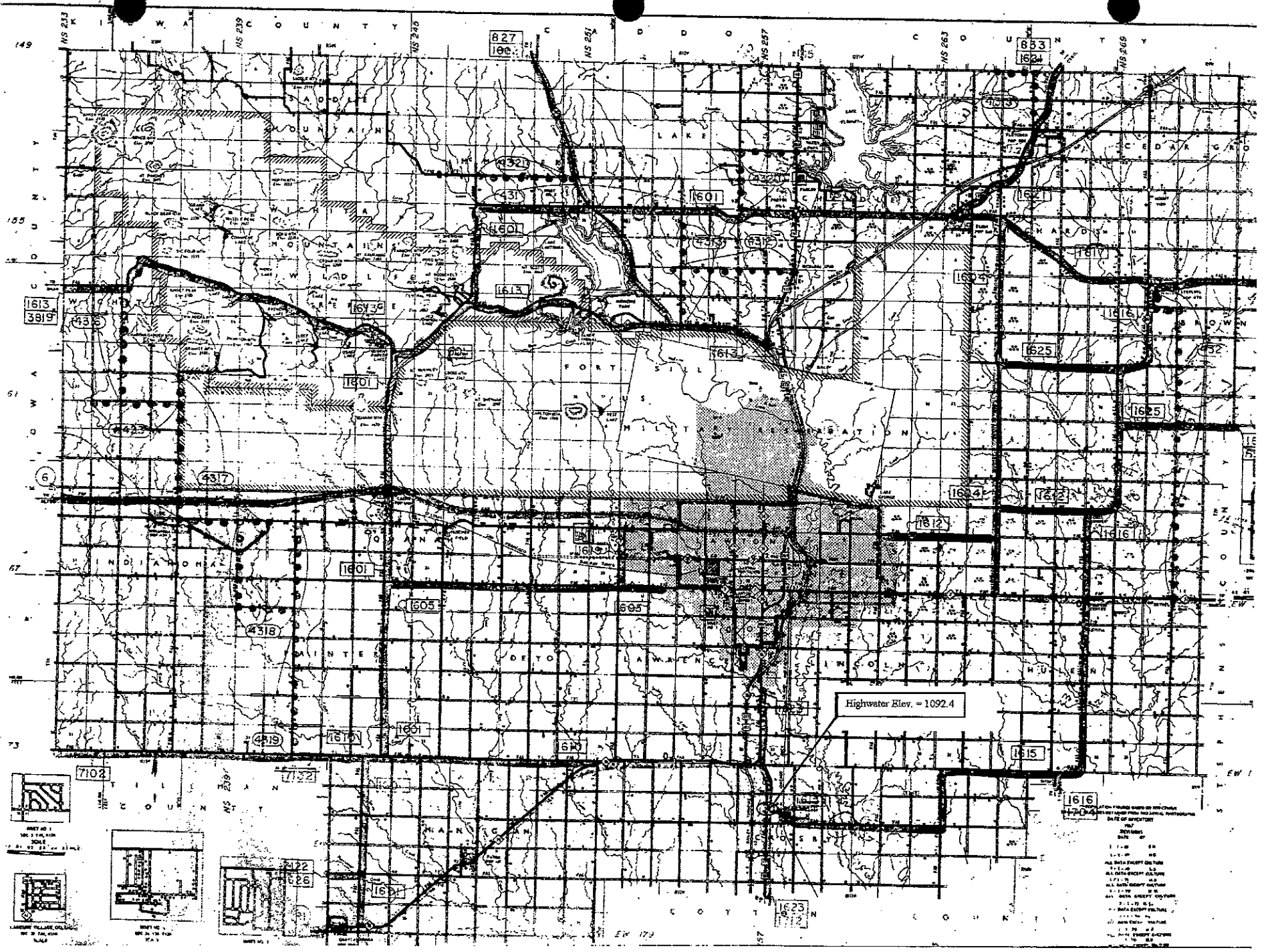

SHEET NO. 1  
 NO. 174, 538  
 2023  
 DATE: 05-12-1960



SHEET NO. 2  
 NO. 174, 538  
 2023  
 DATE: 05-12-1960

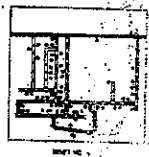

SHEET NO. 3  
 NO. 174, 538  
 2023  
 DATE: 05-12-1960

SHEET NO. 4  
 NO. 174, 538  
 2023  
 DATE: 05-12-1960