

RECEIVED
MAY 5 1953
PLANS & SURVEY
DEPARTMENT

Coal County - Flood Infor.

Plans & Survey Dept.
Form No. 16
Rev. July 10, 1947

STATE OF OKLAHOMA
DEPARTMENT OF HIGHWAYS
PLANS AND SURVEY DEPARTMENT

FLOOD INFORMATION FORM

To be used in obtaining and transmitting flood water elevations for Plans & Survey office record files. This information to be obtained by all Chiefs of Party in their vicinity in times of unusual high water, or at any time available from a reliable source. The elevations can be recorded by level reading, by measurement from bridge floor, in relation to a house, above roadbed or any other dependable, clear manner that fits the situation, the highest order possible to be used. Separate report to be made on each crossing or place obtained.

County Coal Date highwater occurred April 28, 1953

Highway number SH 43 Name of stream None

Direction and distance from nearest town, village or store 1 1/2 miles east of Coalgate

Section, Township and Range Sec. 30 - T 1 N - R 11 E

Description of Location First Creek West of Muddy Boggy. Approx 400'

Method obtained Hand level

Elevation _____ Source of levels Hand level

Was highwater mark obtained from actual water, drift, local resident, U. S. Engineers, etc? Drift, 3' above present bridge floor of Creek.

Explanatory Remarks _____

Location to be shown on back of this sheet as a check.

Field Note: To be sent to Engr. of Plans & Survey (1 copy).
Office Note: To be filed in Flood Information by Counties.

Ray M. Seely
Chief of Party
May 2, 1953
Date



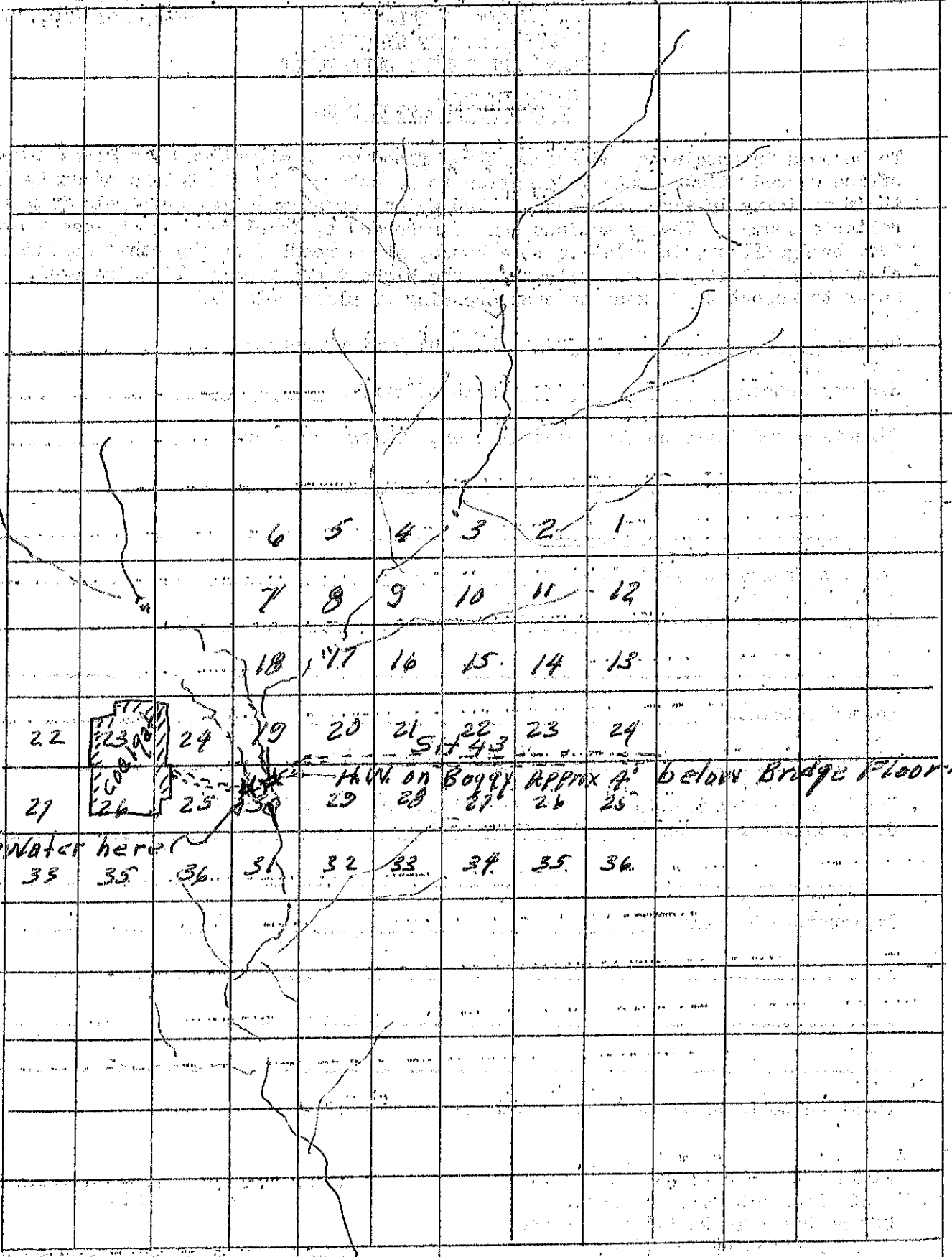

6 5 4 3 2 1
 7 8 9 10 11 12
 18 17 16 15 14 13
 22 23 24 19 20 21 22 23 24
 Sit 43
 H.W. on Boggy approx 4' below Bridge Floor.
 27 26 25 29 28 27 26 25
 33 35 36 31 32 33 34 35 36

High Water here