

STATE OF OKLAHOMA
DEPARTMENT OF HIGHWAYS
SURVEY DIVISION

FLOOD INFORMATION FORM

To be used in obtaining and transmitting flood water elevations for Survey Division office record files. This information to be obtained by all Chiefs of Party or others in their vicinity in times of unusual high water, or at any time available from a reliable source. The elevations can be recorded by level reading, by measurement from bridge floor, in relation to a house, above roadbed or any other dependable, clear manner that fits the situation, the highest order possible to be used. Separate report to be made on each crossing or place obtained.

County COAL Date highwater occurred APRIL 19, 1976.

Highway number OLD SH 3 Name of stream LEADER CREEK

Direction and distance from nearest town, village or store 1.25 MILE EAST OF THE EAST EDGE OF TUPELO OKLAHOMA AT THE CROSSING OF PRESENT SH 3 AND LEADER CREEK.

Section, Township and Range SEC. 31, T2N, R9E.

Description of Location LOCATED AT STA. #626+12.92 OF SAP 540-B PLANS, IN THE NE 1/4, SEC. 31, T2N, R9E.

Elevation 625.7 Source of levels SAP 540-B PLANS.

Method obtained ENGINEERING Y-LEVEL Date obtained APRIL 19, 1976.

Did it appear to be normal medium extreme do not know

Was highwater mark obtained from actual water, drift, local resident, U. S. Engineers, etc.? ELEVATION AS SHOWN WAS TAKEN BY AVERAGEING 5 VISIBLE HIGHWATER

MARKS.

Explanatory Remarks PLANS SAP 540-B HIGHWATER ELEV. = 625.0.
ALL SHOTS WERE TAKEN NEAR THE BRIDGE.

Location to be shown on back of this sheet as a check.

Field Note: To be sent to
Survey Engineer

Bobby Earl Garland
Chief of Party

APRIL 29, 1976.
Date

Location No. 2

R9E

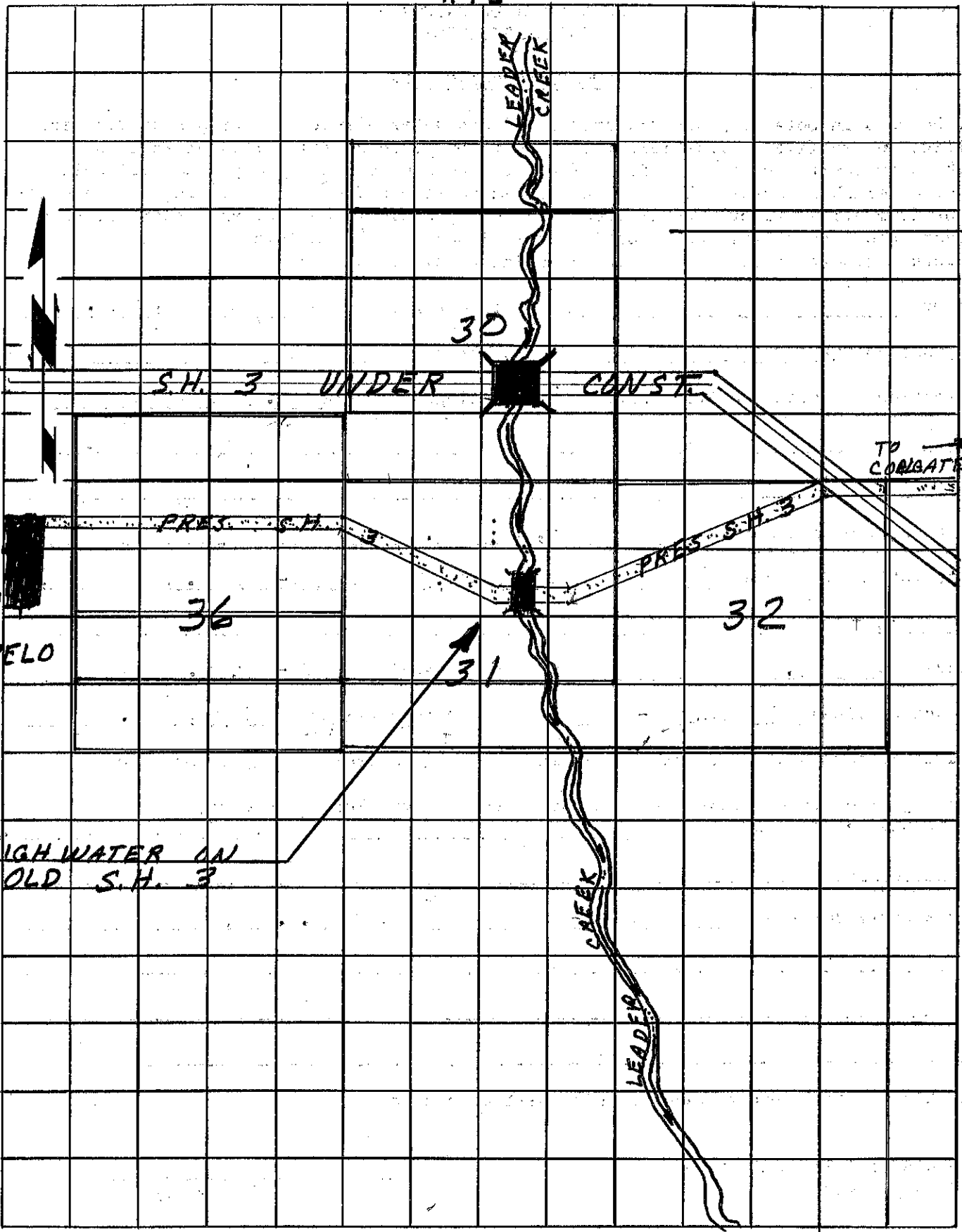

LEADER CREEK

30

S.H. 3 UNDER CONST

TO CORGATE T 2 N

PRES. S.H. 3

PRES. S.H. 3

36

32

31

TEUPELO

HIGH WATER ON OLD S.H. 3

CREEK

LEADER