

SURVEY DIVISION

WWV  
 RLS 11-3-70  
 GWP  
 ✓ OCC 11/4/70  
 ROC  
 GP  
 SDD  
 RDA  
 DP  
 IF

STATE OF OKLAHOMA  
 DEPARTMENT OF HIGHWAYS  
 SURVEY DIVISION

Survey Division  
 Form No. 16  
 Rev. Sept. 10, 1961  
 RECEIVED  
 NOV 8 1970  
 SURVEY DIVISION

FLOOD INFORMATION FORM

To be used in obtaining and transmitting flood water elevations for Survey Division office record files. This information to be obtained by all Chiefs of Party or others in their vicinity in times of unusual high water, or at any time available from a reliable source. The elevations can be recorded by level reading, by measurement from bridge floor, in relation to a house, above roadbed or any other dependable, clear manner that fits the situation, the highest order possible to be used. Separate report to be made on each crossing or place obtained.

County Coal Date highwater occurred Oct. 8, 1970

Highway number US. 75 & SH. 3 Name of stream Caney Creek

Direction and distance from nearest town, village or store At north edge of

Coalgate

Section, Township and Range \_\_\_\_\_

Description of Location On bridge floor at south end of Caney creek bridge on center of floor at south end

Elevation 2.0 lower than floor Source of levels \_\_\_\_\_

Method obtained Hand Level Date obtained Oct. 9, 1970

Did it appear to be  normal  medium  extreme  do not know

Was highwater mark obtained from actual water, drift, local resident, U. S. Engineers, etc.? Highwater was determined by Drift, Silt deposit and

Mud line on bridge which was very plain.

Explanatory Remarks Water was Approx. 2 Ft. over SH. 3 & US. 75 south and north of Caney creek bridge this highwater was caused from a 9" rain over an 8 hour period

Location to be shown on back of this sheet as a check.

Field Note: To be sent to  
 Survey Engineer

FILE - FLOOD FILE COAL Co.  
 MC: BRIDGE DIV.

Ray N. Seeley *Ray N. Seeley*  
 Location Engineer

10-9-70

Date

LOC. NO. 3

R-10-E

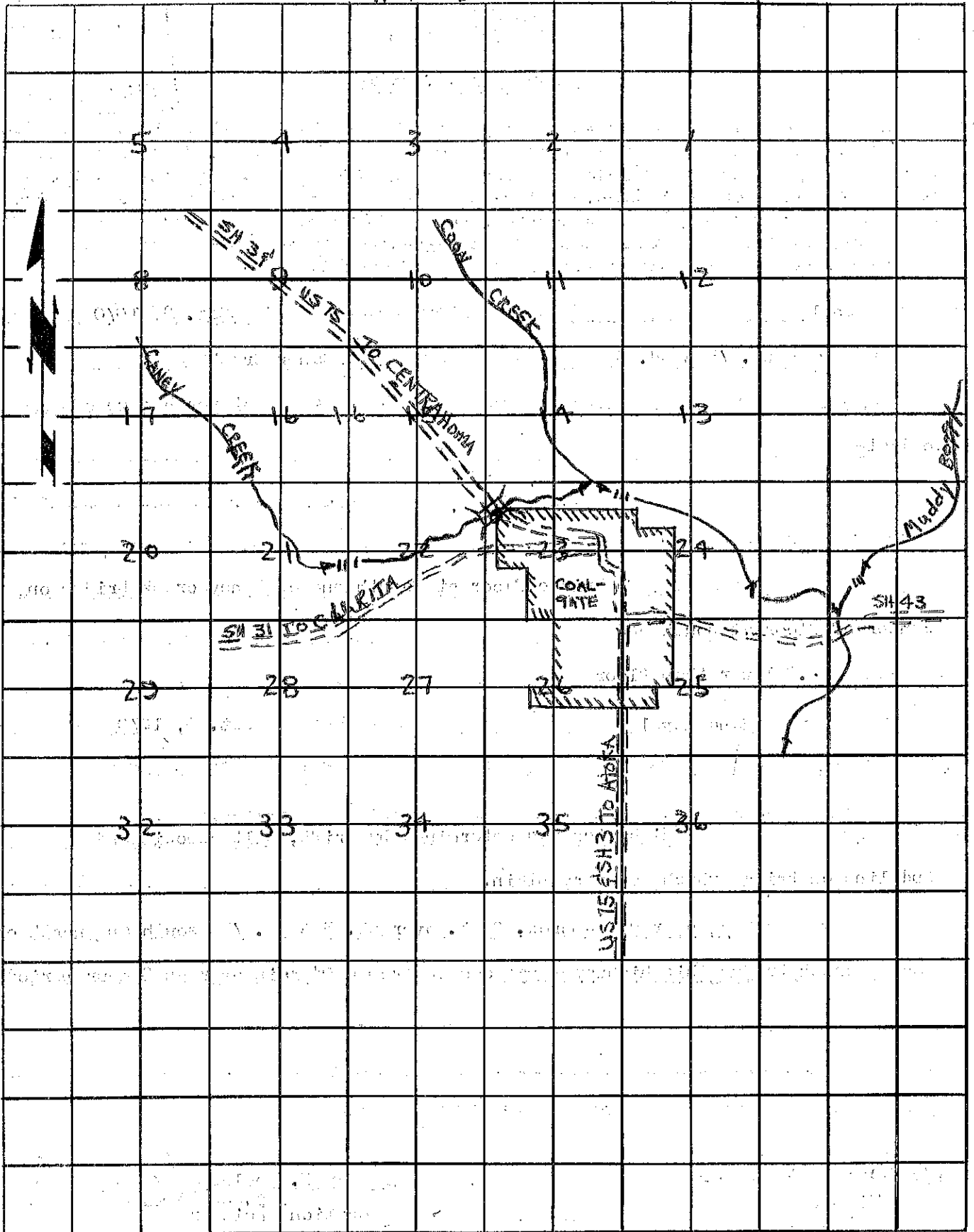

R-10-E