

STATE OF OKLAHOMA
DEPARTMENT OF HIGHWAYS
SURVEY DIVISION

FLOOD INFORMATION FORM

To be used in obtaining and transmitting flood water elevations for Survey Division office record files. This information to be obtained by all Chiefs of Party or others in their vicinity in times of unusual high water, or at any time available from a reliable source. The elevations can be recorded by level reading, by measurement from bridge floor, in relation to a house, above roadbed or any other dependable, clear manner that fits the situation, the highest order possible to be used. Separate report to be made on each crossing or place obtained.

County COAL Date highwater occurred 10-13-81

Highway number SH, 75 Name of stream ROCK CREEK

Direction and distance from nearest town, village or store _____

APPROX. 9.5 MILES NORTH OF COALGATE

Section, Township and Range SEC. #5 T-2-N R-10-E

Description of Location STA. 56.5 ± 15.25 AND BRIDGE F.A.P. S-250 [2]

PLANS

Elevation 631.1 Source of levels F.A.P. S-250 [2] PLANS

Method obtained HAND LEVEL AND LEVEL ROD Date obtained 10-15-81

Did it appear to be normal medium extreme do not know

Was highwater mark obtained from actual water, drift, local resident, U. S. Engineers, etc.? DRIFT

Explanatory Remarks HEAVY RAIN IN UPPER DRAINAGE AREA

RECEIVED
NOV 16 1981
SURVEY DIVISION

Location to be shown on back of this sheet as a check.

Field Note: To be sent to
Survey Engineer

O. D. ...
Loc. Eng. Chief of Party
NOV. 10, 1981
Date

Location No. 20

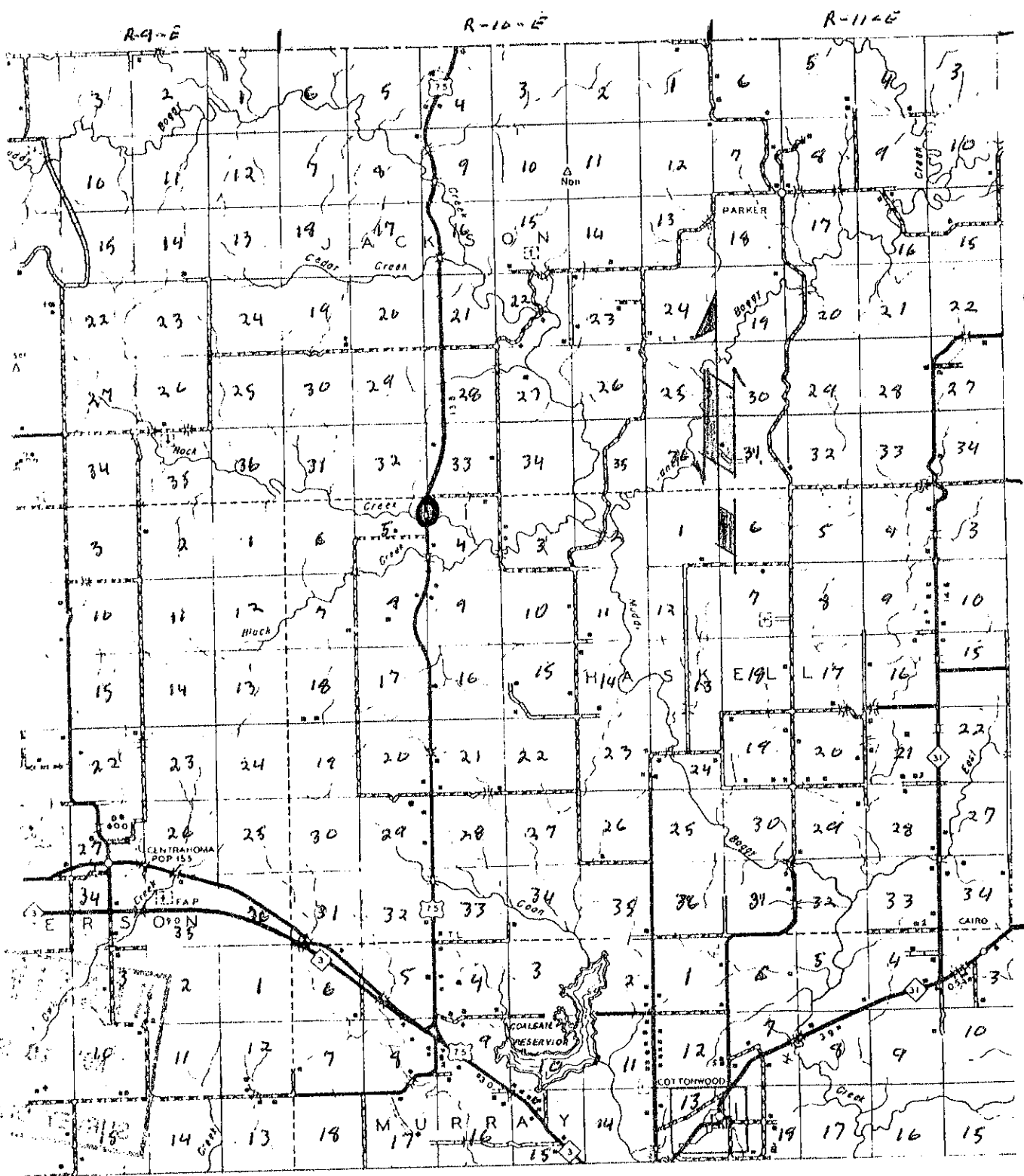

R-9-E

R-10-E

R-11-E

T-3-N

T-2-N

T-1-N

