

STATE OF OKLAHOMA  
DEPARTMENT OF HIGHWAYS  
SURVEY DIVISION

FLOOD INFORMATION FORM

To be used in obtaining and transmitting flood water elevations for Survey Division office record files. This information to be obtained by all Chiefs of Party or others in their vicinity in times of unusual high water, or at any time available from a reliable source. The elevations can be recorded by level reading, by measurement from bridge floor, in relation to a house, above roadbed or any other dependable, clear manner that fits the situation, the highest order possible to be used. Separate report to be made on each crossing or place obtained.

County Cleveland Date highwater occurred September 22, 1970

Highway number 74 A Name of stream Imhoff Creek

Direction and distance from nearest town, village or store \_\_\_\_\_  
In Norman, Oklahoma

Section, Township and Range 31, T9N, R2W

Description of Location 675' east and 65' north of Intersection of Berry Road and Lindsay Street. 65' left Sta. 159 + 55 on SWO 2837 (1)

Elevation 1136.1 Source of levels U.S.C.&G.S.

Method obtained Engineer's Level Date obtained Sept. 23, 1970

Did it appear to be  normal  medium  extreme  do not know

Was highwater mark obtained from actual water, drift, local resident, U. S. Engineers, etc.? Drift and water mark

Explanatory Remarks Occured during 8" rain over a 10 hour period

Location to be shown on back of this sheet as a check.

Field Note: To be sent to  
Survey Engineer

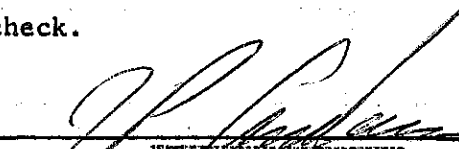
  
~~XXXXXXXXXXXX~~  
Location Engineer  
September 23, 1970  
Date

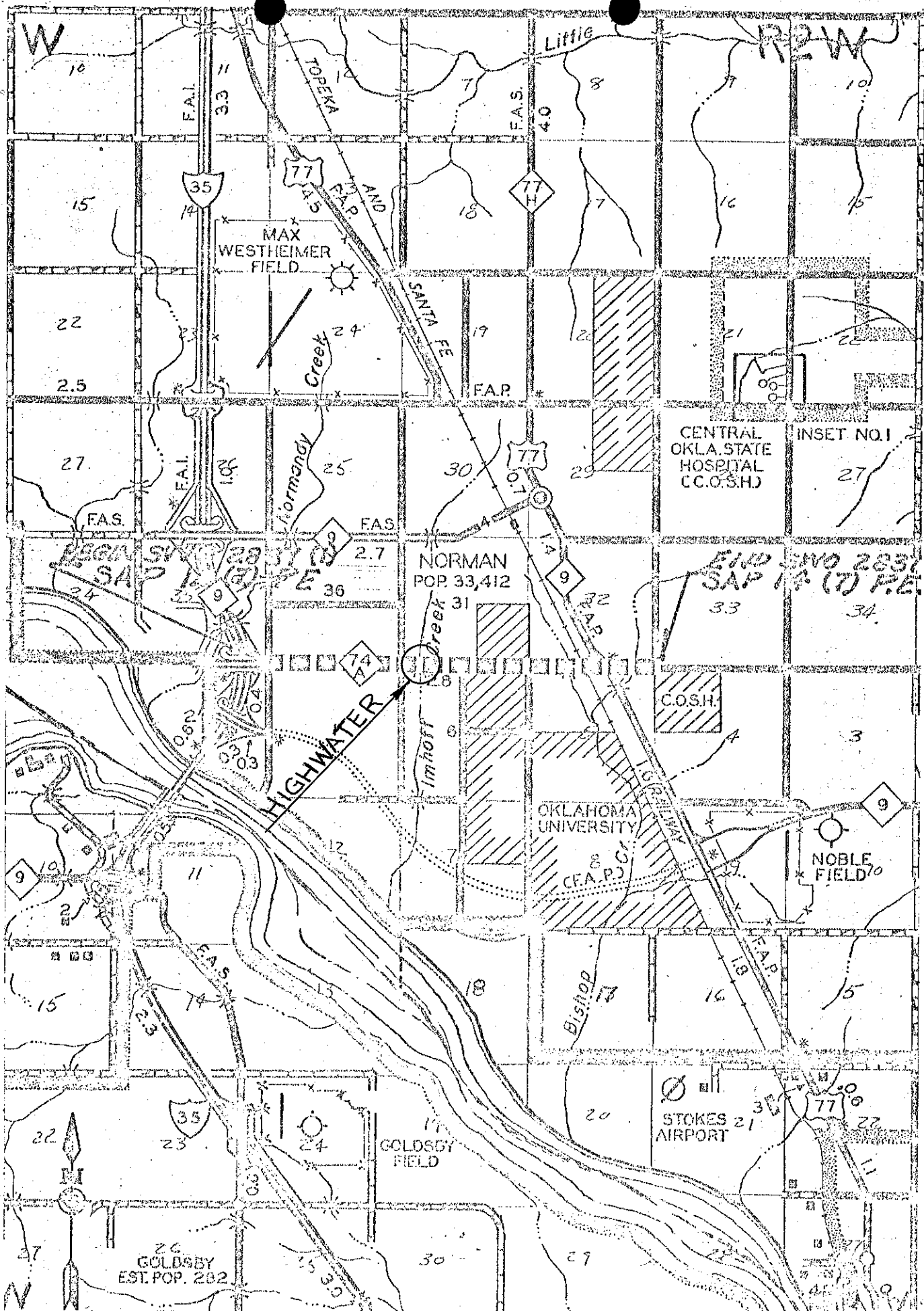

W

R2W

35

77

MAX WESTHEIMER FIELD

CENTRAL OKLA. STATE HOSPITAL (C.O.S.H.)

INSET NO. 1

NORMAN POP. 33,412

END S.W. 2831 SAP 14 (7) P.E.

HIGHWAY

OKLAHOMA UNIVERSITY

NOBLE FIELD

STOKES AIRPORT

GOLDSBY FIELD

26 GOLDSBY EST. POP. 282

