

RECEIVED  
OCT 5 1970  
SURVEY DIVISION

Survey Division  
Form No. 16  
Rev. Sept. 10, 1961

STATE OF OKLAHOMA  
DEPARTMENT OF HIGHWAYS  
SURVEY DIVISION

FLOOD INFORMATION FORM

To be used in obtaining and transmitting flood water elevations for Survey Division office record files. This information to be obtained by all Chiefs of Party or others in their vicinity in times of unusual high water, or at any time available from a reliable source. The elevations can be recorded by level reading, by measurement from bridge floor, in relation to a house, above roadbed or any other dependable, clear manner that fits the situation, the highest order possible to be used. Separate report to be made on each crossing or place obtained.

County Cleveland Date highwater occurred September 22, 1970

Highway number 74 A Name of stream \_\_\_\_\_

Direction and distance from nearest town, village or store \_\_\_\_\_

In Norman, Oklahoma

Section, Township and Range 1, T8N, R3W

Description of Location 410' west and 46' south of Intersection of Wylie Road and Lindsay Street.  
46' right Sta. 135 + 50 on SWO 2837 (1)

Elevation 1149.4 Source of levels U.S.C. & G.S.

Method obtained Engineer's Level Date obtained Sept. 23, 1970

Did it appear to be  normal  medium  extreme  do not know

Was highwater mark obtained from actual water, drift, local resident, U. S. Engineers, etc.? Drift and Water Mark

Explanatory Remarks Occured during 8" rain over a 10 hour period.

Location to be shown on back of this sheet as a check.

Field Note: To be sent to  
Survey Engineer

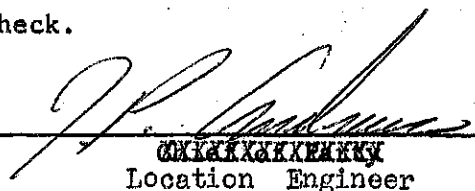
  
~~XXXXXXXXXXXX~~  
Location Engineer  
September 23, 1970  
Date

FILE: CLEVELAND CO. FLOOD & HIGHWATER  
MC: BRIDGE DIV. 10-6-70

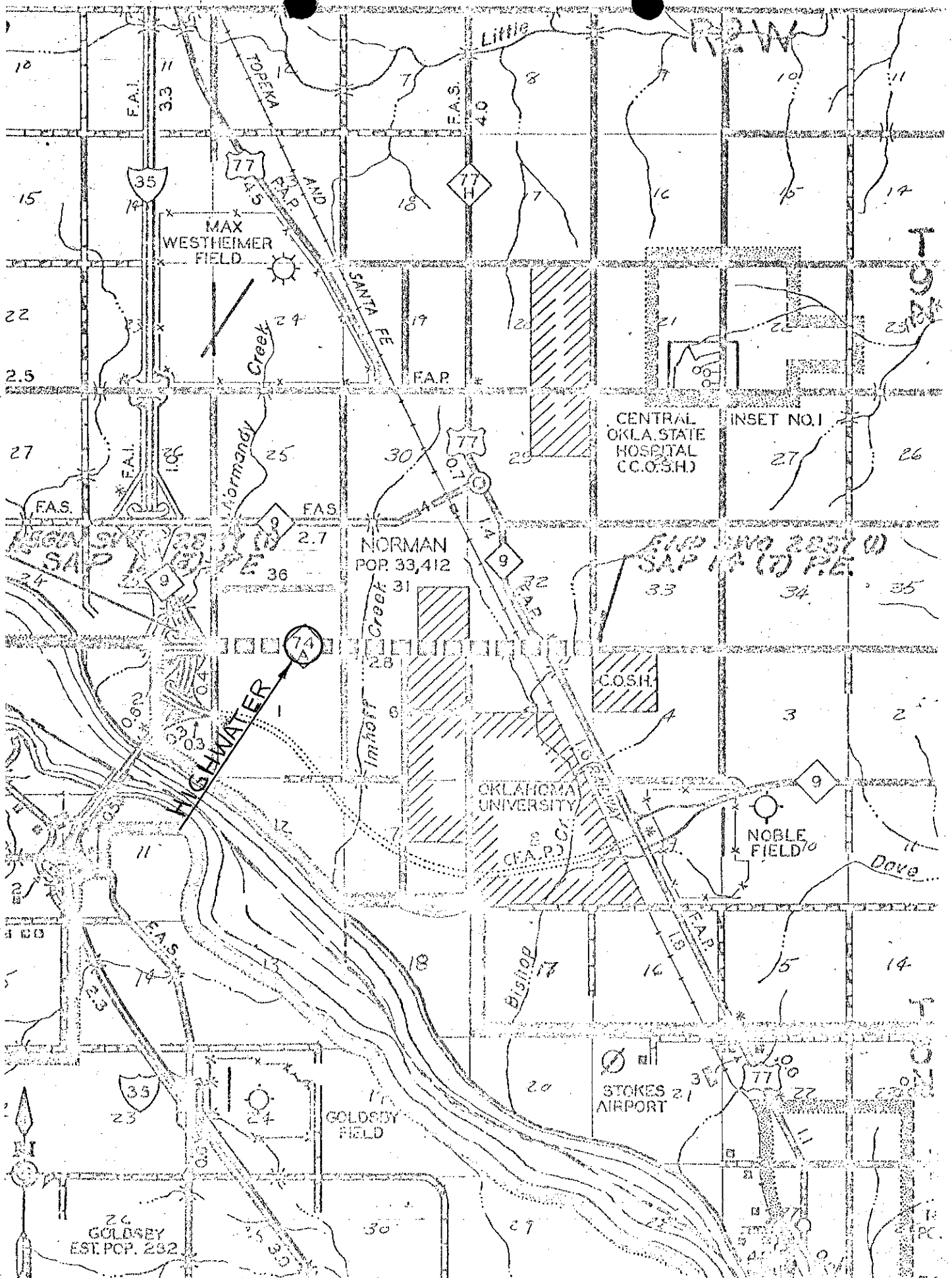

MAX WESTHEIMER FIELD

CENTRAL OKLA. STATE HOSPITAL  
C.C.O.S.H.

NORMAN  
POP. 33,412

OKLAHOMA UNIVERSITY

NOBLE FIELD

STOKES AIRPORT

GOLDSBY FIELD

26 GOLDSBY  
EST. POP. 232

SAP 12 (D) P.E.  
SAP 12 (D) P.E.

INSET NO. 1

HIGHWAY 74

ARMANDY CREEK

IMHOFF CREEK

BISHOP CREEK

TOPEKA CREEK

LITTLE CREEK

DOVE CREEK

35

77

77

77

74

35

77

10

15

22

25

27

27

36

28

12

30

23

18

19

30

31

9

7

8

10

20

29

8

7

20

29

9

6

17

16

21

22

16

21

25

33

3

15

16

35

27

10

15

22

27

34

3

15

15

27

27

14

23

26

35

2

11

14

21

22

TOPEKA

TON

PC