

STATE OF OKLAHOMA
DEPARTMENT OF HIGHWAYS
SURVEY DIVISION

FLOOD INFORMATION FORM

To be used in obtaining and transmitting flood water elevations for Survey Division office record files. This information to be obtained by all Chiefs of Party or others in their vicinity in times of unusual high water, or at any time available from a reliable source. The elevations can be recorded by level reading, by measurement from bridge floor, in relation to a house, above roadbed or any other dependable, clear manner that fits the situation, the highest order possible to be used. Separate report to be made on each crossing or place obtained.

County CLEVELAND Date highwater occurred 3-28-88

Highway number S.H. 37 Name of stream DRAIN AT STA. 273+52

Direction and distance from nearest town, village or store 1.2 MILES WEST OF WEST CITY LIMITS OF MOORE, WHICH IS THE JCT. OF SW 4TH ST & SANTA FE AVE., IN MOORE, OKLAHOMA.

Section, Township and Range SECTIONS 17 & 20, T 10 N, R 3 W

Description of Location DRAIN IS LOCATED AT STA. 273+52 OF S.W.O. 3364(1) SURVEY ON S.H. 37.

Elevation 1191.0 Source of levels U.S.C. & G.S.

Method obtained ENGINEERS LEVEL Date obtained MARCH 29, 1988

Did it appear to be normal medium extreme do not know

Was highwater mark obtained from actual water, drift, local resident, U. S. Engineers, etc.? DRIFT IN NUMBER OF LOCATIONS

Explanatory Remarks THIS HIGHWATER WAS 1.8 HIGHER THAN WATER WAS IN 1980. THIS WOULD PUT WATER OVER ROAD FROM APPROX. STA. 272+22 TO STA. 279+38 OF S.W.O 3364(1) SURVEY.

Location to be shown on back of this sheet as a check.

Field Note: To be sent to
Survey Engineer

Gary Lynn Payne
~~XXXXXXXXXXXX~~
PROF. LAND SURVEYOR
APRIL 6, 1988
Date

LOCATION No. 13

APR 13 1988

R-4-W

OKLAHOMA CO.

R-3-W

CLEVELAND CO.

SWO 3364 (1)
JOB 00071 (13)

RANCHWOOD
MANOR
EST POP 248

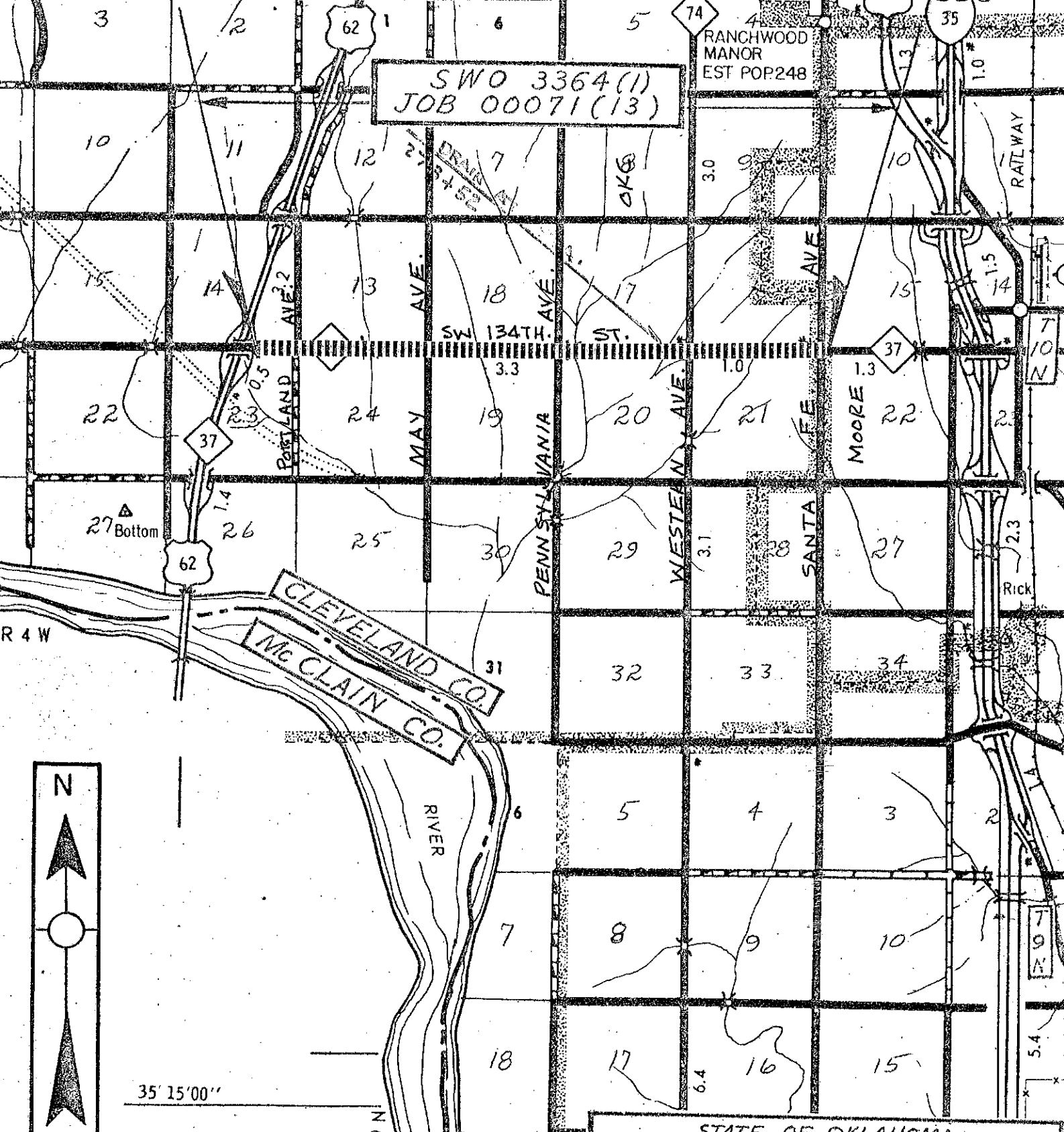

35' 15' 00"



STATE OF OKLAHOMA
 DEPARTMENT OF TRANSPORTATION
 SURVEY DIVISION
 SWO 3364 (1) JOB 00071 (13)
 SH 37
 CLEVELAND CO.