

STATE OF OKLAHOMA  
DEPARTMENT OF HIGHWAYS  
SURVEY DIVISION

FLOOD INFORMATION FORM

To be used in obtaining and transmitting flood water elevations for Survey Division office record files. This information to be obtained by all Chiefs of Party or others in their vicinity in times of unusual high water, or at any time available from a reliable source. The elevations can be recorded by level reading, by measurement from bridge floor, in relation to a house, above roadbed or any other dependable, clear manner that fits the situation, the highest order possible to be used. Separate report to be made on each crossing or place obtained.

County Choctaw Date highwater occurred Feb. 10, 1966

Highway number US 70 Name of stream Boggy Creek

Direction and distance from nearest town, village or store 3 miles west of Soper, Okla.

Section, Township and Range Sec. 20 T6S R15E

Description of Location High Water obtained at west end of Pres. Boggy Creek bridge just south of Survey.

Elevation See Remarks Source of levels \_\_\_\_\_

Method obtained With Level Date obtained Feb. 18, 1966

Did it appear to be  normal  medium  extreme  do not know

Was highwater mark obtained from actual water, drift, local resident, U. S. Engineers, etc.? Actual Water

Explanatory Remarks High Water 18.0' lower than bridge floor at west end of Pres. Boggy Creek Bridge.

SUR. DIV.	
CHS.	
✓	2-25-66
IN USE	
STG.	
OFF	
REF	

Location to be shown on back of this sheet as a check.

Field Note: To be sent to  
Survey Engineer

RECEIVED  
FEB 22 1966  
SURVEY DIVISION

*Loy M. Decker*  
Location Engineer  
Feb. 21, 1966  
Date

Location No. 1

1000 1000 1000  
1000 1000 1000  
1000 1000 1000

# RISE

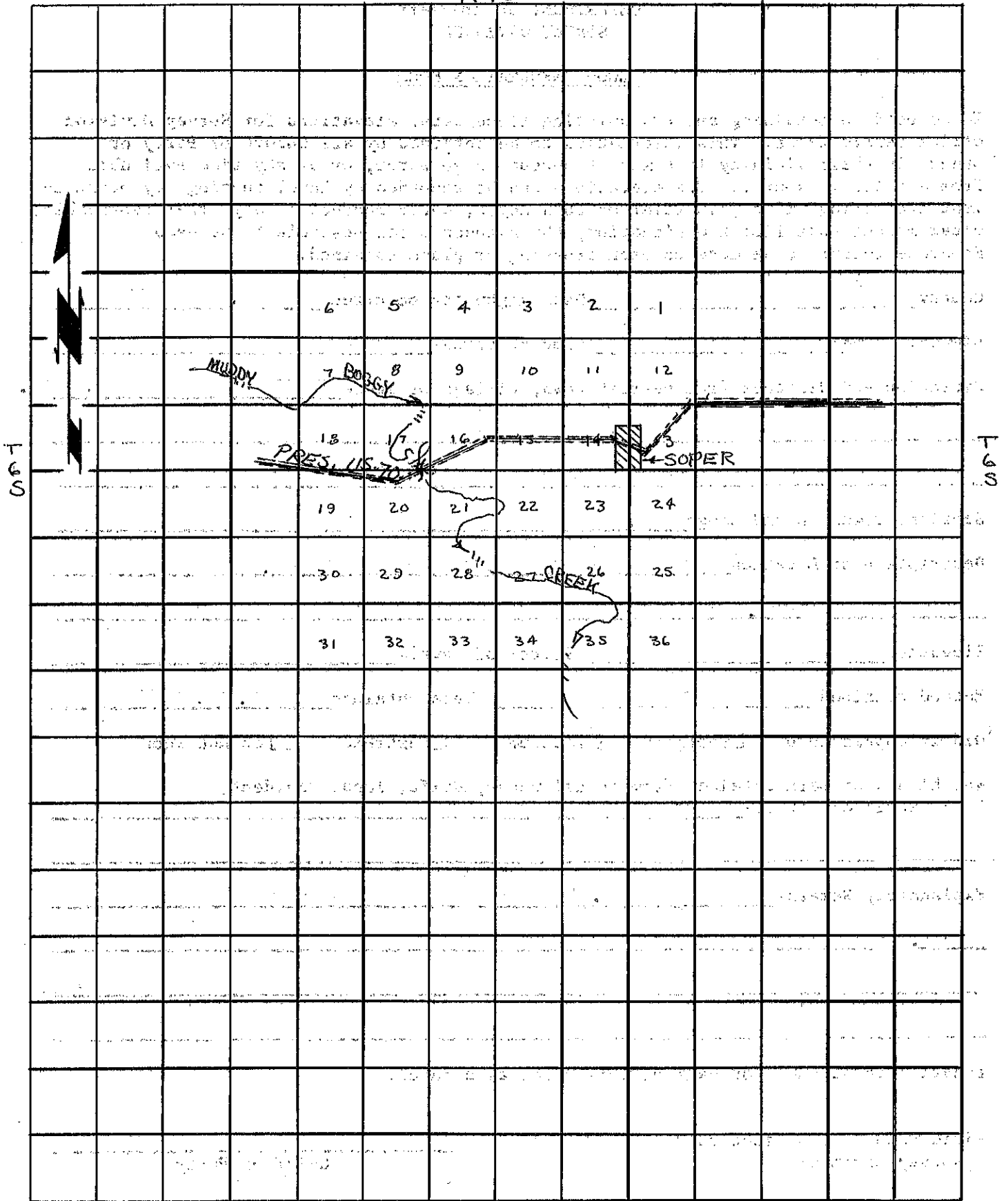

# RISE