

STATE OF OKLAHOMA  
DEPARTMENT OF HIGHWAYS  
SURVEY DIVISION

Survey Division  
Form No. 16  
Rev. Sept. 10, 1961

FLOOD INFORMATION FORM

To be used in obtaining and transmitting flood water elevations for Survey Division office record files. This information to be obtained by all Chiefs of Party or others in their vicinity in times of unusual high water, or at any time available from a reliable source. The elevations can be recorded by level reading, by measurement from bridge floor, in relation to a house, above roadbed or any other dependable, clear manner that fits the situation, the highest order possible to be used. Separate report to be made on each crossing or place obtained.

County Cherokee Date highwater occurred 11/24/73

Highway number S.H.10 Name of stream No Name

Direction and distance from nearest town, village or store 1.8 miles south of  
Hanging Rock Camp.

Section, Township and Range Section 12 T-18-N R-23-E

Description of Location South 15.5 miles from Jct. of S.H.10 & S.H.33 at  
Little Kansas Okla.

Elevation \_\_\_\_\_ Source of levels \_\_\_\_\_

Method obtained \_\_\_\_\_ Date obtained 11/26/73

Did it appear to be  normal  medium  extreme  do not know

Was highwater mark obtained from actual water, drift, local resident,  
U. S. Engineers, etc.? Obtained from drift & local resident

Explanatory Remarks Highwater in this area was 3.0' over the center line  
of the road. A stretch of road approx. 400' long was under water.

Location to be shown on back of this sheet as a check.

Field Note: To be sent to  
Survey Engineer

Jerry Wayne Haynes  
Chief of Party  
Location Engineer  
1/1/74  
Date

Loc. No. 6

R-23-E

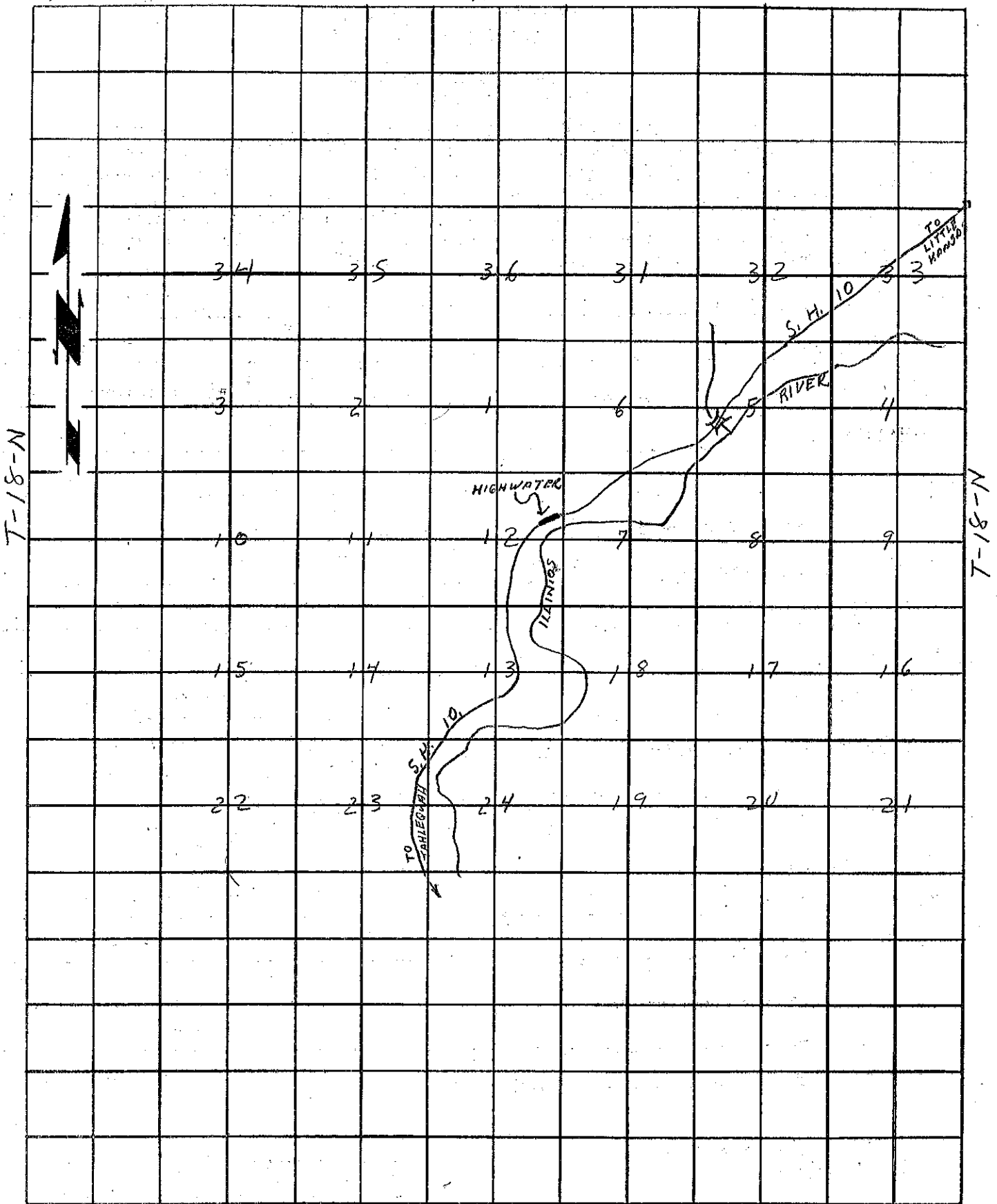

T-18-N

T-18-N

R-23-E