

STATE OF OKLAHOMA  
DEPARTMENT OF HIGHWAYS  
SURVEY DIVISION

Survey Division  
Form No. 16  
Rev. Sept. 10, 1961

FLOOD INFORMATION FORM

To be used in obtaining and transmitting flood water elevations for Survey Division office record files. This information to be obtained by all Chiefs of Party or others in their vicinity in times of unusual high water, or at any time available from a reliable source. The elevations can be recorded by level reading, by measurement from bridge floor, in relation to a house, above roadbed or any other dependable, clear manner that fits the situation, the highest order possible to be used. Separate report to be made on each crossing or place obtained.

County CHEROKEE Date highwater occurred NOVEMBER 24, 1973

Highway number S.H. 80 Name of stream LARGE DRAIN

Direction and distance from nearest town, village or store APPROX. 1 MILE S.W.  
OF HULBERT.

Section, Township and Range SEC. 27, T-16-N, R-20-E

Description of Location Drain is located approx 500' west of the east side of Sec. 27,  
T-16-N, R-20-E. & on E of S.H. 80.

Elevation \_\_\_\_\_ Source of levels \_\_\_\_\_

Method obtained \_\_\_\_\_ Date obtained November 26, 1973

Did it appear to be  normal  medium  extreme  do not know

Was highwater mark obtained from actual water, drift, local resident,  
U. S. Engineers, etc.? Drifts

Explanatory Remarks Highwater Elev. is 0.6' down from elev. at Sta. 100+00 on  
SWO 3169(1)-Cherokee County

Location to be shown on back of this sheet as a check.

Field Note: To be sent to  
Survey Engineer

Jerry Wayne Hagner  
~~XXXXXXXXXXXX~~  
LOCATION ENGINEER  
December 3, 1973  
Date

Loc. No. 10

R-20-E

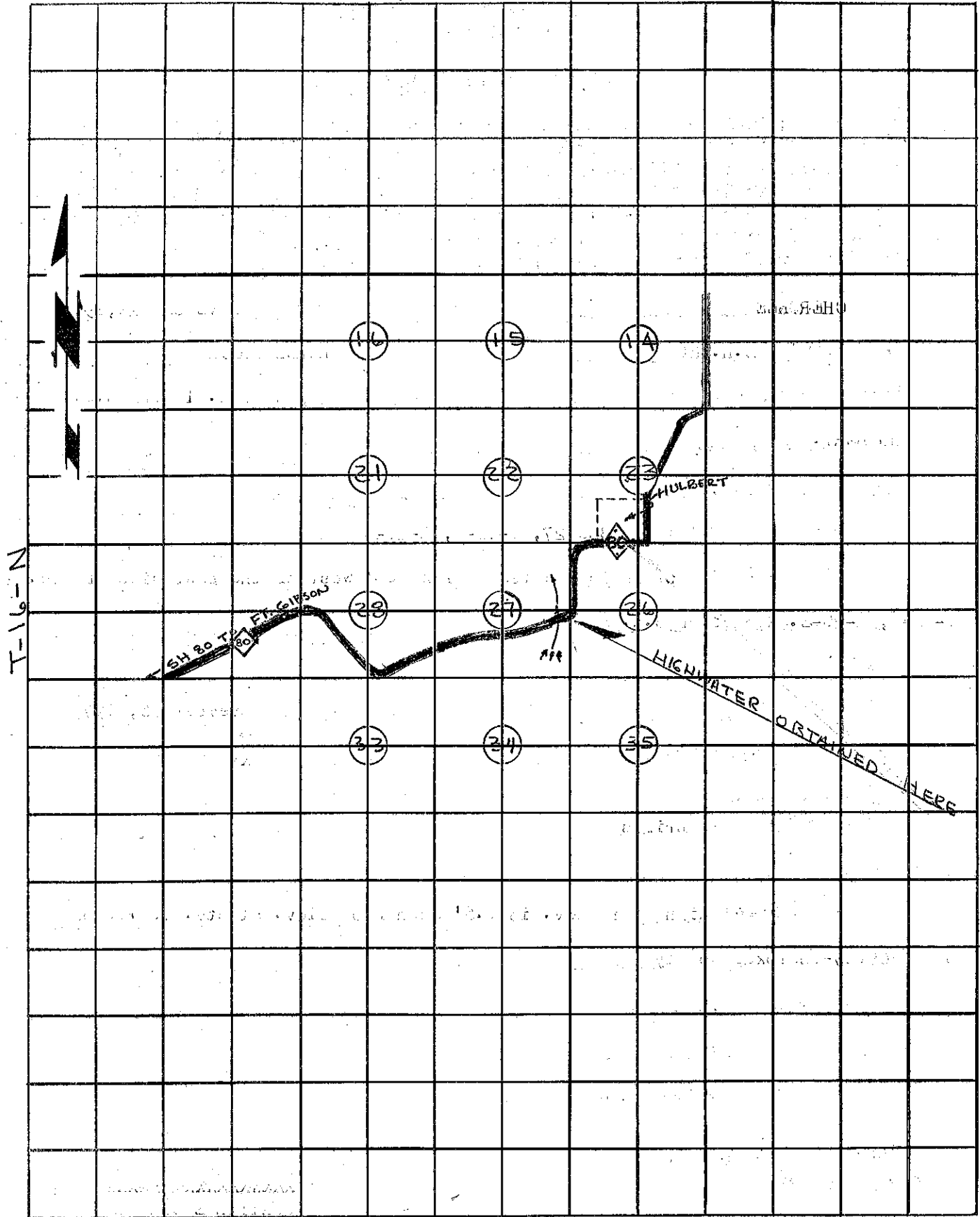

R-20-E