

STATE OF OKLAHOMA
DEPARTMENT OF HIGHWAYS
SURVEY DIVISION

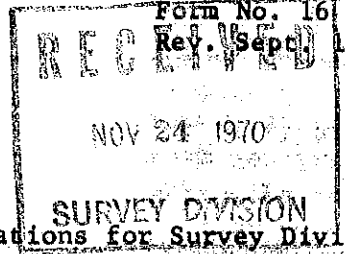

FLOOD INFORMATION FORM

To be used in obtaining and transmitting flood water elevations for Survey Division office record files. This information to be obtained by all Chiefs of Party or others in their vicinity in times of unusual high water, or at any time available from a reliable source. The elevations can be recorded by level reading, by measurement from bridge floor, in relation to a house, above roadbed or any other dependable, clear manner that fits the situation, the highest order possible to be used. Separate report to be made on each crossing or place obtained.

County Carter Date highwater occurred September 22, 1970

Highway number S.H. 76 Name of stream _____

Direction and distance from nearest town, village or store Approx. 1 3/4 mile north of Healdton, Oklahoma or Approx. 1200' south of Section Corner common to Sections 26, 27, 34 & 35, T3S, R3W.

Section, Township and Range Section 35, T3S, R3W.

Description of Location At the Double 10' x 5' R.C.B. on S.H. 76 Approx. 1 3/4 mile North of Healdton, Oklahoma.

Elevation 905.62 Source of levels USC&GS from SWO 2126 (1)

Method obtained Engineer's Level Date obtained November 9, 1970

Did it appear to be normal medium extreme do not know

Was highwater mark obtained from actual water, drift, local resident, U. S. Engineers, etc.? Local Residents - Mrs. Ida England Box 659 Healdton, Okla. and Mr. James Ratcliffe Box 613 Healdton, Oklahoma

Explanatory Remarks This Highwater occurred from an 8" rain over a period of Approx. 4 hours on September 22, 1970. This information recorded in the Healdton Herald Newspaper on September 24, 1970.

Location to be shown on back of this sheet as a check.

Field Note: To be sent to Survey Engineer
FILE: CARTER Co. FLOOD FILE.

[Signature]
~~XXXXXXXXXXXX~~
Location Engineer
November 10, 1970
Date

MC: BRIDGE DIV.

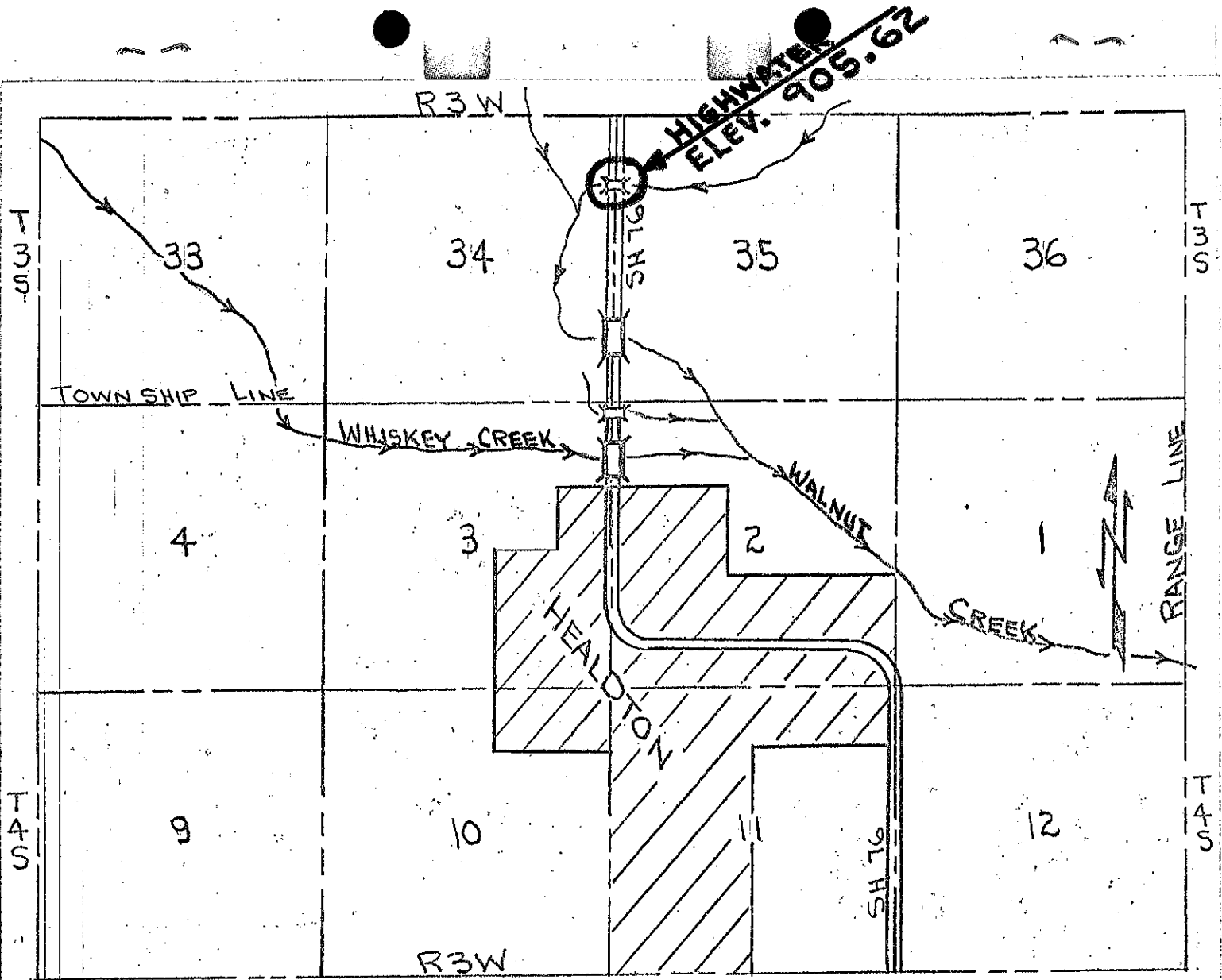

SIDE VIEW DOUBLE 10'X5' R.C.B.

