

STATE OF OKLAHOMA
DEPARTMENT OF HIGHWAYS
SURVEY DIVISION

FLOOD INFORMATION FORM

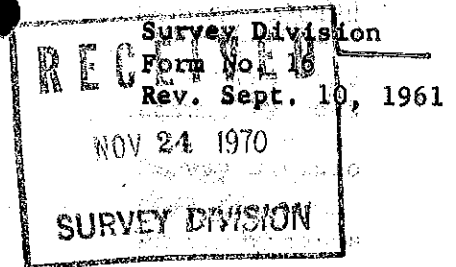

To be used in obtaining and transmitting flood water elevations for Survey Division office record files. This information to be obtained by all Chiefs of Party or others in their vicinity in times of unusual high water, or at any time available from a reliable source. The elevations can be recorded by level reading, by measurement from bridge floor, in relation to a house, above roadbed or any other dependable, clear manner that fits the situation, the highest order possible to be used. Separate report to be made on each crossing or place obtained.

County Carter Date highwater occurred September 22, 1970
Highway number S.H. 76 Name of stream Whiskey Creek
Direction and distance from nearest town, village or store North edge of Healdton
Oklahoma or Approx. 1900' south of the Section Corner Common to Sections 2&3, T4S, R3W
and Sections 34&35, T3S, R3W.
Section, Township and Range Section 3, T4S, R3W
Description of Location Water Mark on Bill Bradey's Machine Shop Approx. 350 feet
Northwest of the Intersection of S.H. 76 and Whiskey Creek.
Elevation 896.07 Source of levels USC&GS From SWO 2126 (1)
Method obtained Engineer's Level Date obtained November 9, 1970
Did it appear to be normal medium extreme do not know
Was highwater mark obtained from actual water, drift, local resident,
U. S. Engineers, etc.? Water Mark on Sheet Metal Bldg. and confirmed by Employees
of Meister Plastic Coating Company.
Explanatory Remarks This Highwater occurred from an 8" rain over a period of Approx.
4 hours on September 22, 1970. This information recorded in the Healdton Herald
Newspaper on September 24, 1970.

Location to be shown on back of this sheet as a check.

Field Note: To be sent to
Survey Engineer

FILE! CARTER CO. FLOOD
FILE

MC: BRIDGE DIV.

[Signature]
Chris Cook Party

Location Engineer

November 10, 1970

Date

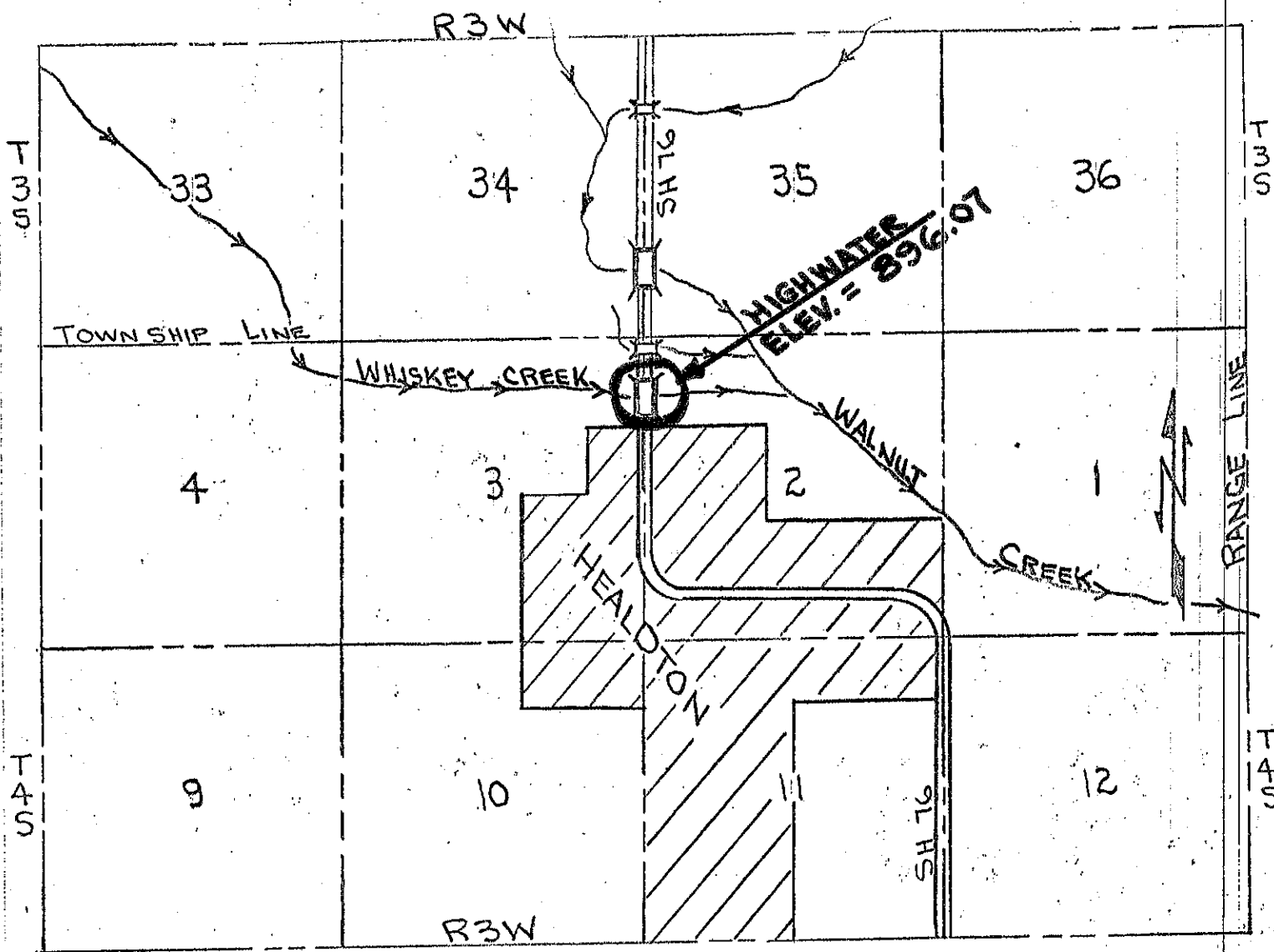

SIDE VIEW 24' X 120' CONC. BRIDGE

