

STATE OF OKLAHOMA  
DEPARTMENT OF HIGHWAYS  
SURVEY DIVISION

Survey Division  
Form No. 16  
Rev. Sept. 10, 1961  
NOV 24 1970  
SURVEY DIVISION

FLOOD INFORMATION FORM

To be used in obtaining and transmitting flood water elevations for Survey Division office record files. This information to be obtained by all Chiefs of Party or others in their vicinity in times of unusual high water, or at any time available from a reliable source. The elevations can be recorded by level reading, by measurement from bridge floor, in relation to a house, above roadbed or any other dependable, clear manner that fits the situation, the highest order possible to be used. Separate report to be made on each crossing or place obtained.

County Carter Date highwater occurred September 22, 1970

Highway number S.H. 76 Name of stream WALNUT CREEK

Direction and distance from nearest town, village or store Approx. 1 1/2 mile north of Healdton, Oklahoma or Approx. 600' north of the Section Corner Common to Sections 2&3, T4S, R3W and Sections 34&35, T3S, R3W.

Section, Township and Range Section 34, T3S, R3W.

Description of Location At a 24' x 110' Conc. Bridge on S.H. 76 Approx. 1 1/2 mile north of Healdton, Oklahoma.

Elevation 898.97 Source of levels USC&GS From SWO 2126 (1)

Method obtained Engineer's Level Date obtained November 9, 1970

Did it appear to be  normal  medium  extreme  do not know

Was highwater mark obtained from actual water, drift, local resident, U. S. Engineers, etc.? Local Residents - Mr. Kenneth Long Box 367, Healdton, Okla. and Mr. Gilbert Phillips 36 Ruth Street, Healdton, Oklahoma.

Explanatory Remarks This Highwater occurred from an 8" rain over a period of Approx. 4 Hours on September 22, 1970. This information recorded in the Healdton Herald Newspaper on September 24, 1970.

Location to be shown on back of this sheet as a check.

Field Note: To be sent to Survey Engineer

FILE: CARTER CO. FLOOD FILE

MC: BRIDGE DIV.

Wayne Walden  
~~XXXXXXXXXX~~  
Location Engineer  
November 10, 1970  
Date

LOC. NO. 1

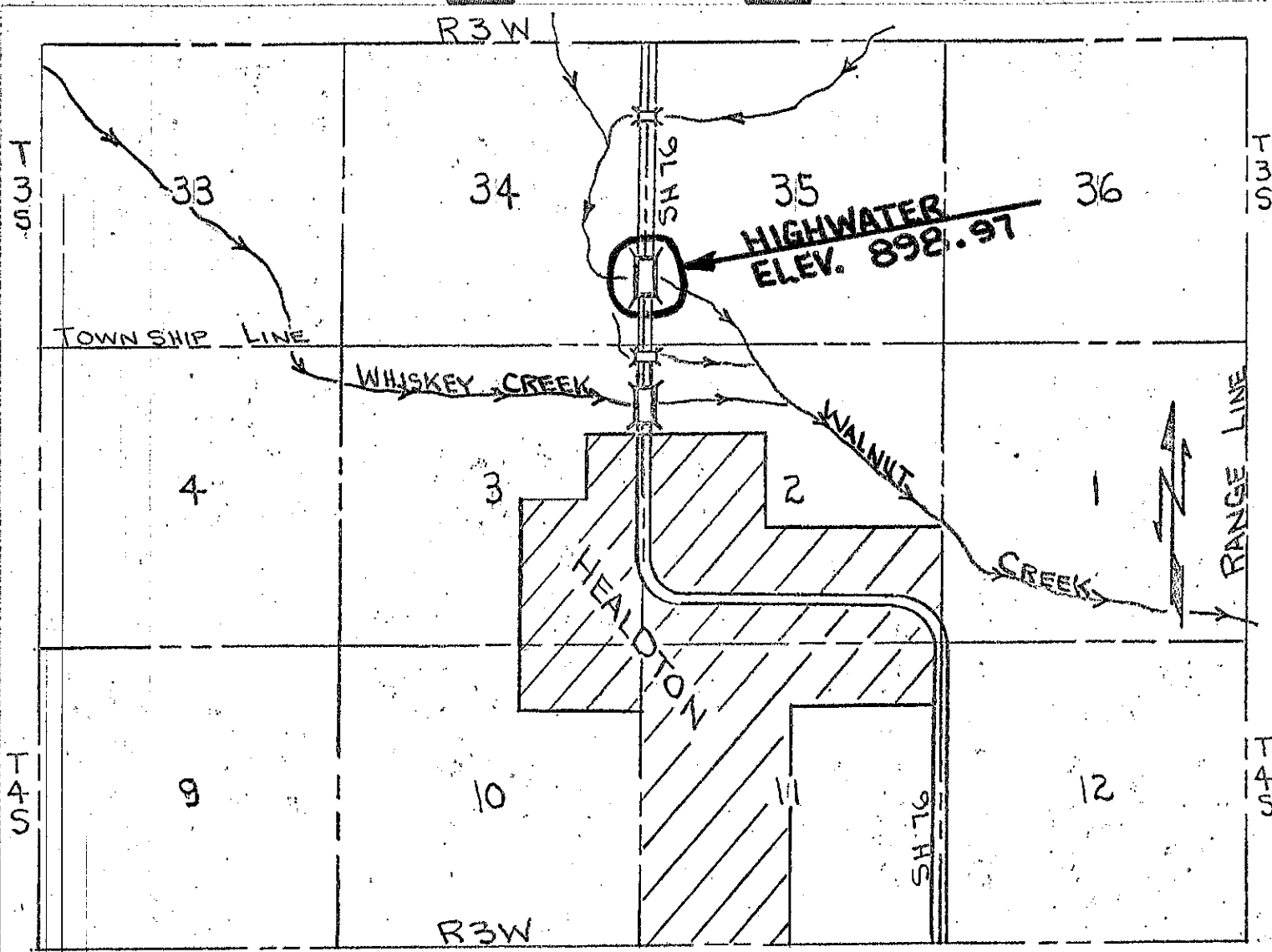

SIDE VIEW 24' X 110' CONC. BRIDGE

