

Survey Division  
Form No. 16  
Rev. Sept. 10, 1961

STATE OF OKLAHOMA  
DEPARTMENT OF HIGHWAYS  
SURVEY DIVISION

FLOOD INFORMATION FORM

Carter Co

To be used in obtaining and transmitting flood water elevations for Survey Division office record files. This information to be obtained by all Chiefs of Party or others in their vicinity in times of unusual high water, or at any time available from a reliable source. The elevations can be recorded by level reading, by measurement from bridge floor, in relation to a house, above roadbed or any other dependable, clear manner that fits the situation, the highest order possible to be used. Separate report to be made on each crossing or place obtained.

County CARTER Date highwater occurred APRIL 12, 1967

Highway number U.S. 77 Name of stream CADDO CREEK

Direction and distance from nearest town, village or store 5 MILES NORTH OF ARDMORE OKLAHOMA ALONG US 77 HWY.

Section, Township and Range BETWEEN SEC. 36 & 31 T3S, R1E & R2E.

Description of Location APPROX. 5 MILES NORTH OF ARDMORE ON CADDO CREEK EAST LANE. ( OLD US 77 BRIDGE )

Elevation 0.8 BELOW OLD BRIDGE FLOOR Source of levels FROM EAST LANE BRIDGE FLOOR EAST LANE ( ODD US 77 )

Method obtained LEVEL ROD Date obtained APRIL 14, 1967

Did it appear to be  normal  medium  extreme  do not know

Was highwater mark obtained from actual water, drift, local resident, U. S. Engineers, etc.? RESIDENT. INFORMATION OBTAINED FROM STATE HIGHWAY EMPLOYEE

FRED HUDSON, ARDMORE OKLA. DIVISION 7 WHO WAS THERE 8:00 AM TO 9:00 PM APRIL 12, 1967.

Explanatory Remarks THE WATER WAS OVER US 77 IN ONE PLACE ON THE EAST LANE APPROX. 400 FT. NORTH OF THE BRIDGE A PLACE OF ABOUT 75 FT. IN WIDE. ACCORDING TO ALL RESIDENT THE TRAFFIC WAS NEVER STOPED, THE WATER CROSSING THE ROAD WAS ONLY ABOUT 3" DEEP.

Location to be shown on back of this sheet as a check.

Field Note: To be sent to  
Survey Engineer

B. E. Garland  
Chief of Party

*Rec'd Apr. 18-1967  
William W. Bayler*

APRIL 14, 1967  
Date

LOC. NO 2

R 1 E

R 2 E

T 3 S

T 3 S

T 4 S

T 4 S

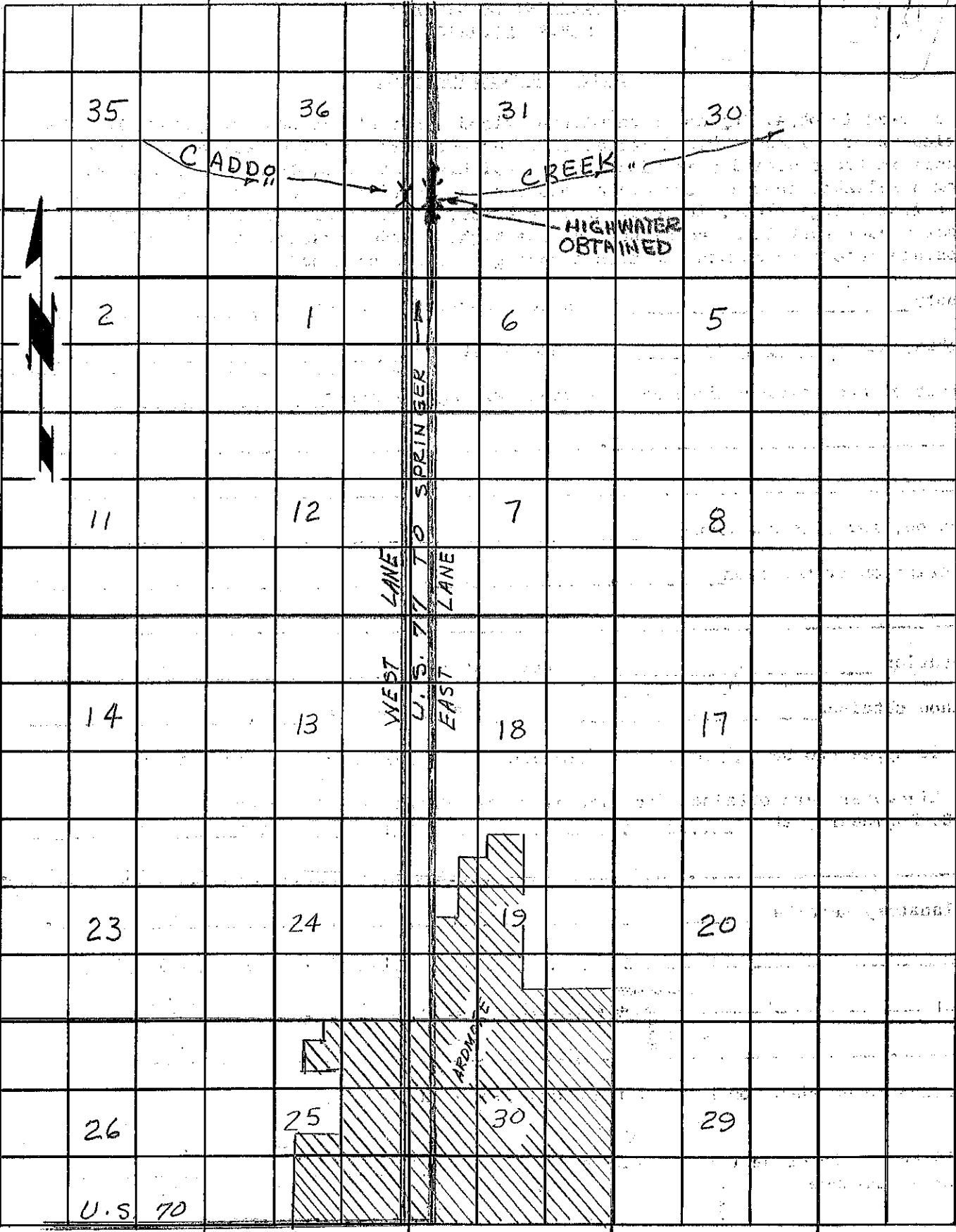

35

36

31

30

C ADDON

CREEK

HIGH WATER OBTAINED

2

1

6

5

11

12

7

8

14

13

18

17

23

24

19

20

26

25

30

29

U.S. 70

WEST LANE  
U.S. 77 TO SPRINGER  
EAST LANE

ARPA