

SURVEY DIVISION	
✓ RLS	
✓ OCC	11/30/70
GWP	
ROC	
JPA	
HGU	
CP	
CSM	

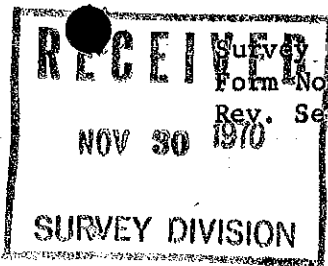

STATE OF OKLAHOMA
DEPARTMENT OF HIGHWAYS
SURVEY DIVISION

FLOOD INFORMATION FORM

SURVEY DIVISION

To be used in obtaining and transmitting flood water elevations for Survey Division office record files. This information to be obtained by all Chiefs of Party or others in their vicinity in times of unusual high water, or at any time available from a reliable source. The elevations can be recorded by level reading, by measurement from bridge floor, in relation to a house, above roadbed or any other dependable, clear manner that fits the situation, the highest order possible to be used. Separate report to be made on each crossing or place obtained.

County Carter Date highwater occurred October 26, 1970

Highway number Blacktop county road Name of stream Fourche Maline Creek

Direction and distance from nearest town, village or store From Hardy Murphy Coliseum in Ardmore, go east on Springdale Road for 4.5 miles, then go south on blacktop road for 3.0 miles, then go east for 1.3 mile on blacktop road to bridge over Fourche Maline Creek.

Section, Township and Range Sec 18, T5S, R3E.

Description of Location 0.3 mile east of the southwest corner of Sec 18, T5S, R3E.

Elevation Drift 3.20 lower than top of NW Wingwall. Source of levels _____

Method obtained Drift 250' west of creek. Date obtained October 26, 1970

Did it appear to be normal medium extreme do not know

Was highwater mark obtained from actual water, drift, local resident, U. S. Engineers, etc.? Drift 250' west of creek.

Explanatory Remarks _____

Location to be shown on back of this sheet as a check.

Field Note: To be sent to Survey Engineer

E.M. Brumlee
Chief of Party

FILE: CARTER Co. FLOOD FILE
HC: BRIDGE DIV.

10/26/70
Date

LOC. NO. 10

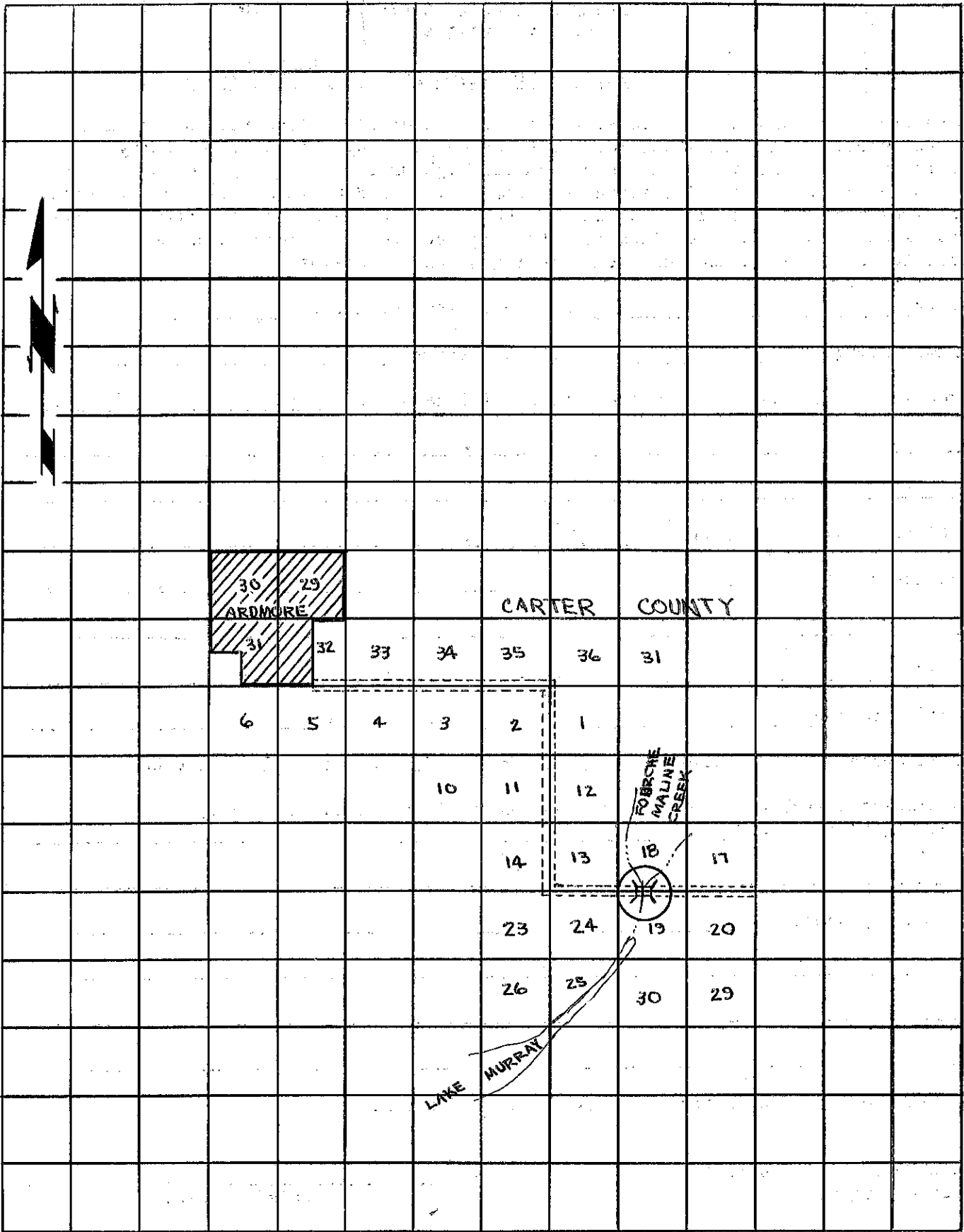

R2E

R3E

T 50 S