



OKLAHOMA DEPARTMENT OF TRANSPORTATION  
SURVEY DIVISION

**FLOOD INFORMATION FORM**

|   |  |
|---|--|
| <b>Division #:</b>  | 1 <input type="checkbox"/> 2 <input type="checkbox"/> 3 <input type="checkbox"/> 4 <input checked="" type="checkbox"/> 5 <input type="checkbox"/> 6 <input type="checkbox"/> 7 <input type="checkbox"/> 8 <input type="checkbox"/> |
| <b>County:</b>  | Canadian   |
| <b>Date Highwater occurred:</b>   | 5/25/2019  |
| <b>Highway Number:</b>  | SH 4   |
| <b>Name of Stream:</b>  | North Canadian River   |
| <b>Direction and distance from nearest town, or highway junction</b>                          | Approx. 1 miles North of JCT. SH 66 & SH 4   |
| <b>Section, Township, Range:</b>  | Section 16 T 12 N , R 15 W   |
| <b>Description of Location:</b>   | Cultivation, pasture   |
| <b>Latitude</b>   | 35^31'20.21" N   |
| <b>Longitude</b>  | 97^44'33.05" W   |
| <b>Highwater Elevation:</b>   | Approx. 1268' or 1' over the center of SH 4  |
| <b>Level Datum &amp; Source:</b>  | NAVD88 (Computed using GEOID12B)   |
| <b>Method used:</b>   | OPUS-RS Solution   |
| <b>Date Elevation Obtained:</b>   | 6/4/2019   |
| <b>Apparent Magnitude:</b>  | Normal <input type="checkbox"/> Medium <input checked="" type="checkbox"/> Extreme <input type="checkbox"/> Unknown <input type="checkbox"/>   |
| <b>Was Highwater Mark obtained from actual water, drift, local resident, or other source?</b> | Highwater was obtained from actual drift line using RTK and information given from Canandian County Supervisor   |
| <b>Explanatory Remarks:</b>   | 6" to 8" of rain   |

Name (Signature) \_\_\_\_\_

Name (Printed) Clinton Crew

Date 6/4/2019

Note: Show Vicinity Map on back of form

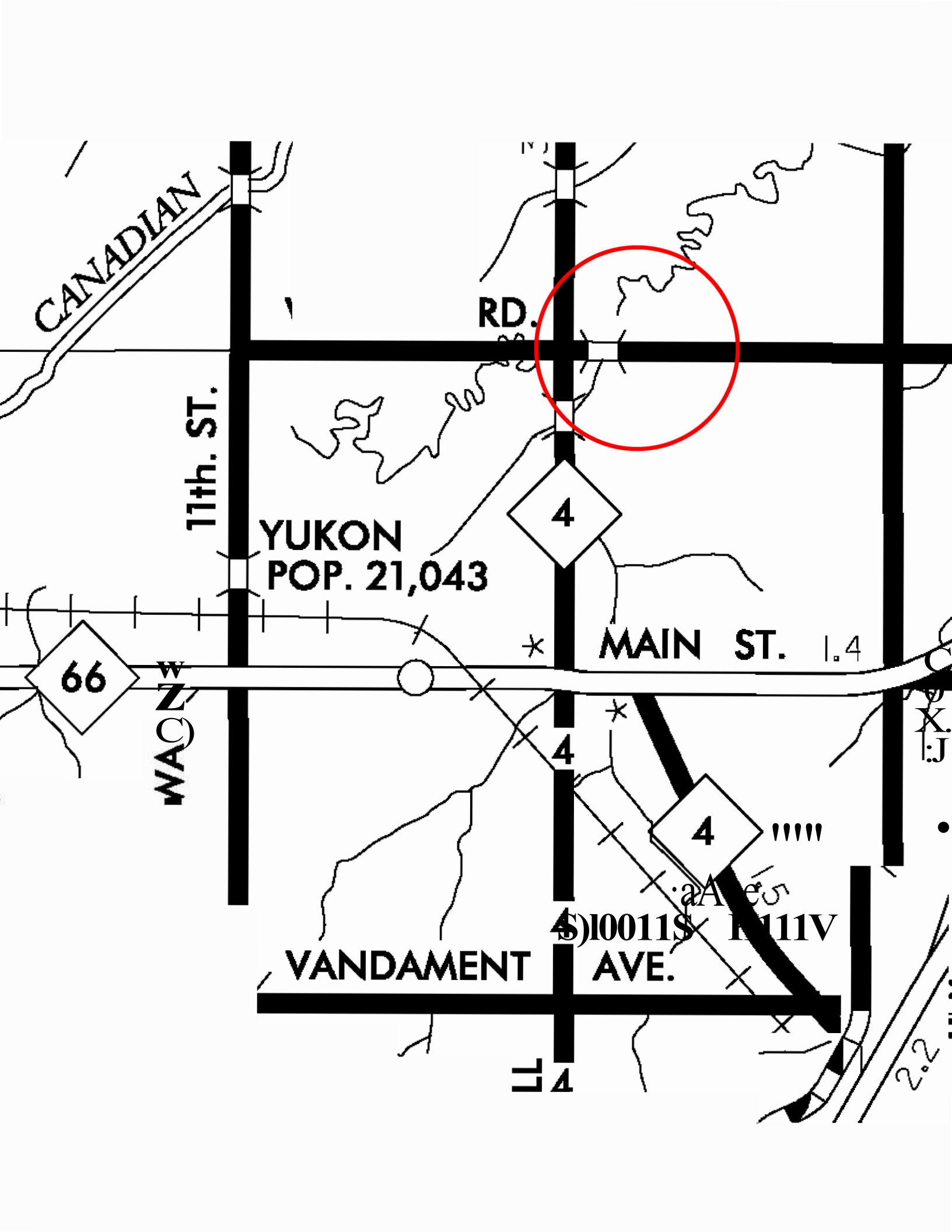

CANADIAN

RD.

11th. ST.

YUKON  
POP. 21,043

4

66

WAGAN

MAIN ST. 1.4

4

4

VANDAMENT

AVE. 1.11V

4

2.2