



OKLAHOMA DEPARTMENT OF TRANSPORTATION  
SURVEY DIVISION

**FLOOD INFORMATION FORM**

<b>Division #:</b>	1 <input type="checkbox"/> 2 <input type="checkbox"/> 3 <input type="checkbox"/> 4 <input checked="" type="checkbox"/> 5 <input type="checkbox"/> 6 <input type="checkbox"/> 7 <input type="checkbox"/> 8 <input type="checkbox"/>
<b>County:</b>	Canadian
<b>Date Highwater occurred:</b>	5/25/20109
<b>Highway Number:</b>	US 270
<b>Name of Stream:</b>	Unknown
<b>Direction and distance from nearest town, or highway junction</b>	Approx 0.8 Mile South of Calumet along US 270
<b>Section, Township, Range:</b>	Section 23 T 13 N , R 9 W
<b>Description of Location:</b>	Pasture, cultivation
<b>Latitude</b>	35^35'29.21" N
<b>Longitude</b>	98^07'07.03" W
<b>Highwater Elevation:</b>	Approx. 1387' or 6" over the center of US 270
<b>Level Datum &amp; Source:</b>	NAVD88 (Computed using GEOID12B)
<b>Method used:</b>	OPUS-RS Solution
<b>Date Elevation Obtained:</b>	6/4/2019
<b>Apparent Magnitude:</b>	Normal <input type="checkbox"/> Medium <input checked="" type="checkbox"/> Extreme <input type="checkbox"/> Unknown <input type="checkbox"/>
<b>Was Highwater Mark obtained from actual water, drift, local resident, or other source?</b>	Highwater was obtained from actual drift line using RTK and information given from Canadian CO. Supervisor
<b>Explanatory Remarks:</b>	4" to 6" of rain

Name (Signature) \_\_\_\_\_

Name (Printed) Steve Perring

Date 6/4/2019

Note: Show Vicinity Map on back of form

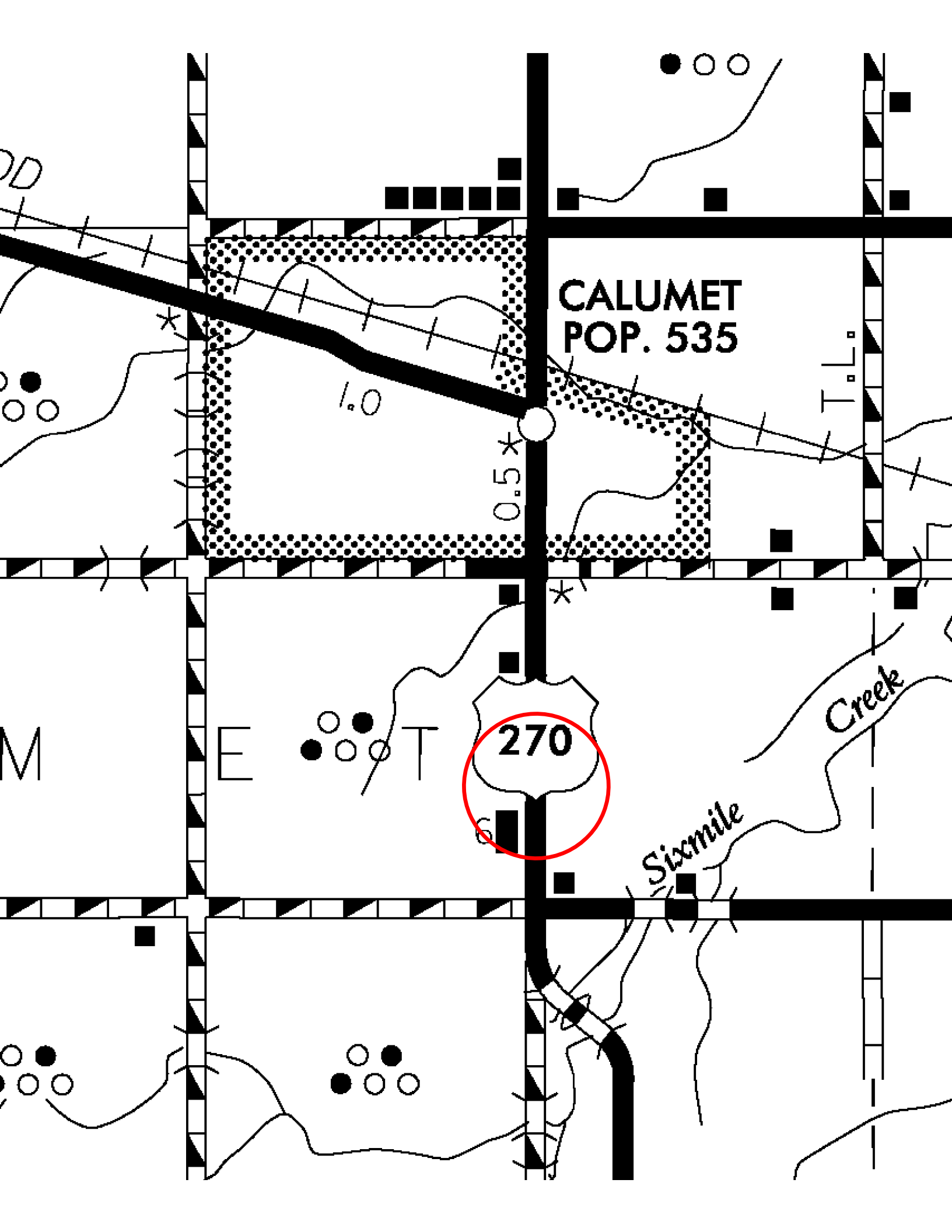

CALUMET  
POP. 535

270

1.0

0.5\*

Creek

Sixmile

DD

M

E

T

L