

STATE OF OKLAHOMA
DEPARTMENT OF HIGHWAYS
SURVEY DIVISION

FLOOD INFORMATION FORM

To be used in obtaining and transmitting flood water elevations for Survey Division office record files. This information to be obtained by all Chiefs of Party or others in their vicinity in times of unusual high water, or at any time available from a reliable source. The elevations can be recorded by level reading, by measurement from bridge floor, in relation to a house, above roadbed or any other dependable, clear manner that fits the situation, the highest order possible to be used. Separate report to be made on each crossing or place obtained.

County Canadian Date highwater occurred 9/17/65

Highway number U.S. 66 Name of stream Four Mile Creek

Direction and distance from nearest town, village or store 1 mile west of El Reno
on U.S. 66

Section, Township and Range Section 7, T13N, R8W

Description of Location Bridge over Four Mile Creek, 1 mile west of El Reno on U.S. 66

Elevation "See remarks" Source of levels _____

Method obtained with wye level & Philadelphia rod Date obtained 9/29/65

Did it appear to be normal medium extreme do not know

Was highwater mark obtained from actual water, drift, local resident, U. S. Engineers, etc.? Drift on upstream side of RCB.

Explanatory Remarks Highwater was 0.6 ft. below west end of south hdwl. on RCB., water did not cross US 66.
Highwater was caused from 8 to 10 inches of rain in approx 12 hours.
This information was obtained by A. W. Ziegelgruber and B. D. Roden.

Location to be shown on back of this sheet as a check.

Field Note: To be sent to
Survey Engineer

A. W. Ziegelgruber
~~Chief of Party~~ Chief of Party
~~Location Engineer~~
December 20, 1965
Date

M^c

T 13 N

T 13 N

T 12 N

T 12 N

T 11 N

T 11 N

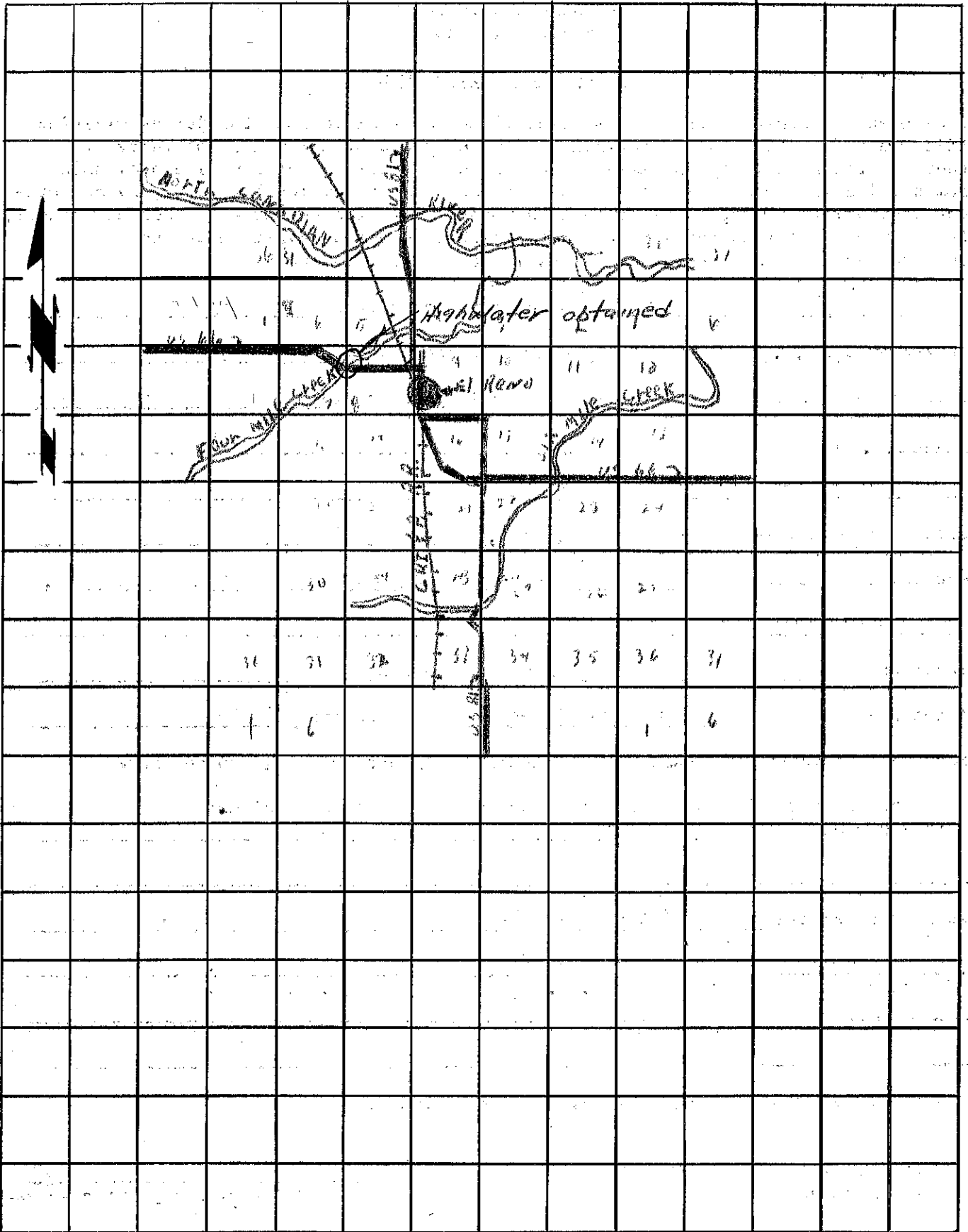

R 7 W

R 7 W

R 6 W