

STATE OF OKLAHOMA
DEPARTMENT OF HIGHWAYS
SURVEY DIVISION

Survey Division
Form No. 16
Rev. Sept. 10, 1961

FLOOD INFORMATION FORM

To be used in obtaining and transmitting flood water elevations for Survey Division office record files. This information to be obtained by all Chiefs of Party or others in their vicinity in times of unusual high water, or at any time available from a reliable source. The elevations can be recorded by level reading, by measurement from bridge floor, in relation to a house, above roadbed or any other dependable, clear manner that fits the situation, the highest order possible to be used. Separate report to be made on each crossing or place obtained.

County CANADIAN Date highwater occurred Nov. 3, 1974

Highway number U.S. 66 Name of stream PURCELL CREEK

Direction and distance from nearest town, village or store APPROX. 5.0 MILES
ON U.S. FROM JCT. U.S. 81 & U.S. 66 IN SE PART OF EL RENO; AT THE
NW COR SEC. 21, T12N, R6W.

Section, Township and Range SEC. 21, T12N, R6W.

Description of Location 0' ABOVE BRIDGE SEAT AT W END BRIDGE.

Elevation _____ Source of levels _____

Method obtained HAND LEVEL Date obtained Nov. 7, 1974

Did it appear to be normal medium extreme do not know

Was highwater mark obtained from actual water, drift, local resident,
U. S. Engineers, etc.? WATER MARKS & DRIFTS ON BRIDGE

Explanatory Remarks _____

Location to be shown on back of this sheet as a check.

Field Note: To be sent to
Survey Engineer

Herwarth Walden
Chief of Party Loc. Engr.

11-26-74
Date

Location No. 5

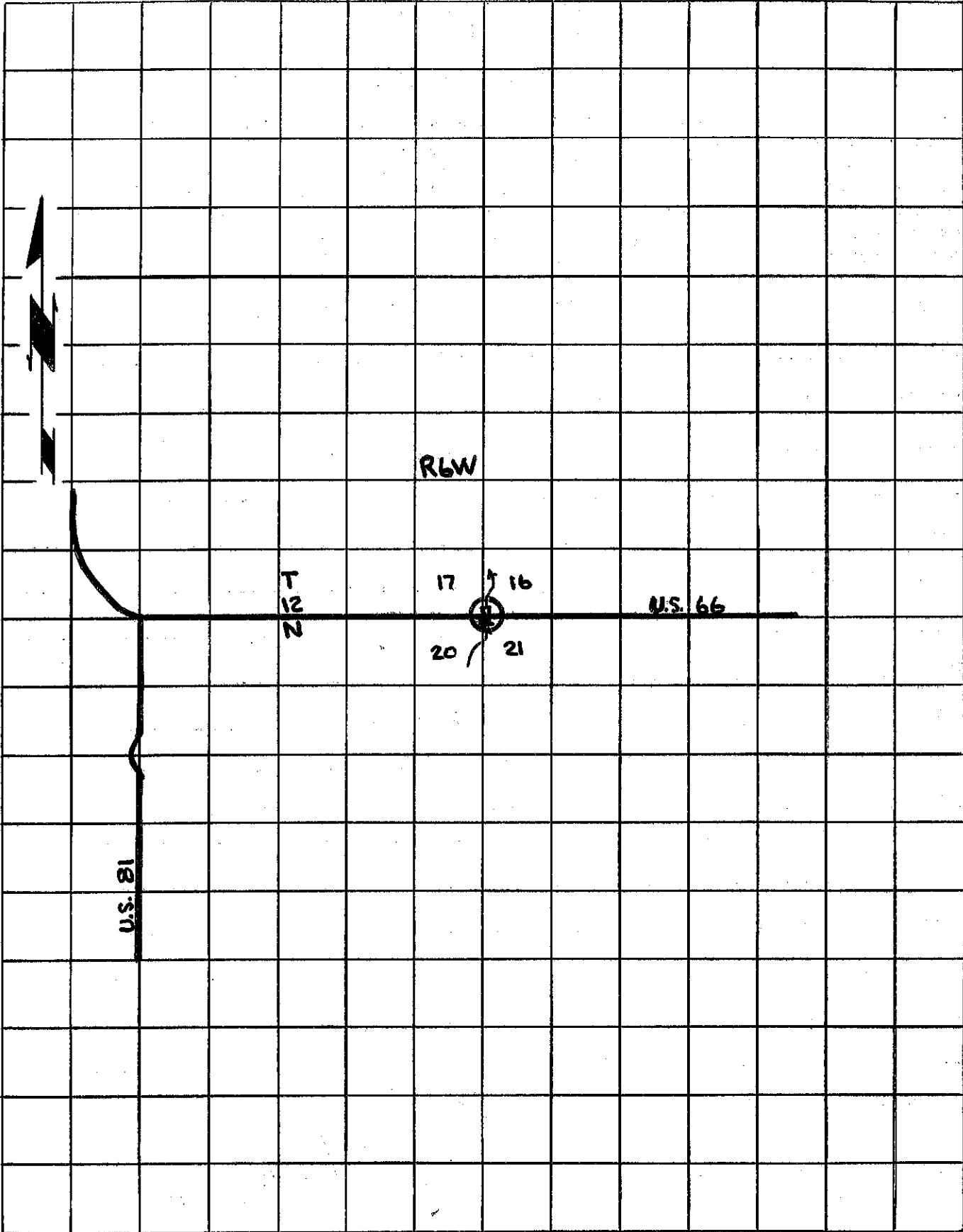

RLW

T
12
N

17 16
20 21

U.S. 66

U.S. 81