

OKLAHOMA DEPARTMENT OF TRANSPORTATION  
SURVEY DIVISION

FLOOD INFORMATION FORM

Division #:	1 <input type="checkbox"/> 2 <input type="checkbox"/> 3 <input type="checkbox"/> 4 <input checked="" type="checkbox"/> 5 <input type="checkbox"/> 6 <input type="checkbox"/> 7 <input type="checkbox"/> 8 <input type="checkbox"/>
County:	Canadian
Date Highwater occurred:	8/19/07
Highway Number:	U.S. 81
Name of Stream:	Six Mile Creek
Direction and distance from nearest town, or highway junction	From the Junction of U.S. 81 & S.H. 66 in El Reno, Ok.. Approx. 1.9 miles south.
Section, Township, Range:	Sections 28, T-12-N, R-7-W
Description of Location:	1.5 feet Above centerline Southbound U.S. 81 at bridge.
Highwater Elevation:	1349.3
Level Datum & Source:	GPS from SWO 4029(1)
Method used:	WILD NA 2 ENGR. LEVEL
Date Elevation Obtained:	8/21/07
Apparent Magnitude:	Normal <input type="checkbox"/> Medium <input type="checkbox"/> Extreme <input checked="" type="checkbox"/> Don't Know <input type="checkbox"/>
Was Highwater Mark obtained from actual water, drift, local resident, or other source?	Drifts
Explanatory Remarks:	NW cor. Of wingwall SW cor. Northbound ELEV. 1348.04

Note: Show Vicinity Map on back of form

Name (signature)

*Gary S. Rhoads*

Name (Printed)

GARY S. RHOADS

Date:

8/30/2007

Survey Division

Form No. 16

Revised: 5/09/2007

Location # 8

R-7-W

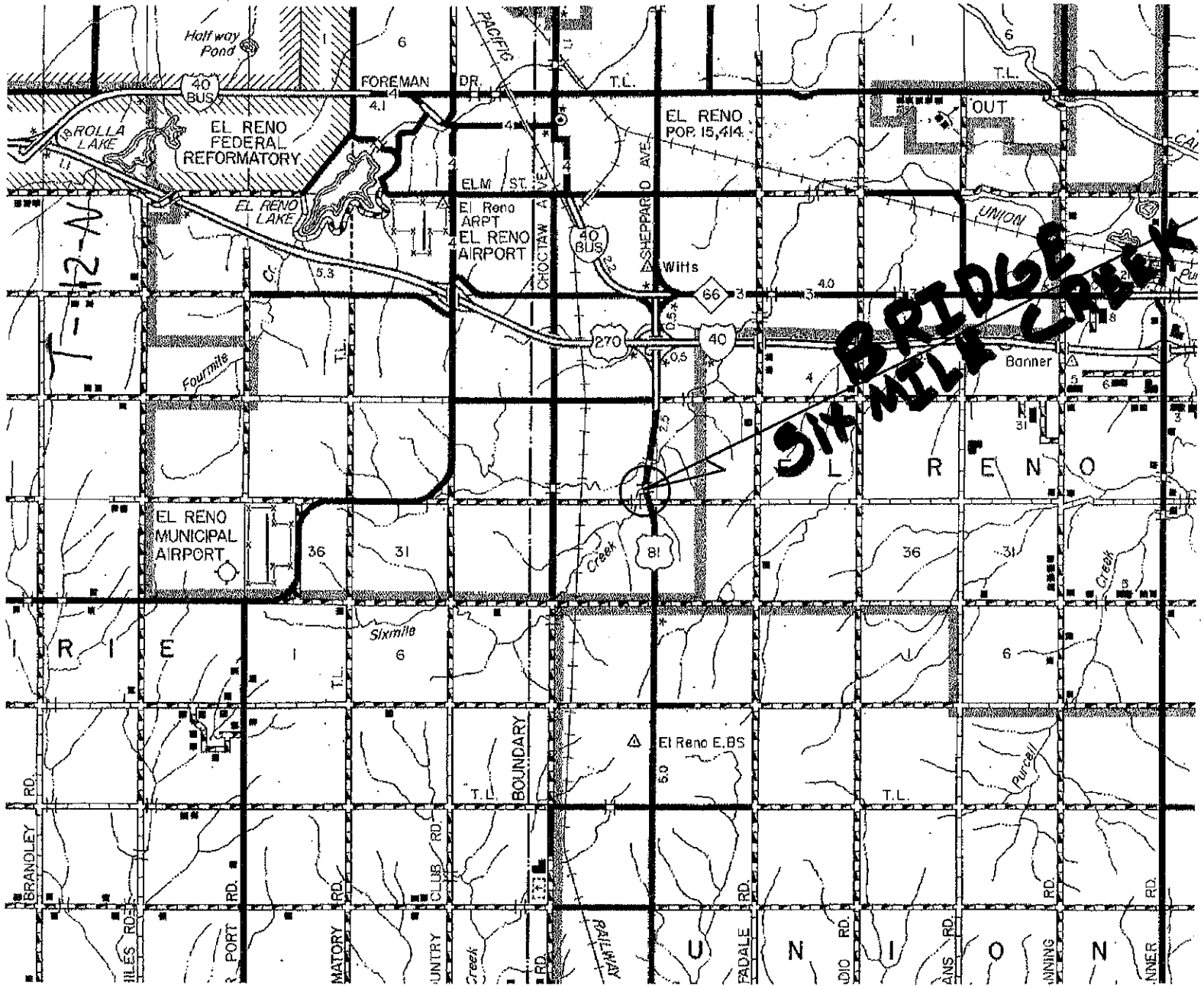

**SIX MILE CREEK BRIDGE**

1-12-A

Half way Pond

EL RENO FEDERAL REFORMATORY

EL RENO POP. 15,414

EL RENO MUNICIPAL AIRPORT

Sixmile

El Reno E.B.S

