

STATE OF OKLAHOMA
DEPARTMENT OF HIGHWAYS
SURVEY DIVISION

Survey Division
Form No. 16
Rev. Sept. 10, 1961

FLOOD INFORMATION FORM

To be used in obtaining and transmitting flood water elevations for Survey Division office record files. This information to be obtained by all Chiefs of Party or others in their vicinity in times of unusual high water, or at any time available from a reliable source. The elevations can be recorded by level reading, by measurement from bridge floor, in relation to a house, above roadbed or any other dependable, clear manner that fits the situation, the highest order possible to be used. Separate report to be made on each crossing or place obtained.

County CANADIAN Date highwater occurred Nov. 3 1974

Highway number U.S. 81 Name of stream _____

Direction and distance from nearest town, village or store APPROX. 6.3 MI. N.

OF UNION CITY. APPROX. 400' W. & 1500' N. OF S.E. COR.

SEC. 28, T12N, R7W.

Section, Township and Range SECTION 28, T12N, R7W

Description of Location 2⁵ BELOW BRIDGE SEAT AT S.W. COR. BRIDGE

Elevation _____ Source of levels _____

Method obtained HAND LEVEL Date obtained Nov. 7, 1974

Did it appear to be normal medium extreme do not know

Was highwater mark obtained from actual water, drift, local resident, U. S. Engineers, etc.? DRIFTS UNDER BRIDGE.

Explanatory Remarks _____

Location to be shown on back of this sheet as a check.

Field Note: To be sent to
Survey Engineer

Rewynne Walker
Chief of Party Loc. Engr.

11-26-74
Date

Location No. 30

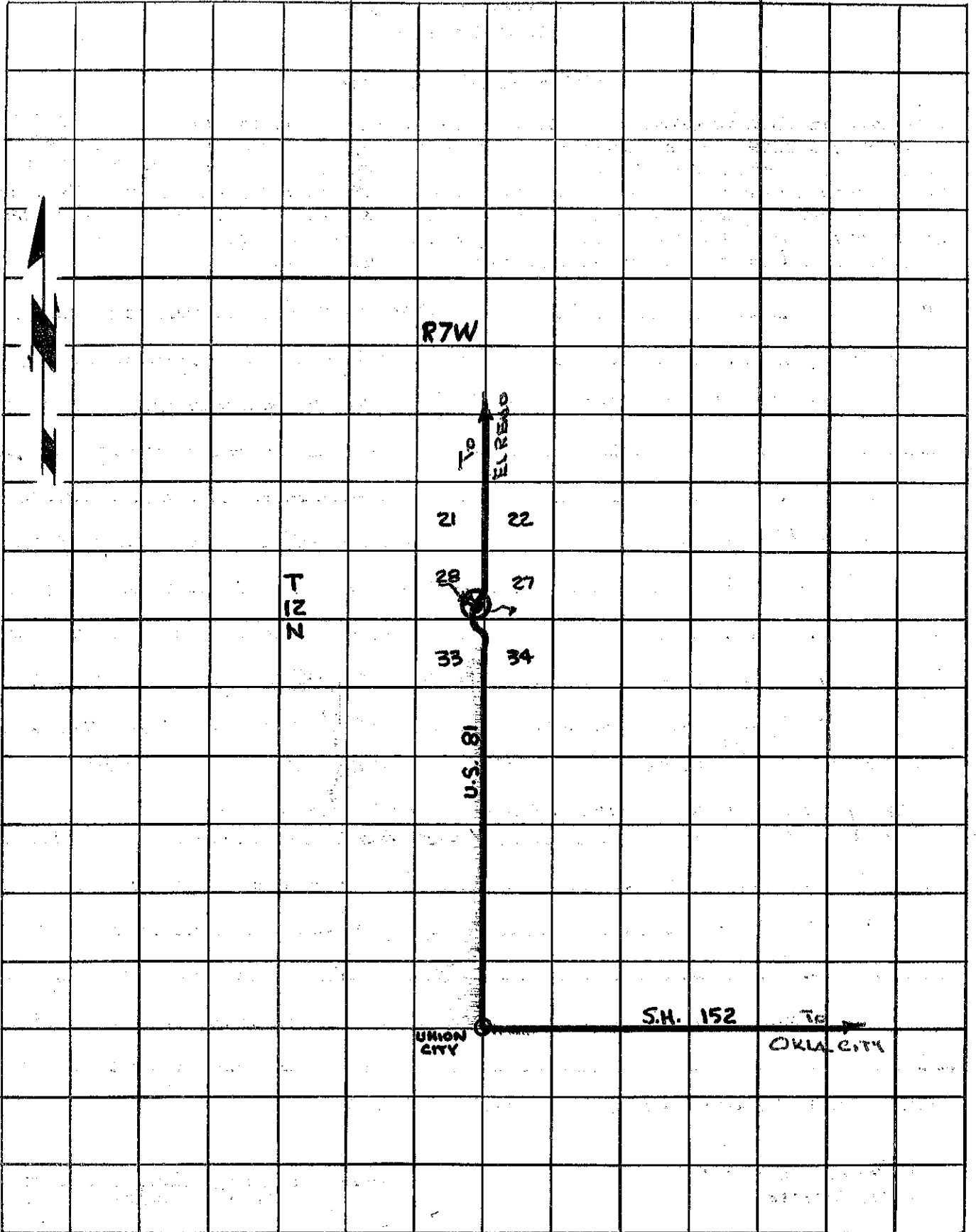

R7W

To
EL RENO

21 22

28 27

33 34

T
12
N

U.S. 81

UNION
CITY

S.H. 152

To
OKLA CITY