

STATE OF OKLAHOMA
DEPARTMENT OF HIGHWAYS
SURVEY DIVISION

Survey Division
Form No. 16
Rev. Sept. 10, 1961

FLOOD INFORMATION FORM

To be used in obtaining and transmitting flood water elevations for Survey Division office record files. This information to be obtained by all Chiefs of Party or others in their vicinity in times of unusual high water, or at any time available from a reliable source. The elevations can be recorded by level reading, by measurement from bridge floor, in relation to a house, above roadbed or any other dependable, clear manner that fits the situation, the highest order possible to be used. Separate report to be made on each crossing or place obtained.

County CANADIAN Date highwater occurred NOV. 3, 1974

Highway number S.H. 152 Name of stream _____

Direction and distance from nearest town, village or store APPROX. 2.2 MI.

EAST OF UNION CITY. OR 0.2 MILE EAST OF S.W. COR.

SEC. 25, T11N, R7W.

Section, Township and Range SECTION, 25, T11N, R7W.

Description of Location 0³ ABOVE S.E. COR. S. CONC. CURB ON TIMBER

BRIDGE.

Elevation 1308.27 Source of levels USC & GS.

Method obtained ENGINEER'S LEVEL Date obtained NOV. 6, 1974

Did it appear to be normal medium extreme do not know

Was highwater mark obtained from actual water, drift, local resident, U. S. Engineers, etc.? DRIFTS ON FENCE AND TREES N. SIDE

OF HIGHWAY.

Explanatory Remarks ELEVATION OBTAINED FROM DHD. STD. BRASS MARK.

NO. C-9-400 ELEV. = 1305.70 ON S. W. 2692 (1) S.H. 152 HOR. & VER.

CONTROLS - LOCATION OF B.M. APPROX. 400' W. & 30' N. OF S.E. COR. SEC. 26-T11N-R7W

Location to be shown on back of this sheet as a check.

Field Note: To be sent to
Survey Engineer

Raymond Calder
Chief of Party LOC. ENGR.

11-26-74
Date

Location No. 62

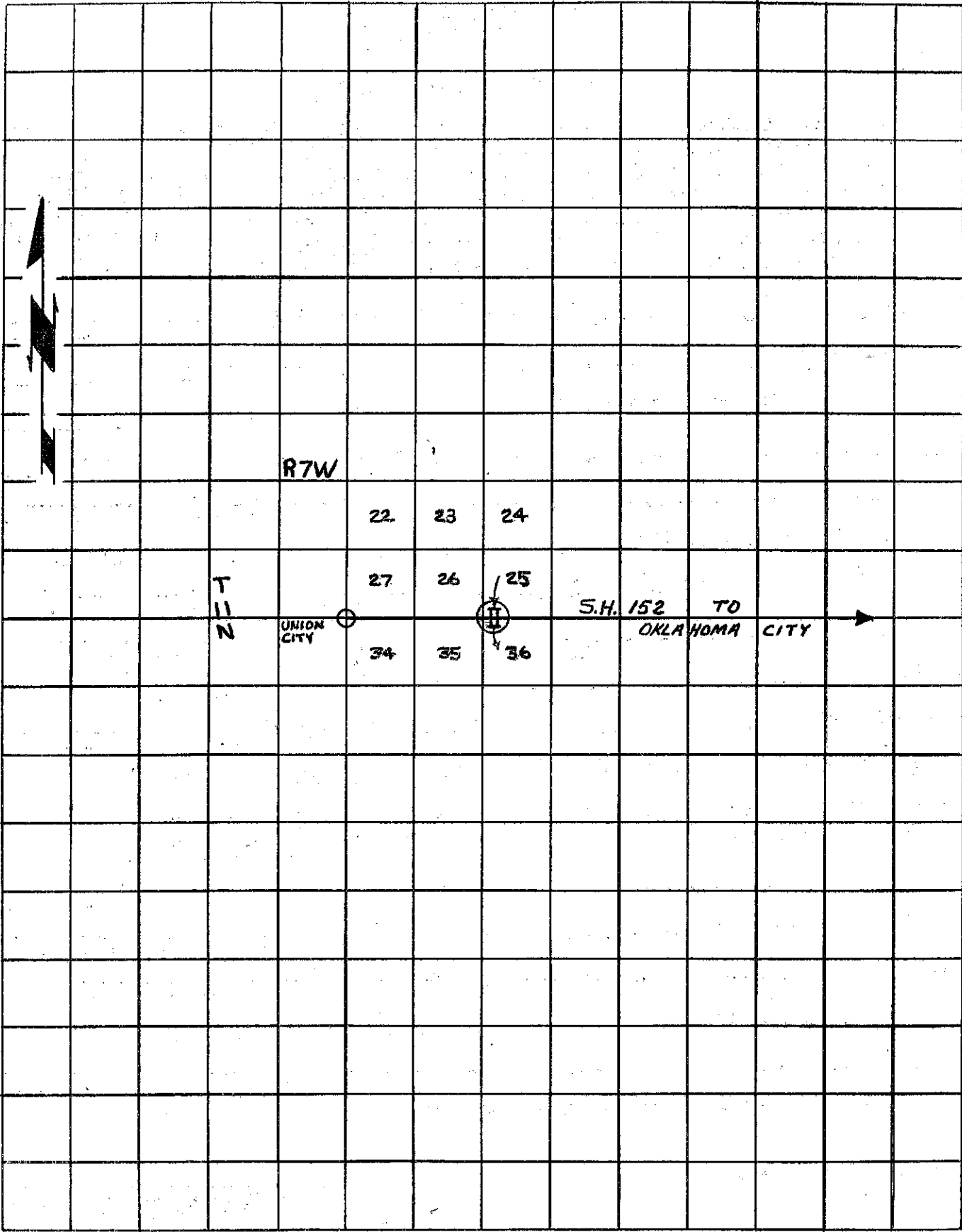

R7W

22 23 24

27 26 25

N
11
T

UNION
CITY

S.H. 152 TO
OKLAHOMA CITY

34 35 36