

STATE OF OKLAHOMA  
DEPARTMENT OF HIGHWAYS  
SURVEY DIVISION

Survey Division  
Form No. 16  
Rev. Sept. 10, 1961

FLOOD INFORMATION FORM

To be used in obtaining and transmitting flood water elevations for Survey Division office record files. This information to be obtained by all Chiefs of Party or others in their vicinity in times of unusual high water, or at any time available from a reliable source. The elevations can be recorded by level reading, by measurement from bridge floor, in relation to a house, above roadbed or any other dependable, clear manner that fits the situation, the highest order possible to be used. Separate report to be made on each crossing or place obtained.

County CANADIAN Date highwater occurred Nov. 3, 1974

Highway number SH. 152 Name of stream \_\_\_\_\_

Direction and distance from nearest town, village or store APPROX. 3.15 Mi.  
EAST OF UNION CITY, OR 0.15<sup>Mi.</sup> EAST OF THE S.W. COR. SEC. 30,  
T11N, R6W

Section, Township and Range SEC. 30, T11N, R6W

Description of Location 3<sup>rd</sup> ABOVE TOP OF R.C.P.  
1<sup>st</sup> ABOVE & ASPHALT PAVING.

Elevation \_\_\_\_\_ Source of levels \_\_\_\_\_

Method obtained ENGINEER'S LEVEL Date obtained Nov 6, 1974

Did it appear to be  normal  medium  extreme  do not know

Was highwater mark obtained from actual water, drift, local resident, U. S. Engineers, etc.? DRIFTS ON HILLSIDE AND TREES N. SIDE  
OF HIGHWAY.

Explanatory Remarks \_\_\_\_\_

Location to be shown on back of this sheet as a check.

Field Note: To be sent to  
Survey Engineer

Lawrence Walden  
Chief of Party Loc. ENGR.

11-26-74  
Date

Location No. 65

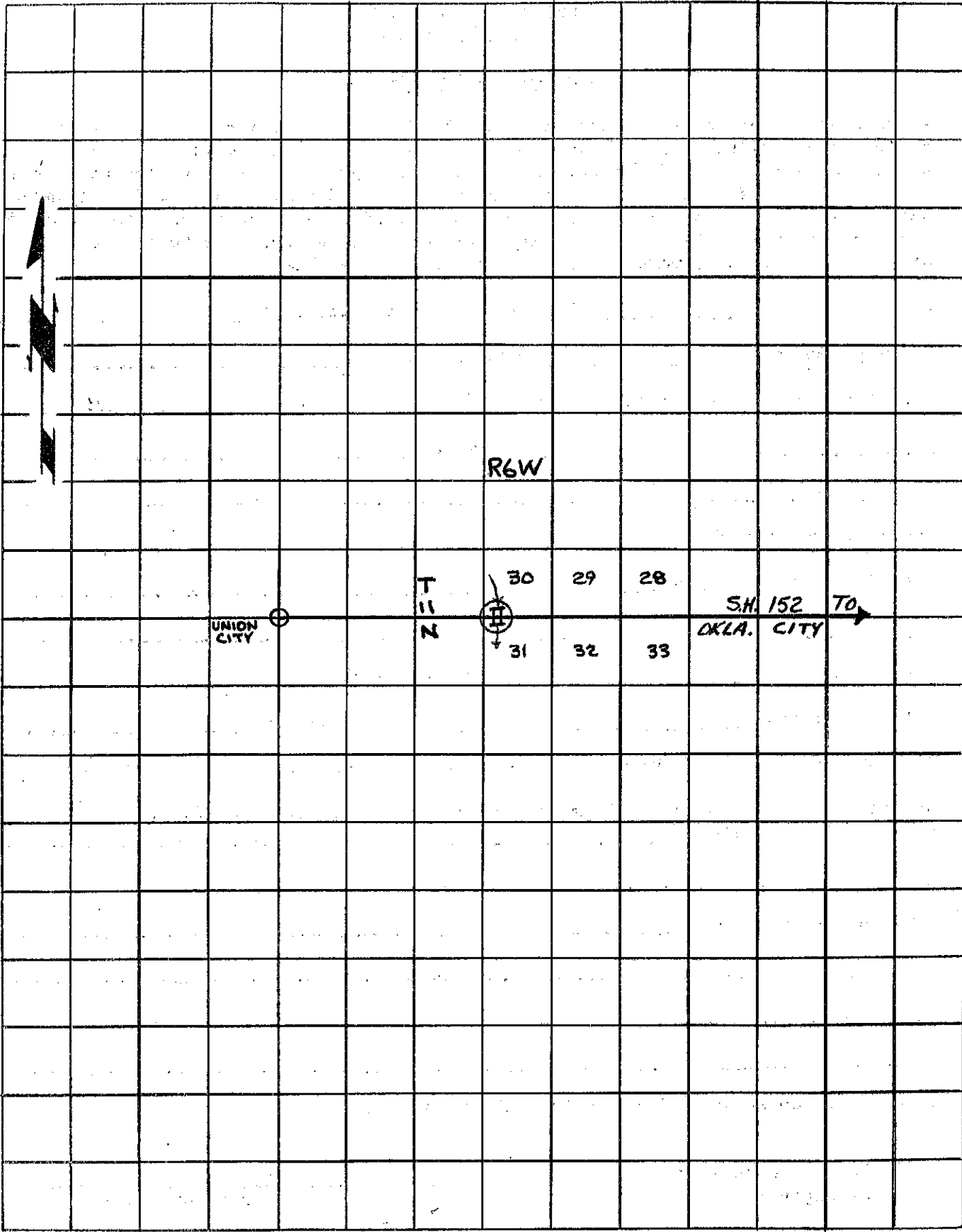

UNION CITY

R6W

30

29

28

SH. 152 TO

OKLA. CITY

31

32

33