

STATE OF OKLAHOMA
DEPARTMENT OF HIGHWAYS
SURVEY DIVISION

Survey Division
Form No. 16
Rev. Sept. 10, 1961

FLOOD INFORMATION FORM

To be used in obtaining and transmitting flood water elevations for Survey Division office record files. This information to be obtained by all Chiefs of Party or others in their vicinity in times of unusual high water, or at any time available from a reliable source. The elevations can be recorded by level reading, by measurement from bridge floor, in relation to a house, above roadbed or any other dependable, clear manner that fits the situation, the highest order possible to be used. Separate report to be made on each crossing or place obtained.

County CANADIAN Date highwater occurred Nov. 3, 1974

Highway number S.H. 152 Name of stream _____

Direction and distance from nearest town, village or store APPROX. 3.8 MI.

EAST OF UNION CITY, OR 0.8 MILE EAST OF S.W. COR. SEC. 30,
T11N, R6W.

Section, Township and Range SECTION 30, T11N, R6W

Description of Location 5' ABOVE TOP OF N. END OF W. C.G.M.P.
0.8' ABOVE E. ASPHALT PAVING.

Elevation _____ Source of levels _____

Method obtained ENGINEER'S LEVEL Date obtained Nov. 6, 1974

Did it appear to be normal medium extreme do not know

Was highwater mark obtained from actual water, drift, local resident,
U. S. Engineers, etc.? DRIFTS ON FENCE AND TREES ON
N. SIDE OF HIGHWAY.

Explanatory Remarks _____

Location to be shown on back of this sheet as a check.

Field Note: To be sent to
Survey Engineer

James Walden
Chief of Party Loc. ENGR.

11-26-74
Date

Location No. 67

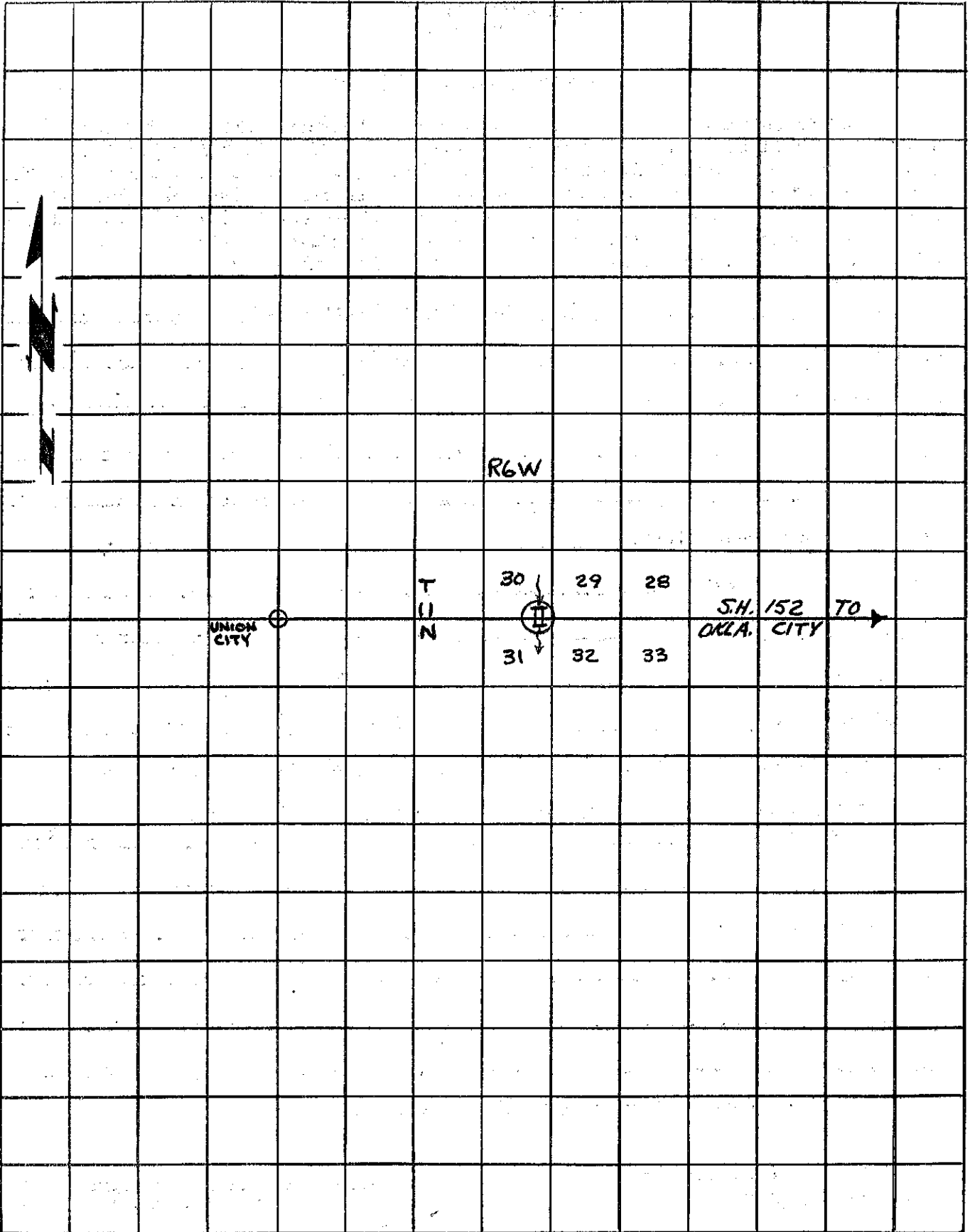

R6W

UNION

UNION CITY

30

29

28

31

32

33

SH. 152 TO OKLA. CITY