

STATE OF OKLAHOMA
DEPARTMENT OF HIGHWAYS
SURVEY DIVISION

FLOOD INFORMATION FORM

To be used in obtaining and transmitting flood water elevations for Survey Division office record files. This information to be obtained by all Chiefs of Party or others in their vicinity in times of unusual high water, or at any time available from a reliable source. The elevations can be recorded by level reading, by measurement from bridge floor, in relation to a house, above roadbed or any other dependable, clear manner that fits the situation, the highest order possible to be used. Separate report to be made on each crossing or place obtained.

County CANADIAN Date highwater occurred NOV. 3, 1974

Highway number S.H. 152 Name of stream _____

Direction and distance from nearest town, village or store APPROX. 5.75 MI.

EAST OF UNION CITY, OR APPROX. 0.75 MILE EAST OF THE SW COR
SEC. 28, T11N, R6W.

Section, Township and Range SECTION 28, T11N, R6W.

Description of Location 0⁵ ABOVE E ASPHALT PAVING.
6⁶ ABOVE TOP N. END W. C.C.M.P.

Elevation _____ Source of levels _____

Method obtained ENGINEER'S LEVEL Date obtained NOV. 6, 1974

Did it appear to be normal medium extreme do not know

Was highwater mark obtained from actual water, drift, local resident, U. S. Engineers, etc.? DRIETS ON HILLSIDE AND ON FENCE
N. SIDE OF HIGHWAY.

Explanatory Remarks _____

Location to be shown on back of this sheet as a check.

Field Note: To be sent to
Survey Engineer

Wayne Calder
Chief of Party Loc. ENGR.

11-26-74
Date

Location No. 72

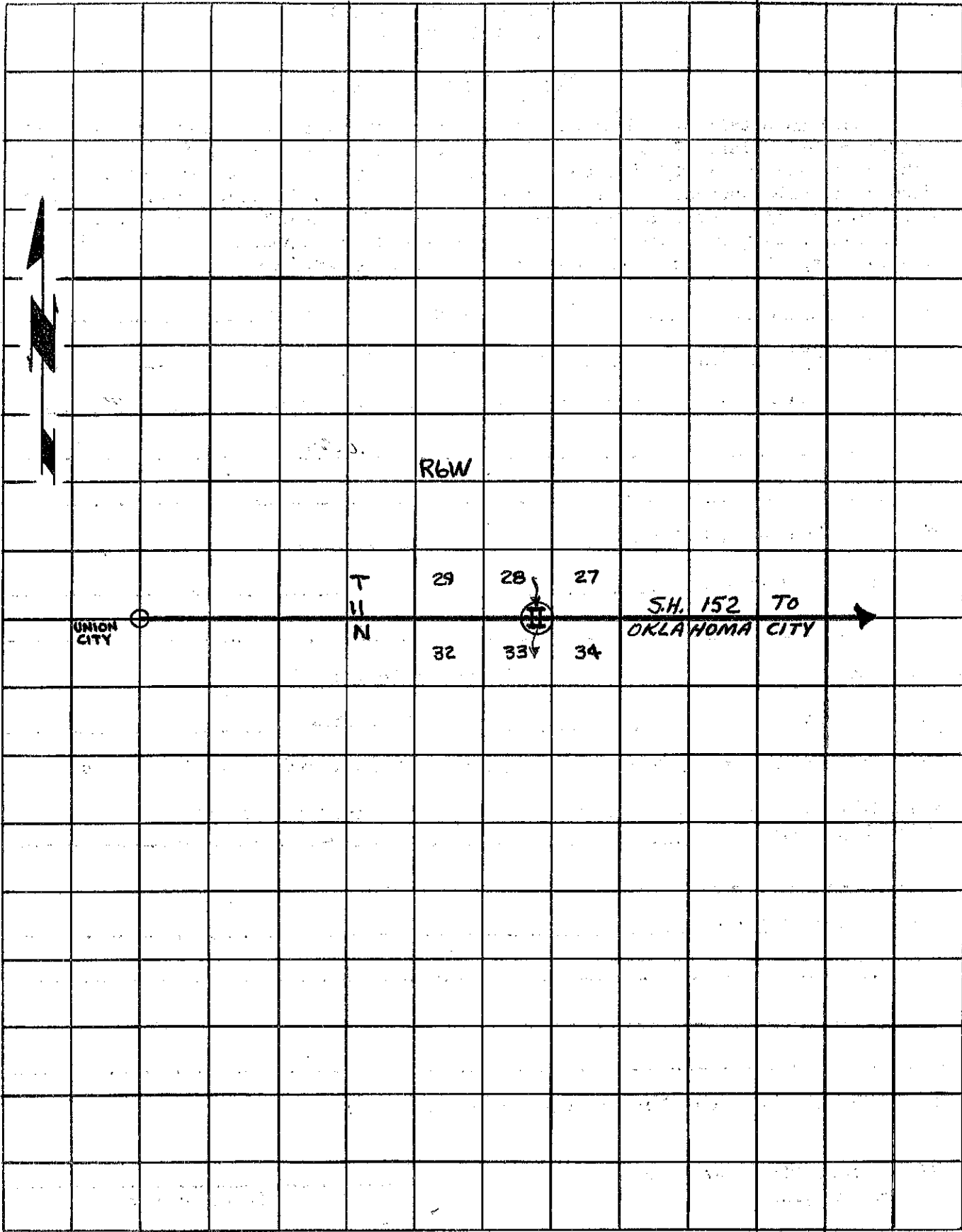

UNION CITY

T
11
N

R6W

29

28

27

32

33

34

S.H. 152 TO
OKLAHOMA CITY