

STATE OF OKLAHOMA  
DEPARTMENT OF HIGHWAYS  
SURVEY DIVISION

FLOOD INFORMATION FORM

To be used in obtaining and transmitting flood water elevations for Survey Division office record files. This information to be obtained by all Chiefs of Party or others in their vicinity in times of unusual high water, or at any time available from a reliable source. The elevations can be recorded by level reading, by measurement from bridge floor, in relation to a house, above roadbed or any other dependable, clear manner that fits the situation, the highest order possible to be used. Separate report to be made on each crossing or place obtained.

County CANADIAN Date highwater occurred NOV. 3, 1974

Highway number S.H. 152 Name of stream \_\_\_\_\_

Direction and distance from nearest town, village or store APPROX. 0.9 MI.

WEST OF JCT. MUSTANG RD. & S.H. 152 AT MUSTANG, OR  
APPROX. 0.1 MILE EAST OF THE S.W. COR. SEC. 28, T11N, R5W.

Section, Township and Range SECTION 28, T11N, R5W

Description of Location 13 BELOW TOP S. GANG. HWY. OF R.C.B.

Elevation \_\_\_\_\_ Source of levels \_\_\_\_\_

Method obtained TAPED DOWN FROM HWY. Date obtained NOV. 6, 1974

Did it appear to be  normal  medium  extreme  do not know

Was highwater mark obtained from actual water, drift, local resident, U. S. Engineers, etc.? DRIFTS ALONG BANK OF CREEK BELOW R.C.B.

Explanatory Remarks \_\_\_\_\_

Location to be shown on back of this sheet as a check.

Field Note: To be sent to  
Survey Engineer

*DeWeyne Walden*  
Chief of Party Loc. ENGR.

11-26-74

Date

Location No. 81

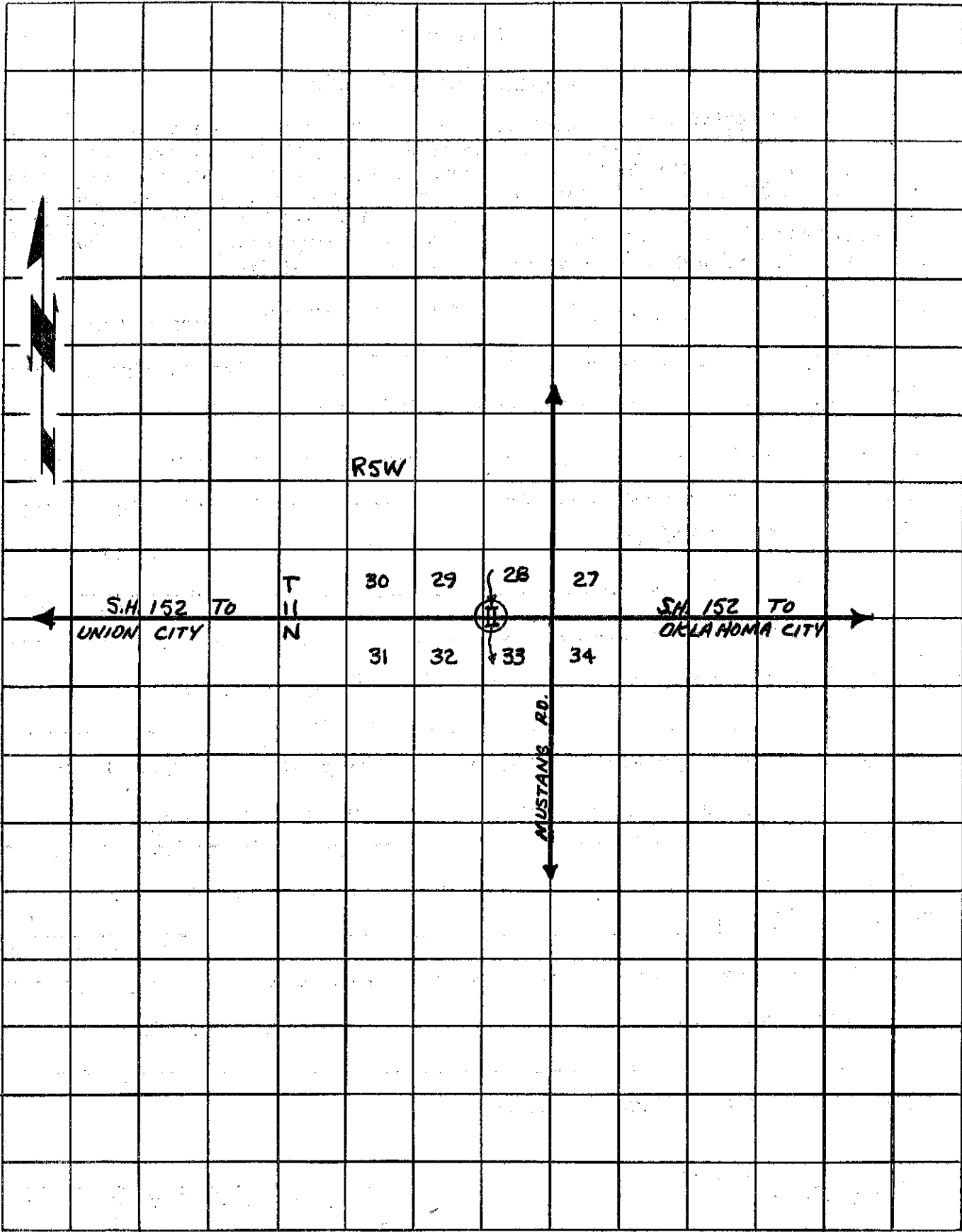

RSW

S.H. 152 TO  
UNION CITY

T  
N

30

29

28

27



31

32

33

34

S.H. 152 TO  
OKLAHOMA CITY

MUSTANG RD.