

**OKLAHOMA DEPARTMENT OF TRANSPORTATION  
SURVEY DIVISION**

**FLOOD INFORMATION FORM**

<b>Division #:</b>	1 <input type="checkbox"/> 2 <input type="checkbox"/> 3 <input type="checkbox"/> 4 <input checked="" type="checkbox"/> 5 <input type="checkbox"/> 6 <input type="checkbox"/> 7 <input type="checkbox"/> 8 <input type="checkbox"/>
<b>County:</b>	Canadian
<b>Date Highwater occurred:</b>	8/21/07
<b>Highway Number:</b>	S.H. 4
<b>Name of Stream:</b>	North Canadian River
<b>Direction and distance from nearest town, or highway junction</b>	From the Junction of S.H. 4 & S.H. 66 in Yukon, Ok., Approx. 2.2 miles north
<b>Section, Township, Range:</b>	Between Sections 4 & 5, T-12-N, R-5-W
<b>Description of Location:</b>	1.0 Feet below bridge seat (NW cor.)
<b>Highwater Elevation:</b>	1269.3
<b>Level Datum &amp; Source:</b>	SAP 1086(1) Plans
<b>Method used:</b>	WILD NA 2 ENGR. LEVEL
<b>Date Elevation Obtained:</b>	8/21/07
<b>Apparent Magnitude:</b>	Normal <input type="checkbox"/> Medium <input type="checkbox"/> Extreme <input checked="" type="checkbox"/> Don't Know <input type="checkbox"/>
<b>Was Highwater Mark obtained from actual water, drift, local resident, or other source?</b>	Witnessed actual water crossing road approx. 1000' south of bridge on 8-21-07. Water approx. 1.0 ft above road, also road was closed due to Damage near small bridge south of river. Russell Huber Trans. Spec. II, El Reno Survey
<b>Explanatory Remarks:</b>	NW corner of bridge seat ELEV. = 1270.3

Note: Show Vicinity Map on back of form

Name (signature)

Name (Printed)

GARY S. RHOADS

Date:

8/30/2007

Survey Division  
Form No. 16  
Revised: 5/09/2007

location # 85

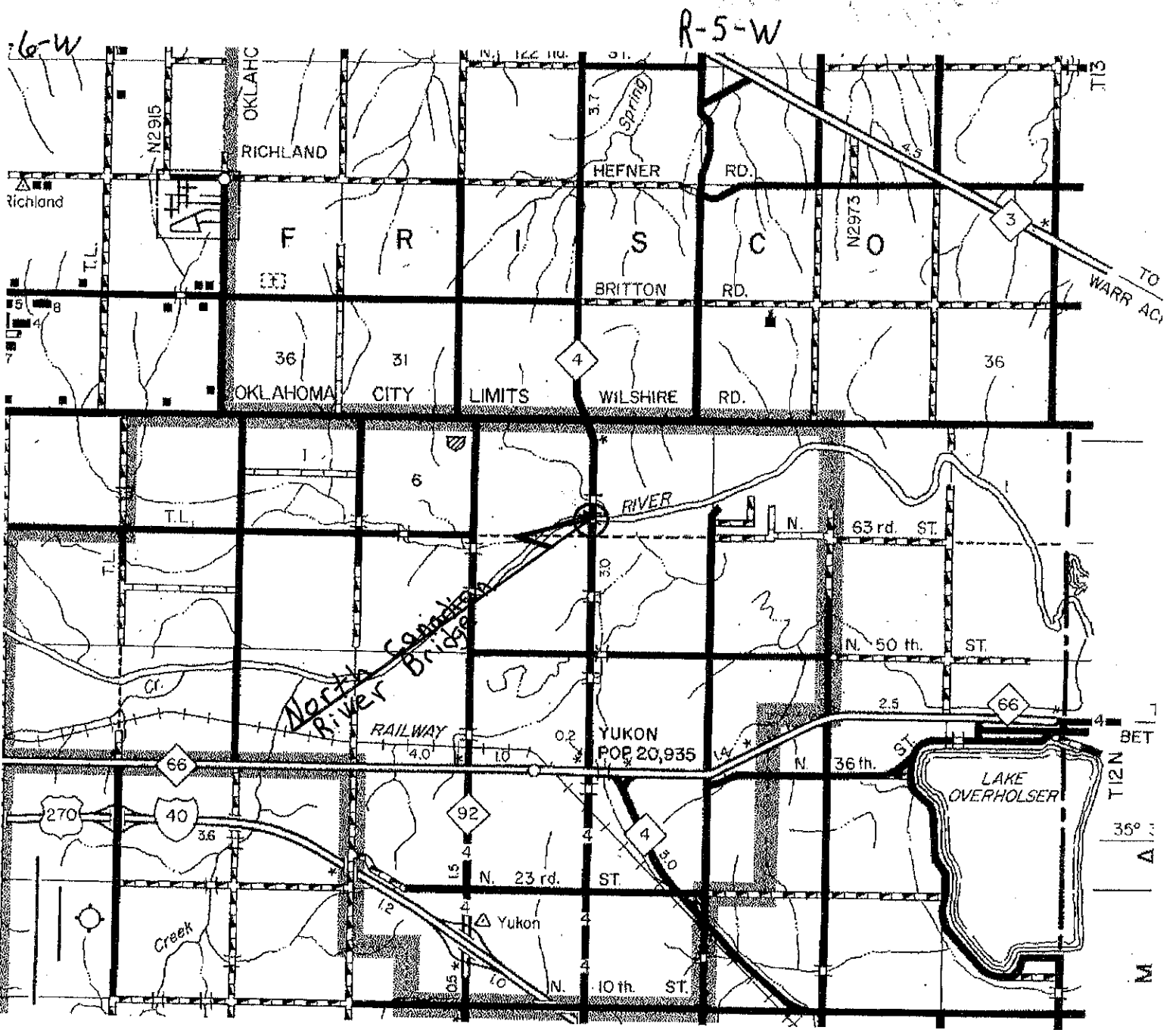

6-W

R-5-W

Richland

RICHLAND

HEFNER RD.

BRITTON RD.

WILSHIRE RD.

RIVER

North Canyon River Bridge

RAILWAY

YUKON  
POP 20,935

LAKE OVERHOLSER

BET

T12N

35°

M

N2915

OKLAHC

N. 122 TH. ST.

N2973

T13

TO WARR AC

F

R

I

S

C

O

36

31

4

36

6

N. 63 rd. ST.

N. 50 th. ST.

2.5

66

270

40

92

4

66

Creek

N. 23 rd. ST.

N. 10 th. ST.

N. 36 th. ST.

15

4

4

4

4

4

4

4

4

12

4

4

4

4

4

4

4

4

10

4

4

4

4

4

4

4

4

10

4

4

4

4

4

4

4

4

10

4

4

4

4

4

4

4

4

10

4

4

4

4

4

4

4

4

10

4

4

4

4

4

4

4

4

10

4

4

4

4

4

4

4

4

10

4

4

4

4

4

4

4

4

10

4

4

4

4

4

4

4

4

10

4

4

4

4

4

4

4

4

10

4

4

4

4

4

4

4

4

10

4

4

4

4

4

4

4

4

10

4

4

4

4

4

4

4

4

10

4

4

4

4

4

4

4

4

10

4

4

4

4

4

4

4

4

10

4

4

4

4

4

4

4

4

10

4

4

4

4

4

4

4

4

10

4

4

4

4

4

4

4

4

10

4

4

4

4

4

4

4

4