

**OKLAHOMA DEPARTMENT OF TRANSPORTATION
SURVEY DIVISION**

FLOOD INFORMATION FORM

Division #:	1 <input type="checkbox"/> 2 <input type="checkbox"/> 3 <input type="checkbox"/> 4 <input checked="" type="checkbox"/> 5 <input type="checkbox"/> 6 <input type="checkbox"/> 7 <input type="checkbox"/> 8 <input type="checkbox"/>
County:	Canadian
Date Highwater occurred:	8/19/07
Highway Number:	I-40
Name of Stream:	None (2-8'x 8' RCB)
Direction and distance from nearest town, or highway junction	Approx. 0.5 mile East of the I-40 & I-40 Business Interchange.
Section, Township, Range:	Sections 10, T-12-N, R-8-W
Description of Location:	1.6 feet Above both lanes of I-40 at RCB.
Highwater Elevation:	1387.6
Level Datum & Source:	GPS from SWO 4029(1)
Method used:	WILD NA 2 ENGR. LEVEL
Date Elevation Obtained:	8/21/07
Apparent Magnitude:	Normal <input type="checkbox"/> Medium <input type="checkbox"/> Extreme <input checked="" type="checkbox"/> Don't Know <input type="checkbox"/>
Was Highwater Mark obtained from actual water, drift, local resident, or other source?	Drift
Explanatory Remarks:	SE cor. Of South hdwl. ELEV. = 1382.25

Note: Show Vicinity Map on back of form

Name (signature)

Barry S. Rhoads

Name (Printed)

Barry S. Rhoads

Date:

8/30/2007

Survey Division

Form No. 16

Revised: 5/09/2007

Location # 95

R-8-W

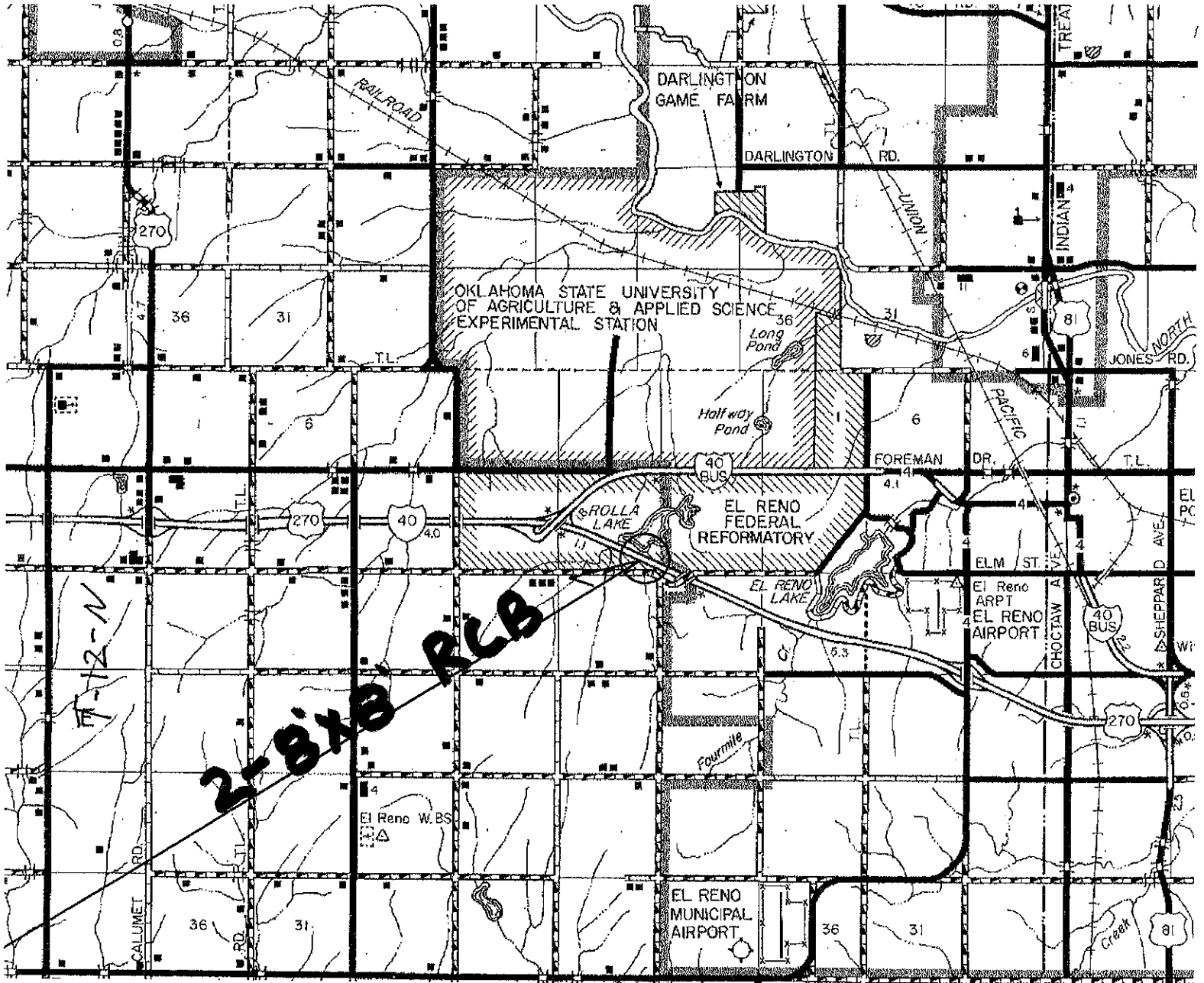

2-818 RCB

T-12-N