

STATE OF OKLAHOMA
DEPARTMENT OF HIGHWAYS
SURVEY DIVISION

FLOOD INFORMATION FORM

To be used in obtaining and transmitting flood water elevations for Survey Division office record files. This information to be obtained by all Chiefs of Party or others in their vicinity in times of unusual high water, or at any time available from a reliable source. The elevations can be recorded by level reading, by measurement from bridge floor, in relation to a house, above roadbed or any other dependable, clear manner that fits the situation, the highest order possible to be used. Separate report to be made on each crossing or place obtained.

County Caddo Date highwater occurred 9/17/65

Highway number S.H. 9 Name of stream Washita River

Direction and distance from nearest town, village or store 1/2 mile South of Fort Cobb

Section, Township and Range T7N, R12W, Section 14

Description of Location Bridge over Washita River on S.H. 9, 1/2 mile south of Fort Cobb

Elevation "See remarks" Source of levels _____

Method obtained ^{wye} with level & Philadelphia rod Date obtained 9/29/65

Did it appear to be normal medium extreme do not know

Was highwater mark obtained from actual water, drift, local resident, U. S. Engineers, etc.? Taken from silt marks on bridge.

Explanatory Remarks Highwater was 6.6 Ft. below \bar{L} of bridge floor at the north end. This information was obtained by A. W. Ziegelgruber and B. D. Roden. Highwater was caused from a reported rain of 10 to 12 inches, upstream over a period of approx. 12 hours.

Location to be shown on back of this sheet as a check.

Field Note: To be sent to
Survey Engineer

A. W. Ziegelgruber
~~XXXXXXXXXXXXXXXXXXXX~~ Chief of Party
~~XXXXXXXXXXXXXXXXXXXX~~
December 20, 1965
Date

Mc
LOC. NO. 4

Range R12W

Range R11W



T
7
N

T
7
N

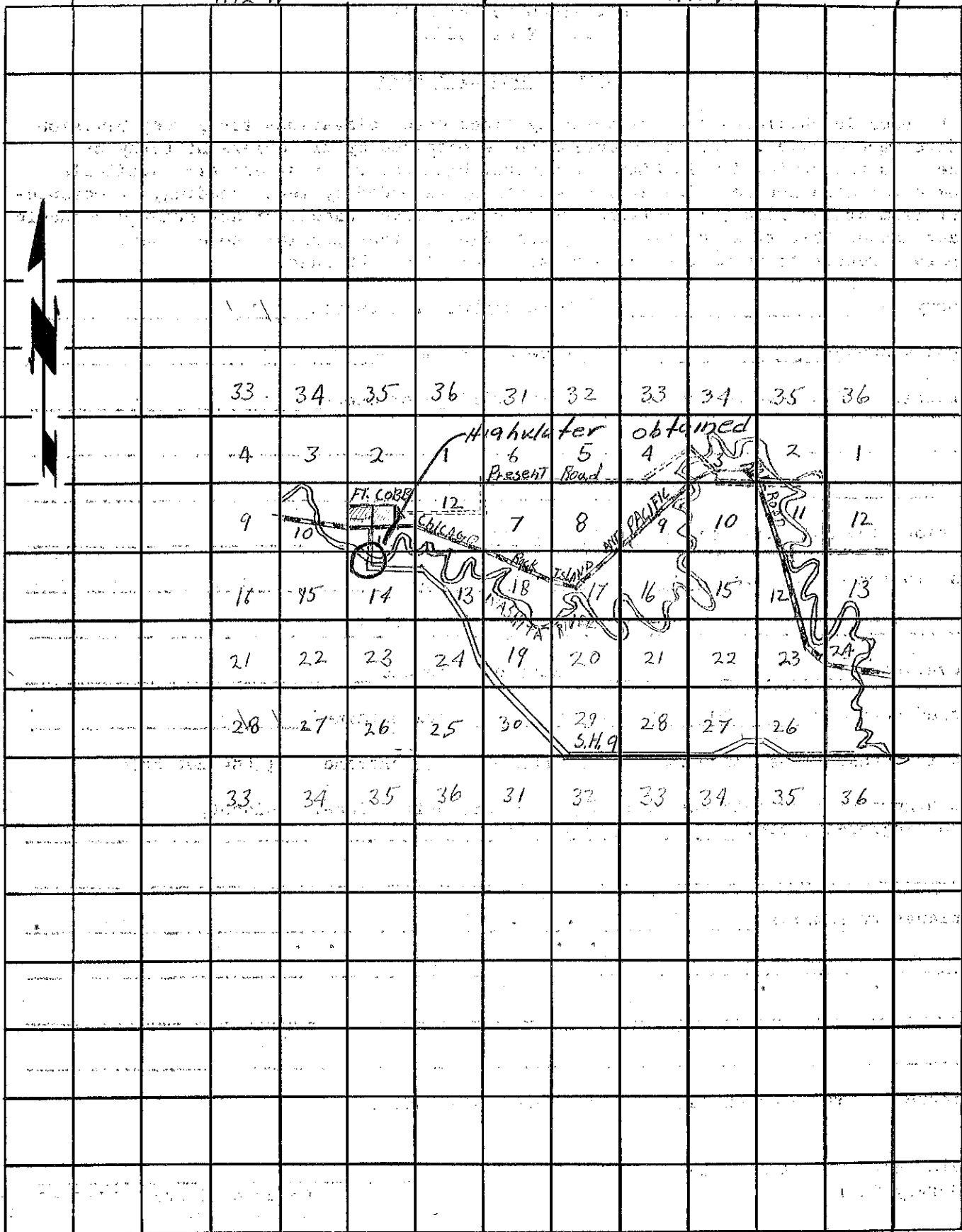

Range R12W

Range R11W