

STATE OF OKLAHOMA
DEPARTMENT OF HIGHWAYS
SURVEY DIVISION

FLOOD INFORMATION FORM

To be used in obtaining and transmitting flood water elevations for Survey Division office record files. This information to be obtained by all Chiefs of Party or others in their vicinity in times of unusual high water, or at any time available from a reliable source. The elevations can be recorded by level reading, by measurement from bridge floor, in relation to a house, above roadbed or any other dependable, clear manner that fits the situation, the highest order possible to be used. Separate report to be made on each crossing or place obtained.

County Caddo Date highwater occurred 9/17/65

Highway number S.H. 9 Name of stream Washita River

Direction and distance from nearest town, village or store 2 1/2 miles East & 1 mile

North of Jct. of S.H. 9 & S.H. 54. N.E. of Carnegie.

Section, Township and Range R13W, T8N, Section 3 & 34

Description of Location Bridge over washita River on S.H. 9. 2 1/2 miles East & 1 mile

North of Jct. of S.H. 9 & S.H. 54. N.E. of Carnegie.

Elevation "See remarks" Source of levels _____

Method obtained With wye level & Philadelphia Rod Date obtained 9/29/65

Did it appear to be normal medium extreme do not know

Was highwater mark obtained from actual water, drift, local resident, U. S. Engineers, etc.? Silt marks on bridge

Explanatory Remarks Highwater was 3.2 Ft. below $\frac{1}{2}$ of bridge floor at the east end. Highwater was caused from a reported rain of 10 to 12 inches upstream over a period of approx. 12 hours. This information was obtained by A. W. Ziegelgruber and B. D. Roden.

Location to be shown on back of this sheet as a check.

Field Note: To be sent to
Survey Engineer

A. W. Ziegelgruber
~~Chief of Party~~
~~Location Engineer~~
December 20, 1965
Date

Mc

LOC. NO. 8

R 14 W

R 13 W

R 12 W

T 9 N

T 9 N

T 8 N

T 8 N

T 7 N

T 7 N

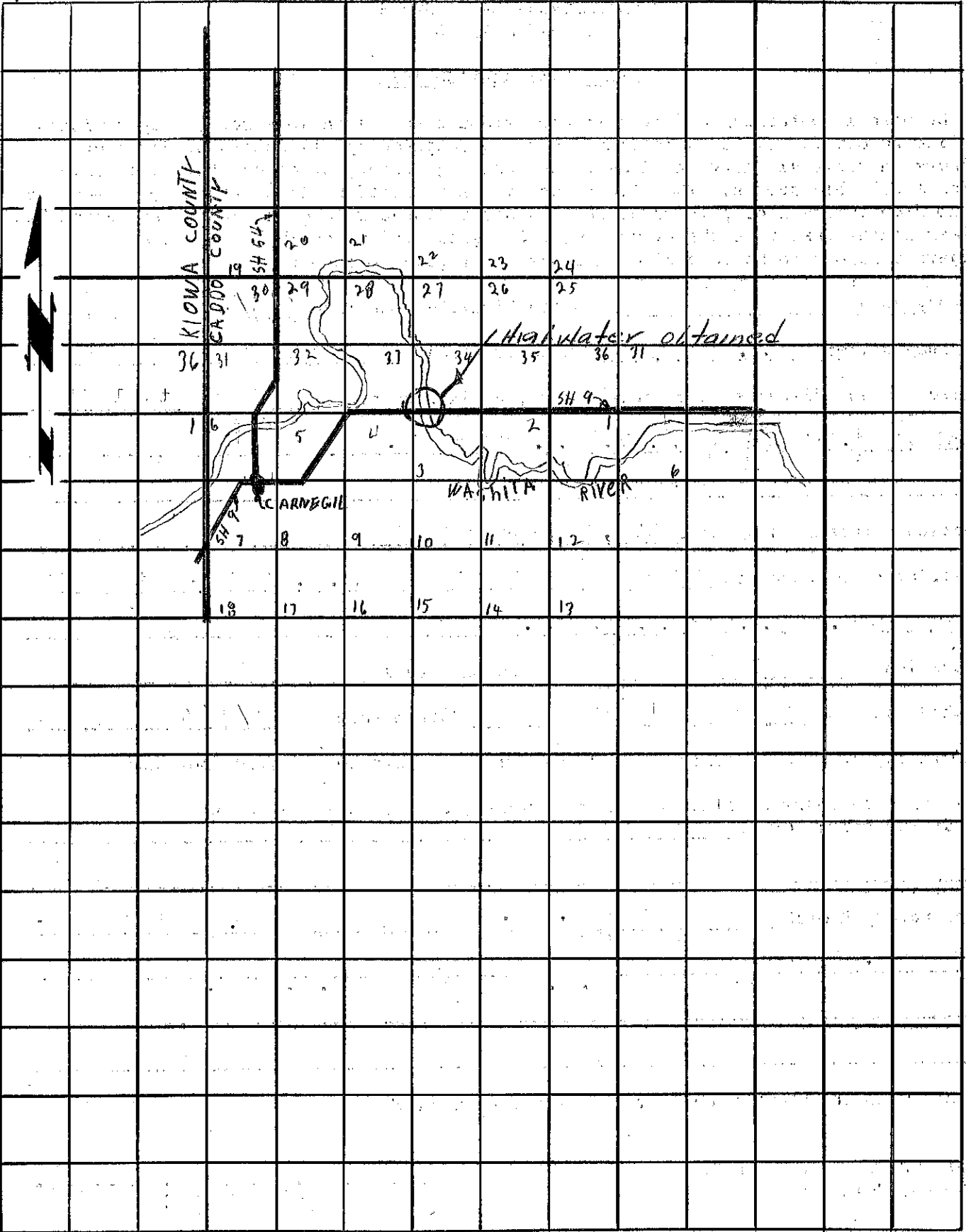

R 14 W

R 13 W

R 12 W