

STATE OF OKLAHOMA
DEPARTMENT OF HIGHWAYS
SURVEY DIVISION

FLOOD INFORMATION FORM

To be used in obtaining and transmitting flood water elevations for Survey Division office record files. This information to be obtained by all Chiefs of Party or others in their vicinity in times of unusual high water, or at any time available from a reliable source. The elevations can be recorded by level reading, by measurement from bridge floor, in relation to a house, above roadbed or any other dependable, clear manner that fits the situation, the highest order possible to be used. Separate report to be made on each crossing or place obtained.

County CADDO Date highwater occurred OCTOBER 20, 1983.

Highway number SH 9 Name of stream WASHITA RIVER

Direction and distance from nearest town, village or store _____
0.5 MILE EAST OF FORT COBB.

Section, Township and Range SEC. 11, T7N, R12W.

Description of Location VISIBLE WATER AT EAST END OF RIVER BRIDGE

Elevation 1249.0 Source of levels USC&GS - SWO 3503(1).

Method obtained ENGINEERS LEVEL Date obtained OCTOBER 24, 1983.

Did it appear to be normal medium extreme do not know

Was highwater mark obtained from actual water, drift, local resident, U. S. Engineers, etc.? ACTUAL WATER MARK.

Explanatory Remarks EXTREME HIGHWATER OCCURED IN THE YEAR OF 1951
REACHED ELEV. = 1251.0.

Location to be shown on back of this sheet as a check.

Field Notes: To be sent to
Survey Engineer

Bobby Earl Garland
Chief of Party
BOBBY EARL GARLAND
NOV. 10, 1983.
Date

*Copy to Bridge 12-13-83
A2*

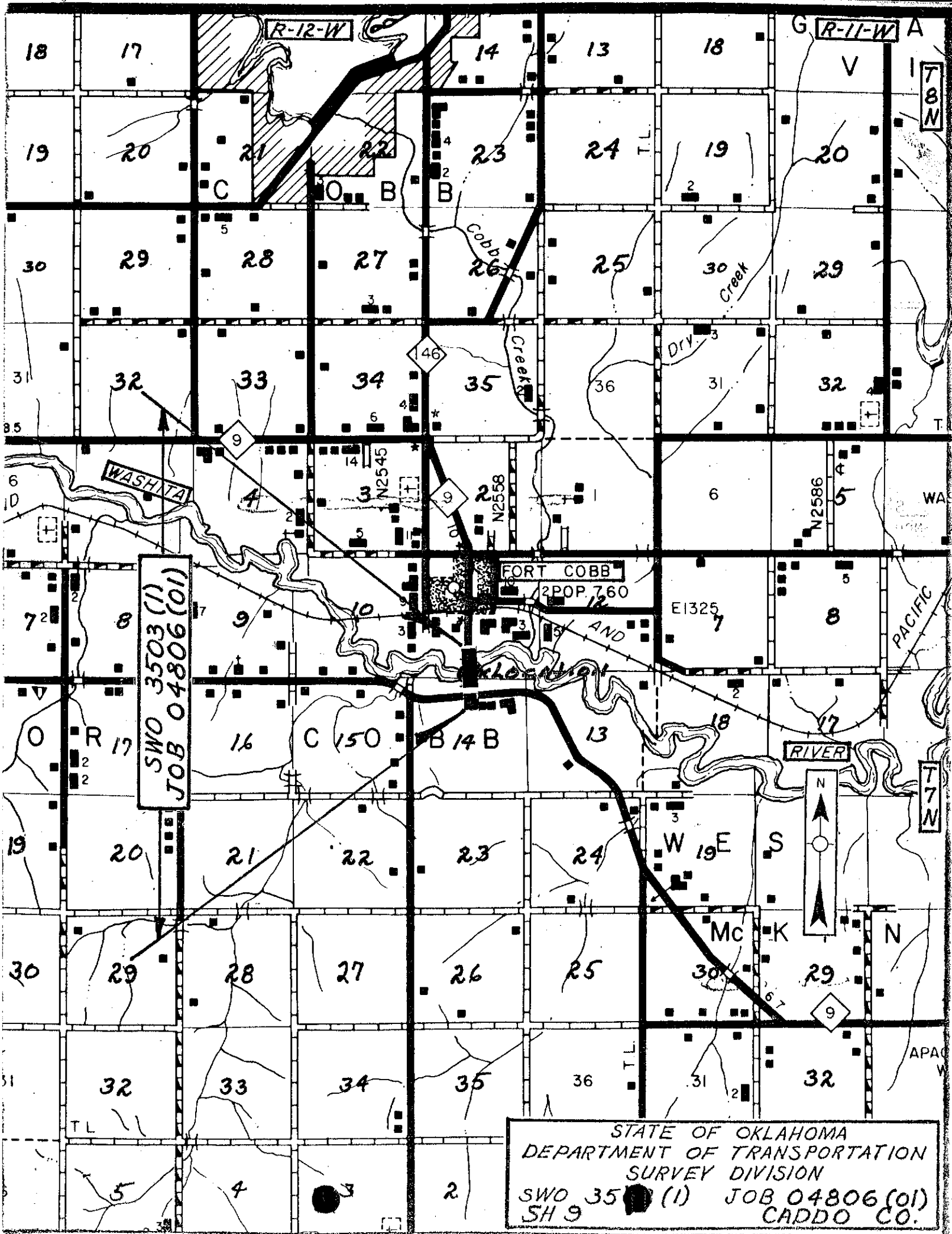

SWO 3503 (1)
JOB 04806 (01)

STATE OF OKLAHOMA
DEPARTMENT OF TRANSPORTATION
SURVEY DIVISION
SWO 3503 (1) JOB 04806 (01)
SH 9 CADDO CO.