



**OKLAHOMA DEPARTMENT OF TRANSPORTATION
SURVEY DIVISION**

FLOOD INFORMATION FORM

Division #:	1 <input type="checkbox"/> 2 <input type="checkbox"/> 3 <input type="checkbox"/> 4 <input type="checkbox"/> 5 <input type="checkbox"/> 6 <input type="checkbox"/> 7 <input checked="" type="checkbox"/> 8 <input type="checkbox"/>
County:	CADDO
Date Highwater occurred:	04/02/07
Highway Number:	S.H.146
Name of Stream:	N/A
Direction and distance from nearest town, or highway junction	LOCATION IS 6.0 MILES SOUTH OF JCT. S.H. 146 AND S.H. 152. AND AT THE INTERSECTION OF NS 257 AND EW 125 SECTION LINES.
Section, Township, Range:	SEC. 31, T-9-N, R-11-W, 1M.
Description of Location:	WATER ON THE NORTH LANE OF S.H. 146.
Highwater Elevation:	1460.28
Level Datum & Source:	S-174(1) 1946
Method used:	DIFFERENTIAL LEVELING
Date Elevation Obtained:	04/05/07
Apparent Magnitude:	Normal <input type="checkbox"/> Medium <input type="checkbox"/> Extreme <input checked="" type="checkbox"/> Don't Know <input type="checkbox"/>
Was Highwater Mark obtained from actual water, drift, local resident, or other source?	HIGHWATER MARK WAS OBTAINED BY REMNANTS OF DRIFT.
Explanatory Remarks:	

Note: Show Vicinity Map on back of form

Name (signature) _____

Name (Printed)

Date: 05/30/07

Danny R. Dees

DANNY R. DEES, PLS

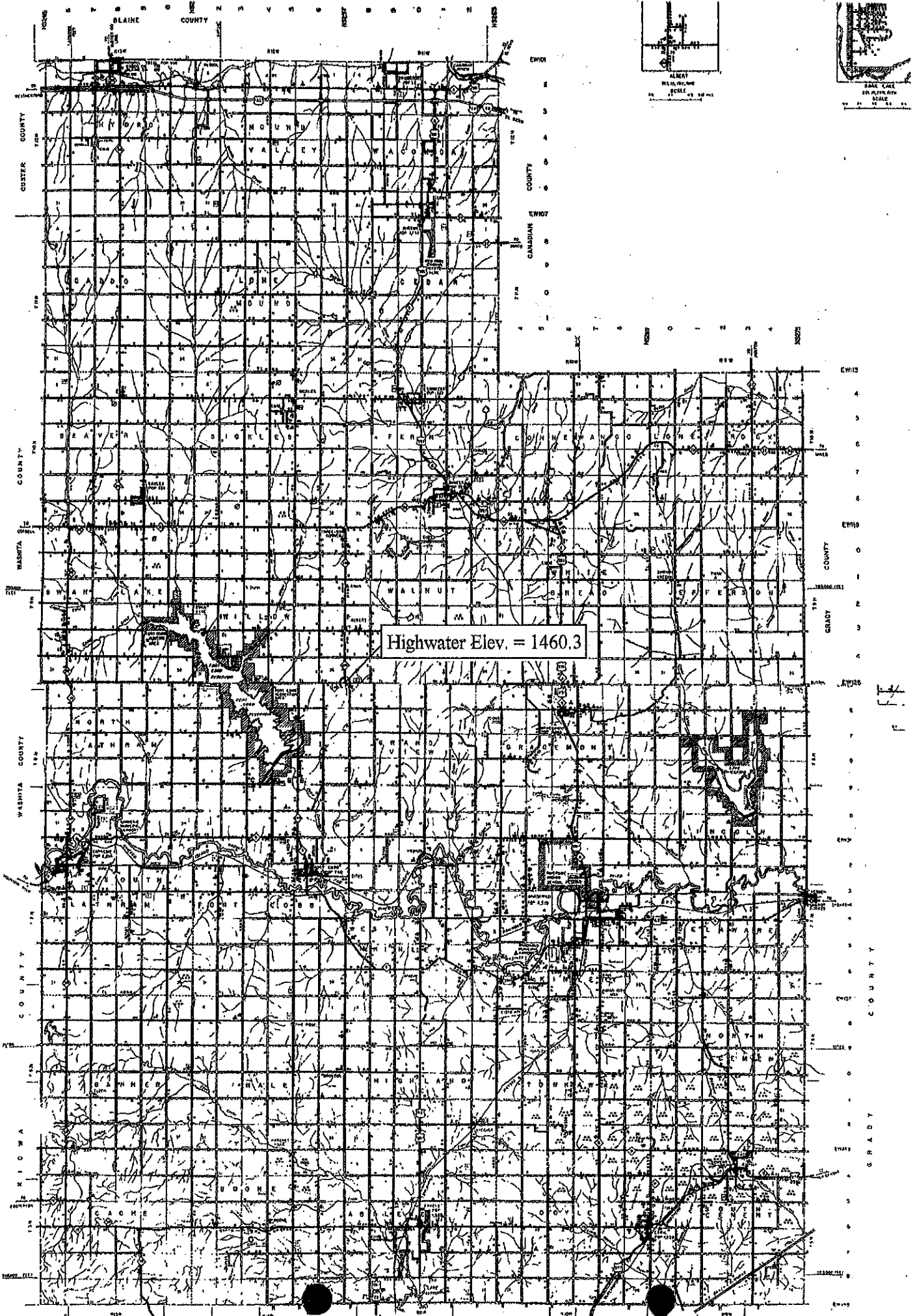

Highwater Elev. = 1460.3

