

OKLAHOMA DEPARTMENT OF TRANSPORTATION
SURVEY DIVISION

FLOOD INFORMATION FORM

Division #:	1 <input type="checkbox"/> 2 <input type="checkbox"/> 3 <input type="checkbox"/> 4 <input type="checkbox"/> 5 <input type="checkbox"/> 6 <input type="checkbox"/> 7 <input checked="" type="checkbox"/> 8 <input type="checkbox"/>
County:	CADDO
Date Highwater occurred:	04/02/07
Highway Number:	S.H.146
Name of Stream:	N/A
Direction and distance from nearest town, or highway junction	LOCATION IS 3.0 MILES SOUTH OF JCT. S.H. 146 & S.H. 152, INTERSECTION OF S.H.146 & CR 1220.
Section, Township, Range:	SEC. 18, T-9-N, R-11-W, I.M.
Description of Location:	WATER STANDS 3"- 4" ABOVE HIGHWAY
Highwater Elevation:	1537.3 (Asphalt 1537.0)
Level Datum & Source:	U.S.G.S. FORT COBB QUAD SHEET
Method used:	N/A
Date Elevation Obtained:	04/05/07
Apparent Magnitude:	Normal <input type="checkbox"/> Medium <input type="checkbox"/> Extreme <input checked="" type="checkbox"/> Don't Know <input type="checkbox"/>
Was Highwater Mark obtained from actual water, drift, local resident, or other source?	HIGHWATER MARK WAS OBTAINED BY REMNANTS OF DRIFT.
Explanatory Remarks:	

Note: Show Vicinity Map on back of form

Name (signature) _____

Name (Printed)

Date: 05/30/07

Danny R. Dees

DANNY R. DEES, PLS

Survey Division

Form No. 16

Revised: 5/09/2007

Loc. No 17

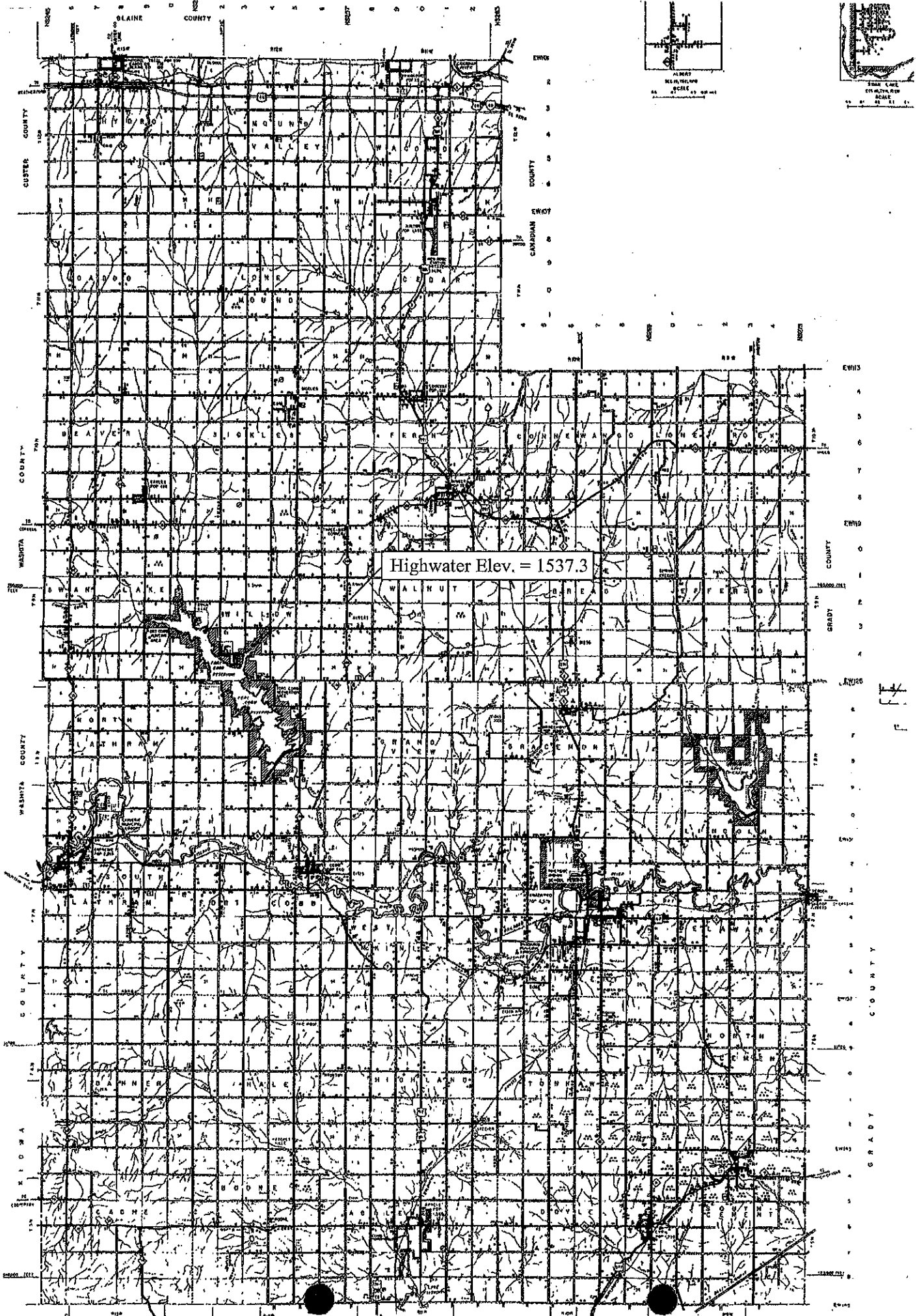

Highwater Elev. = 1537.3

U
L
L