

OKLAHOMA DEPARTMENT OF TRANSPORTATION  
SURVEY DIVISION

FLOOD INFORMATION FORM

Division #:	1 <input type="checkbox"/> 2 <input type="checkbox"/> 3 <input type="checkbox"/> 4 <input type="checkbox"/> 5 <input type="checkbox"/> 6 <input type="checkbox"/> 7 <input checked="" type="checkbox"/> 8 <input type="checkbox"/>
County:	CADDO
Date Highwater occurred:	04/02/07
Highway Number:	S.H. 58
Name of Stream:	
Direction and distance from nearest town, or highway junction	Location is 1 <sup>st</sup> cross-drain north, approx. 125 ft., of Jct. S.H. 152 & S.H. 58.
Section, Township, Range:	Between Sections 33 & 34, T-10-N, R-13-W, I.M.
Description of Location:	
Highwater Elevation:	1451.66
Level Datum & Source:	SAP-775(2) 1951 & SAP-552(12) 1948 PLANS
Method used:	Differential Leveling
Date Elevation Obtained:	04/05/07
Apparent Magnitude:	Normal <input type="checkbox"/> Medium <input type="checkbox"/> Extreme <input checked="" type="checkbox"/> Don't Know <input type="checkbox"/>
Was Highwater Mark obtained from actual water, drift, local resident, or other source?	High-water information was given by Butch Hannagan, Maintenance Superintendent, Caddo County.
Explanatory Remarks:	

Note: Show Vicinity Map on back of form

Name (signature)

Name (Printed)

Danny R. Dees PLS

Date:05/30/07

Survey Division  
Form No. 16  
Revised: 5/09/2007

Loc. No 19

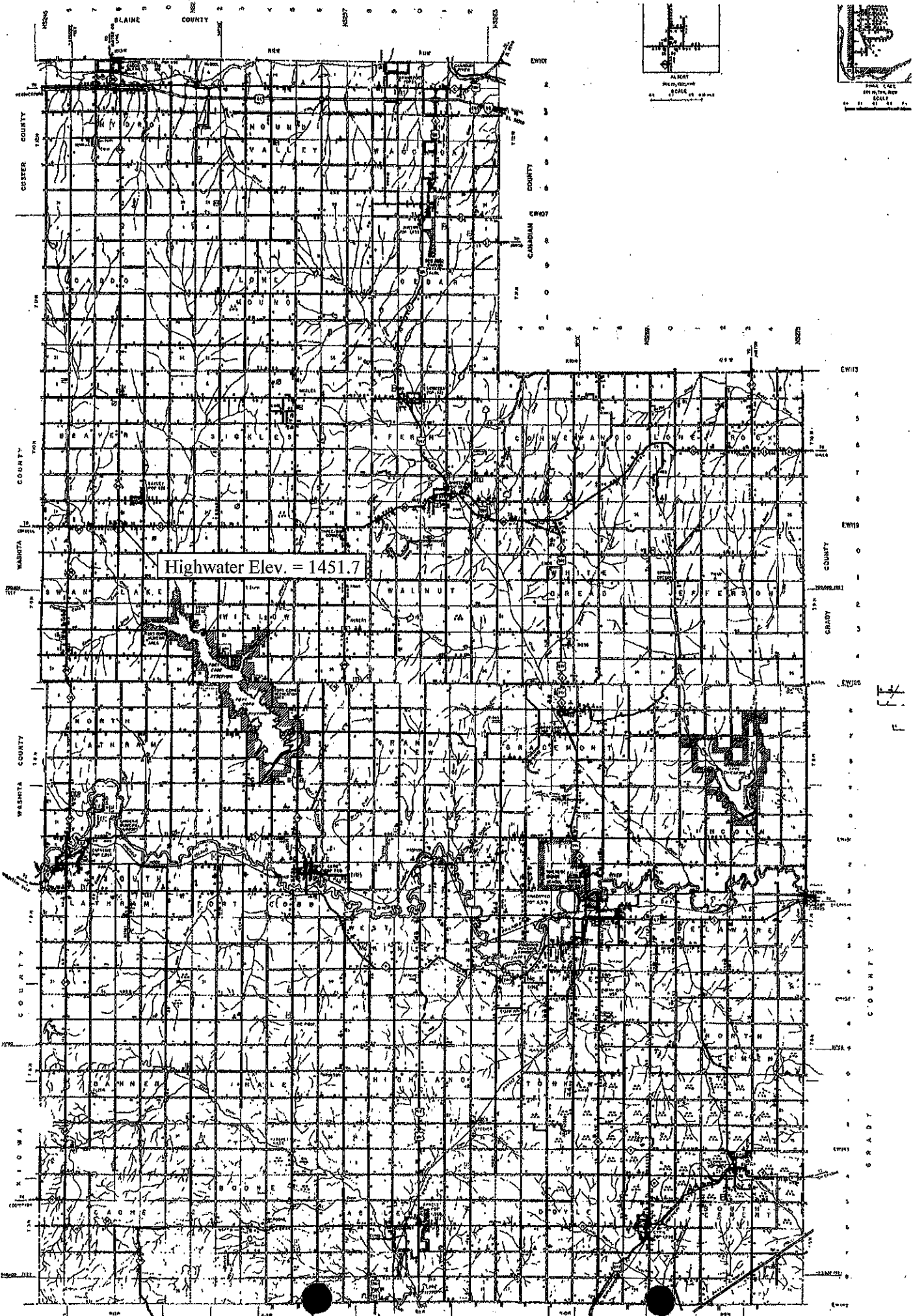

Highwater Elev. = 1451.7

11  
F