

OKLAHOMA DEPARTMENT OF TRANSPORTATION
SURVEY DIVISION

FLOOD INFORMATION FORM

Division #:	1 <input type="checkbox"/> 2 <input type="checkbox"/> 3 <input type="checkbox"/> 4 <input type="checkbox"/> 5 <input type="checkbox"/> 6 <input type="checkbox"/> 7 <input checked="" type="checkbox"/> 8 <input type="checkbox"/>
County:	CADDO
Date Highwater occurred:	04/02/07
Highway Number:	S.H. 58
Name of Stream:	
Direction and distance from nearest town, or highway junction	Location is 8 miles south of Jct. I-40 & S.H. 58 at the intersection of S.H. 58 & CR1100.
Section, Township, Range:	SW corner Section 15, T-11-N, R-13-W, I.M.
Description of Location:	Side Drain at intersection.
Highwater Elevation:	1678.29
Level Datum & Source:	SAP-775(2) 1951 PLANS
Method used:	Differential Leveling
Date Elevation Obtained:	04/05/07
Apparent Magnitude:	Normal <input type="checkbox"/> Medium <input type="checkbox"/> Extreme <input checked="" type="checkbox"/> Don't Know <input type="checkbox"/>
Was Highwater Mark obtained from actual water, drift, local resident, or other source?	Highwater was information given by Butch Hannagan, Maintenance Superintendent, Caddo County, who said the water was approx. 2" above asphalt.
Explanatory Remarks:	

Note: Show Vicinity Map on back of form

Name (signature)

Name (Printed)

Danny R. Dees, PLS

Date:05/30/07

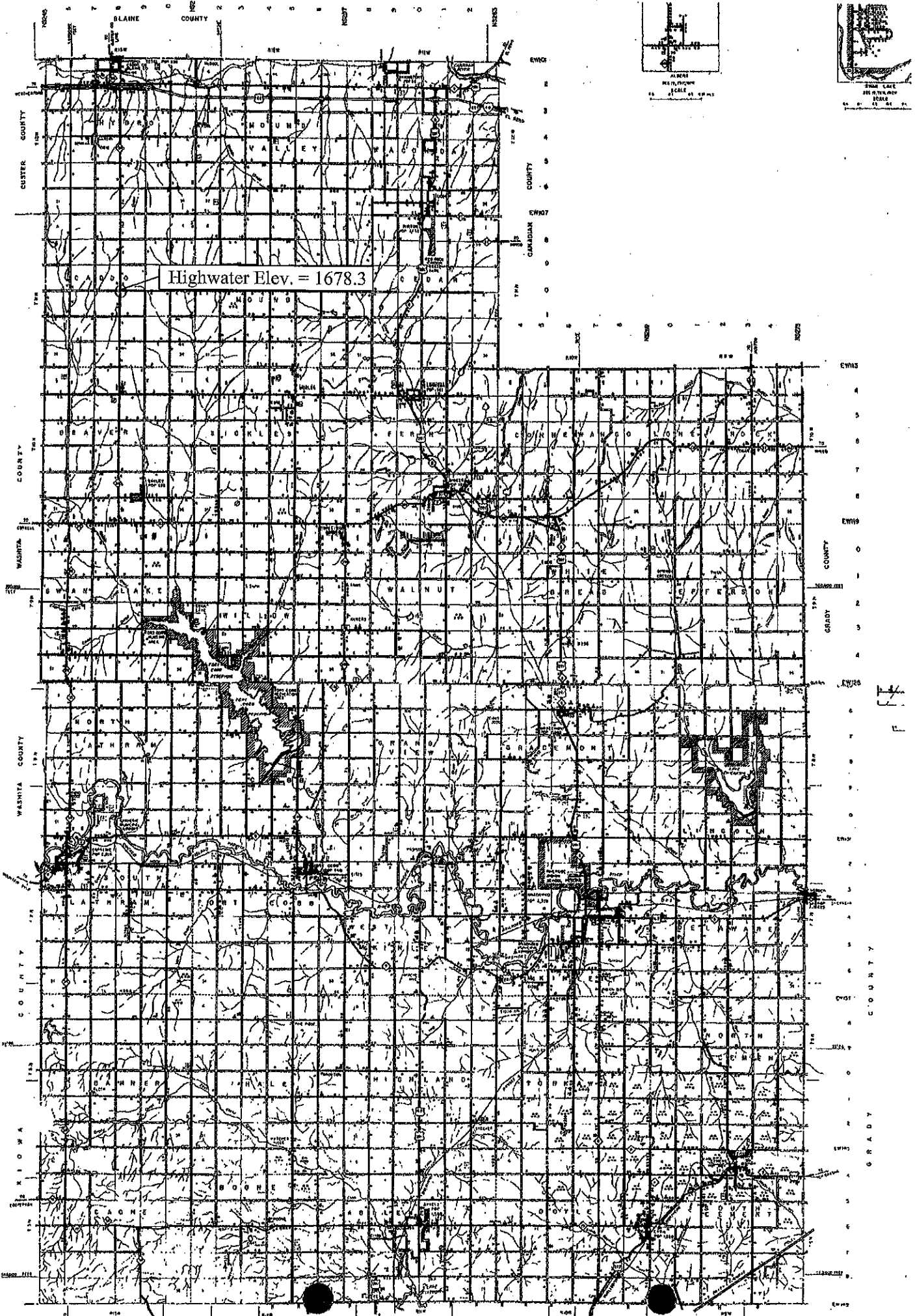

Highwater Elev. = 1678.3

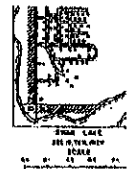
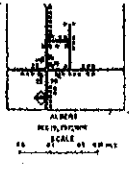

17