

OKLAHOMA DEPARTMENT OF TRANSPORTATION
SURVEY DIVISION

FLOOD INFORMATION FORM

| | |
|--|--|
| Division #: | 1 <input type="checkbox"/> 2 <input type="checkbox"/> 3 <input type="checkbox"/> 4 <input type="checkbox"/> 5 <input type="checkbox"/> 6 <input type="checkbox"/> 7 <input checked="" type="checkbox"/> 8 <input type="checkbox"/> |
| County: | CADDO |
| Date Highwater occurred: | 04/02/07 |
| Highway Number: | S.H. 152 |
| Name of Stream: | |
| Direction and distance from nearest town, or highway junction | Location is a cross-drain 1 mile west of Jct. S.H. 146 & S.H. 152 on the east side of the intersection of S.H. 152 & CS 2560. |
| Section, Township, Range: | SW corner Section 36, T-10-N, R-12-W, I.M. |
| Description of Location: | Cross-Drain east side of intersection. |
| Highwater Elevation: | 1495.62 |
| Level Datum & Source: | SAP-552(12) 1948 PLANS |
| Method used: | Differential Leveling |
| Date Elevation Obtained: | 04/05/07 |
| Apparent Magnitude: | Normal <input type="checkbox"/> Medium <input type="checkbox"/> Extreme <input checked="" type="checkbox"/> Don't Know <input type="checkbox"/> |
| Was Highwater Mark obtained from actual water, drift, local resident, or other source? | Highwater was taken from a drift and information given by Butch Hannagan, Maintenance Superintendent, Caddo County. |
| Explanatory Remarks: | |

Note: Show Vicinity Map on back of form

Name (signature)

Name (Printed)

Danny R. Dees, PLS

Date: 05/30/07

Survey Division

Form No. 16

Revised: 5/09/2007

Loc No - 24

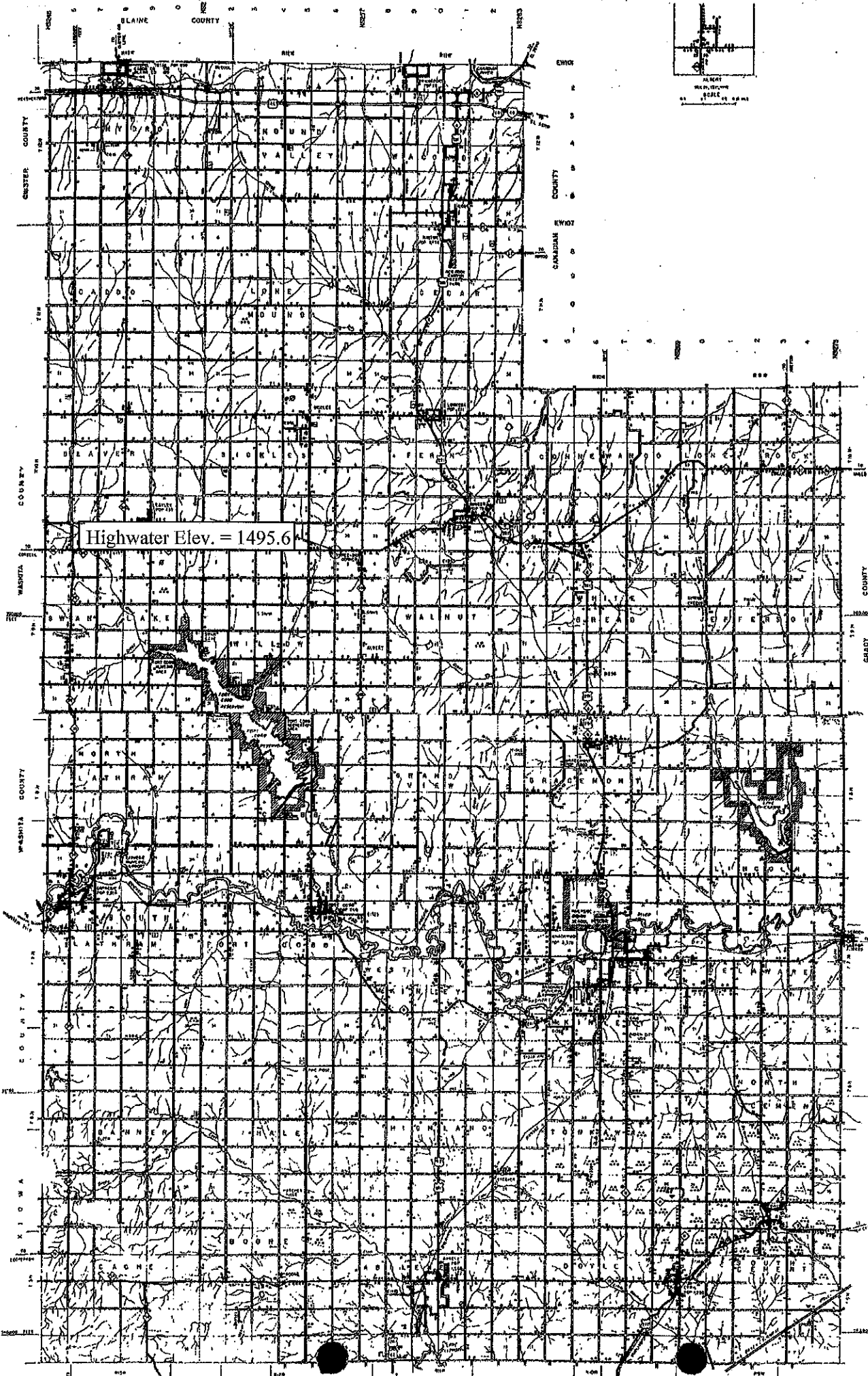

Highwater Elev. = 1495.6

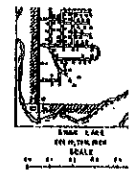
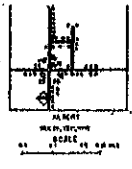

Handwritten initials or a signature, possibly 'L. F.' or similar, located on the right side of the map.