

**OKLAHOMA DEPARTMENT OF TRANSPORTATION
SURVEY DIVISION**

FLOOD INFORMATION FORM

Division #: 7	1 <input type="checkbox"/> 2 <input type="checkbox"/> 3 <input type="checkbox"/> 4 <input type="checkbox"/> 5 <input type="checkbox"/> 6 <input type="checkbox"/> 7 <input checked="" type="checkbox"/> 8 <input type="checkbox"/>
County:	CADDO
Date Highwater occurred:	08/18/07
Highway Number:	S.H. 58
Name of Stream:	N/A
Direction and distance from nearest town, or highway junction	LOCATION IS 8.3 MILES SOUTH OF JCT. S.H. 9 & S.H. 58 IN CARNAGIE.
Section, Township, Range:	BETWEN SECTIONS 19 & 20, T-6-N, R-13-W, I.M.
Description of Location:	2-10'X6'X32' RDY. RCB.
Highwater Elevation:	1459.1 (Asphalt, 1458.2)
Level Datum & Source:	FAS NO. S-680(3)
Method used:	Differential Leveling
Date Elevation Obtained:	08/20/07
Apparent Magnitude:	Normal <input type="checkbox"/> Medium <input type="checkbox"/> Extreme <input checked="" type="checkbox"/> Don't Know <input type="checkbox"/>
Was Highwater Mark obtained from actual water, drift, local resident, or other source?	HIGHWATER MARK WAS OBTAINED BY REMNANTS OF DRIFT.
Explanatory Remarks:	

Note: Show Vicinity Map on back of form

Name (signature) 
 Name (Printed) DANNY R. DEES, PLS
 Date: 11/07/07

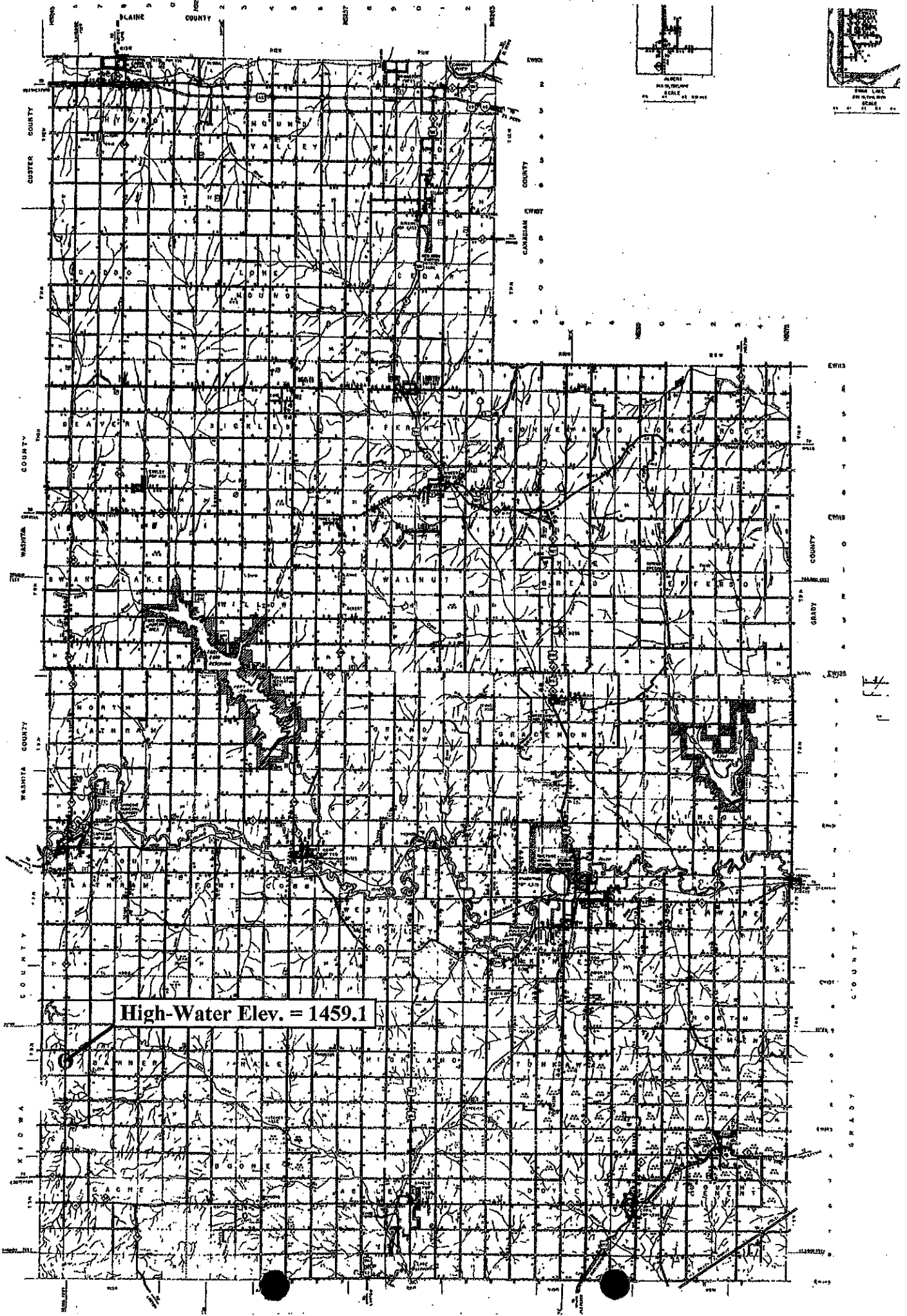

High-Water Elev. = 1459.1

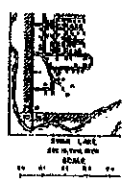
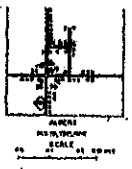

17